

**GENERAL NOTES:**

A. THIS DRAWING IS TO BE READ IN CONJUNCTION WITH ALL RELEVANT ARCHITECTURAL DRAWINGS, THE SPECIFICATION, AND ALL RELEVANT STANDARD DETAIL DRAWINGS.

B. THIS DRAWING IS TO BE READ IN CONJUNCTION WITH ALL RELEVANT CIVIL, STRUCTURAL, MECHANICAL AND ELECTRICAL DRAWINGS TOGETHER WITH THE SPECIFICATIONS AND SCHEDULES.

C. ALL DIMENSIONS IN MILLIMETRES. DO NOT SCALE FROM THIS DRAWING. USE FIGURED DIMENSIONS ONLY.

D. CONTRACTOR MUST VERIFY ALL DIMENSIONS ON SITE BEFORE SETTING OUT, COMMENCING WORK, OR PRODUCING ANY SHOP DRAWINGS.

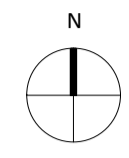

**BOUNDARY TYPES LEGEND**

- TYPE A**  
BOUNDARY POST + PANEL FENCE TYPE A (2000mm min. above immediate ground level):  
Precast concrete posts set in concrete pit base, infilled with timber board panels over 300mm concrete ground board.
- TYPE B**  
BOUNDARY WALL TYPE B (900mm min. above immediate ground level):  
215mm brick boundary garden wall with soldier course brick capping. At terrace locations 1800mm high for utility boxes for 900mm length, and continue with 900mm high wall.
- TYPE C**  
BOUNDARY WALL TYPE C (2000mm min. above immediate ground level):  
215mm brick boundary wall with soldier course brick capping.
- TYPE D**  
BOUNDARY WALL TYPE D (2000mm min. above immediate ground level):  
215mm rendered blockwork boundary wall with concrete capping. Piers on perimeter walls.
- TYPE E**  
BOUNDARY WALL TYPE E (900mm min. above immediate ground level):  
900mm High Powdercoated Galvanised estate fence railing and gate to details.
- TYPE F**  
BOUNDARY WALL TYPE F:  
Existing low level brick wall with metal railings over between brick pillars.
- TYPE G**  
BOUNDARY WALL TYPE G:  
New wall to match existing low level brick wall with metal railings between brick pillars.
- TYPE F**  
BOUNDARY WALL TYPE F:  
Double line of railings along drainage ditch to match neighbouring development; lower line approx. 900mm high, upper line approx. 2100mm high.
- Gate Access

ALL HEIGHTS SHOWN RELATIVE TO OS MALIN HEAD DATUM UNLESS OTHERWISE NOTED. ALL DIMENSIONS IN MILLIMETRES UNLESS OTHERWISE NOTED.

Rev	Description	By	Ckd	Date

**e ml**  
ARCHITECTS

20 Cruises Street  
Limerick  
V94 R6P9  
Ireland  
(Registered Office)

37 Fitzwilliam Pl.  
Dublin 2  
D02 Y152  
Ireland

(061) 312 249  
limerick@eml.ie

(01) 670 7677  
dublin@eml.ie

www.eml.ie

eml Job No. **3586** Job Name **Dunleer Housing**

Client **Louth County Council**

Sheet Title **Proposed Boundary Types**

Stage **Section 179A**

Suitability **S2 - Suitable for Information**

Date	Scale @ A1	Drawn by	Checked by
28/03/2024	1:500	AH	TM

Drawing No. **3586-EML-XX-02-DR-A-0005**

Project - Originator - Volume - Level - Form - Role - Number

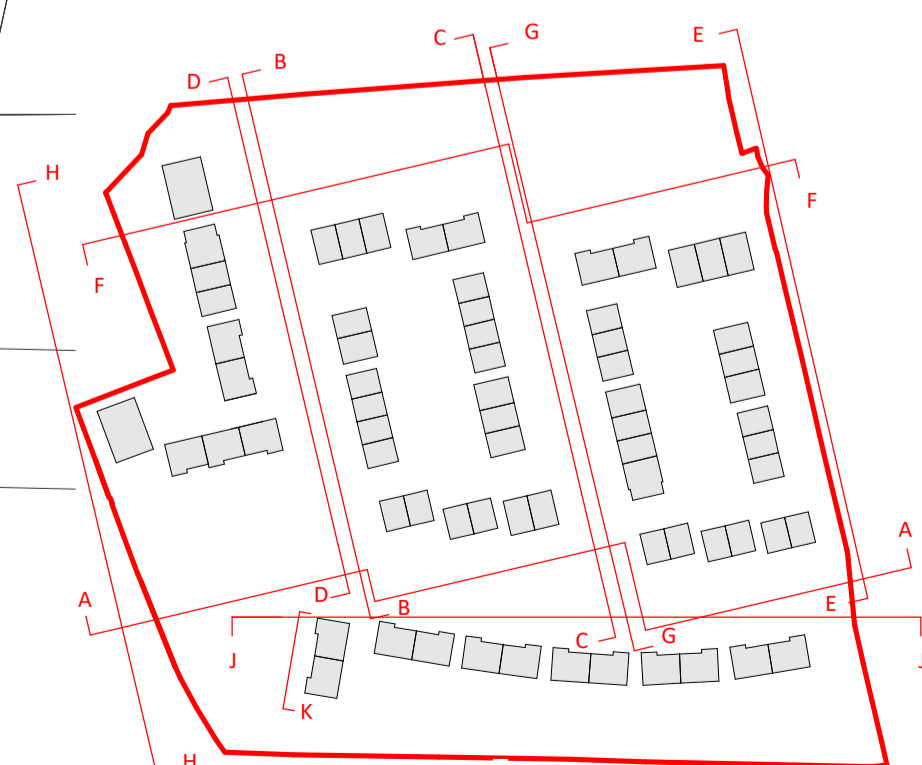

**Key plan**  
Scale 1:2000

