

An Coimín Commons

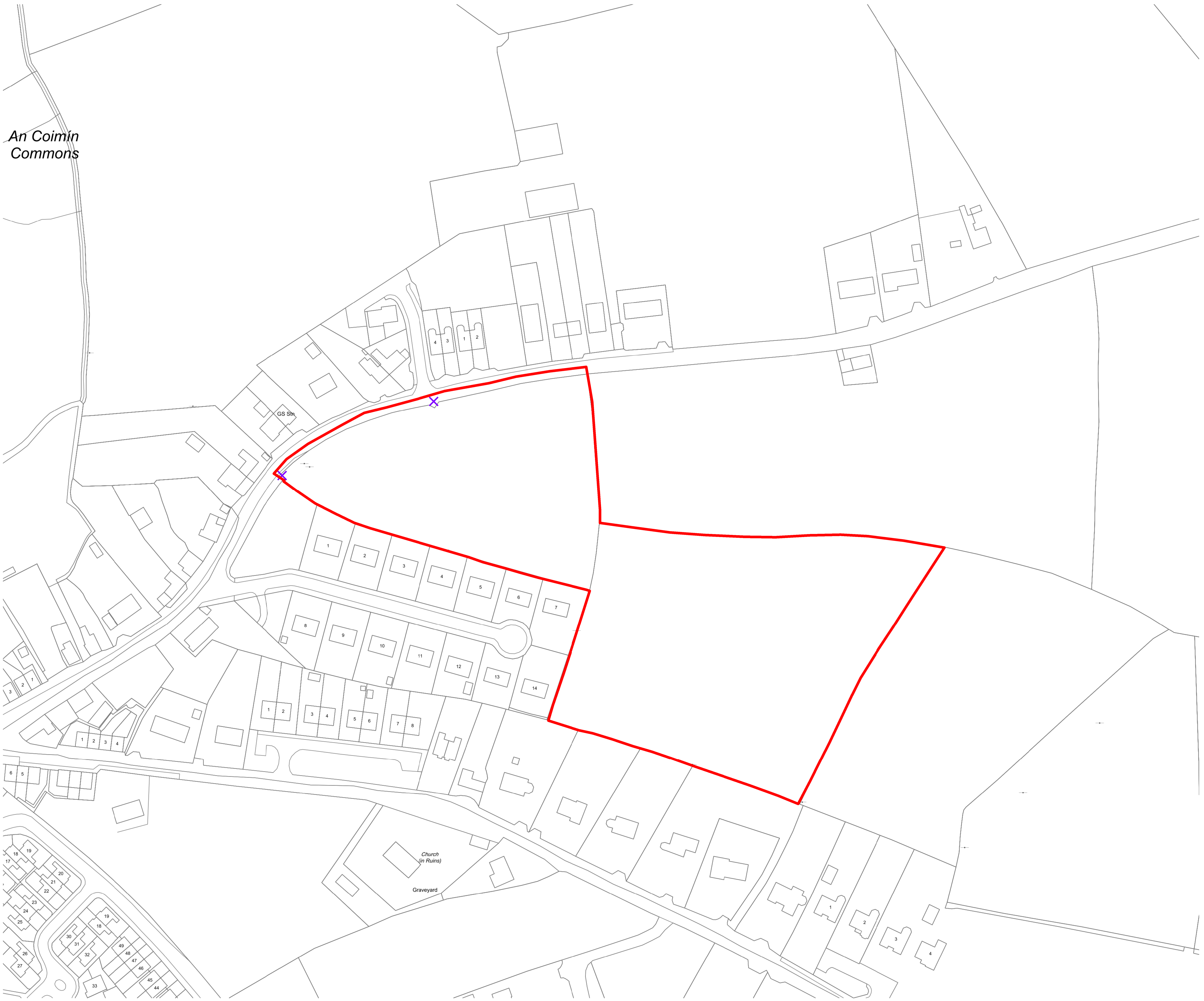

GENERAL NOTES:

A. THIS DRAWING IS TO BE READ IN CONJUNCTION WITH ALL RELEVANT ARCHITECTURAL DRAWINGS, THE SPECIFICATION, AND ALL RELEVANT STANDARD DETAIL DRAWINGS.

B. THIS DRAWING IS TO BE READ IN CONJUNCTION WITH ALL RELEVANT CIVIL, STRUCTURAL, MECHANICAL AND ELECTRICAL DRAWINGS TOGETHER WITH THE SPECIFICATIONS AND SCHEDULES.

C. ALL DIMENSIONS IN MILLIMETRES. DO NOT SCALE FROM THIS DRAWING. USE FIGURED DIMENSIONS ONLY.

D. CONTRACTOR MUST VERIFY ALL DIMENSIONS ON SITE BEFORE SETTING OUT, COMMENCING WORK, OR PRODUCING ANY SHOP DRAWINGS.

- Site Boundary
- Adjacent land under the control of the applicant
- × Location of site notices

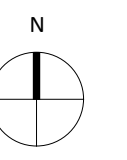

Map sheets: 1768-D, 1769-C
 Centre Coordinates: ITM 696141, 801285

© Tailte Éireann Surveying data reproduced under Licence number CYAL50380269. Unauthorised reproduction infringes Tailte Éireann copyright.

Rev	Description	By	Ckd	Date

e ml ARCHITECTS

20 Cruises Street
 Limerick
 V94 R6P9
 Ireland
 (Registered Office)
 (061) 312 249
 limerick@eml.ie

37 Fitzwilliam Pl.
 Dublin 2
 D02 Y152
 Ireland
 (01) 670 7677
 dublin@eml.ie
 www.eml.ie

e ml Job No. **3588** Job Name **Mullavally Housing**

Client **Louth County Council**

Sheet Title **Site Location Map**

Stage **Section 179A**

Suitability **S2 - Suitable for Information**

Date	Scale @ A1	Drawn by	Checked by
27/03/2024	1 : 1000	AH	TM

Drawing No. **3588-EML-XX-XX-DR-A-0001** Rev

Project - Originator - Volume - Level - Form - Role - Number