

**GENERAL NOTES:**

- A. THIS DRAWING IS TO BE READ IN CONJUNCTION WITH ALL RELEVANT ARCHITECTURAL DRAWINGS, THE SPECIFICATION, AND ALL RELEVANT STANDARD DETAIL DRAWINGS.
- B. THIS DRAWING IS TO BE READ IN CONJUNCTION WITH ALL RELEVANT CIVIL, STRUCTURAL, MECHANICAL AND ELECTRICAL DRAWINGS TOGETHER WITH THE SPECIFICATIONS AND SCHEDULES.
- C. ALL DIMENSIONS IN MILLIMETRES. DO NOT SCALE FROM THIS DRAWING. USE FIGURED DIMENSIONS ONLY.
- D. CONTRACTOR MUST VERIFY ALL DIMENSIONS ON SITE BEFORE SETTING OUT, COMMENCING WORK, OR PRODUCING ANY SHOP DRAWINGS.

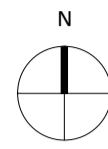

**BOUNDARY TYPES LEGEND**

- TYPE A**  
BOUNDARY POST + PANEL FENCE TYPE A (2000mm min. above immediate ground level):  
Precast concrete posts set in concrete pit base, infilled with timber board panels over 300mm concrete ground board.
- TYPE B**  
BOUNDARY WALL TYPE B (900mm min. above immediate ground level):  
215mm brick boundary garden wall with soldier course brick capping. At terrace locations 1800mm high for utility boxes for 900mm length, and continue with 900mm high wall.
- TYPE C**  
BOUNDARY WALL TYPE C (2000mm min. above immediate ground level):  
215mm brick boundary wall with soldier course brick capping.
- TYPE D**  
BOUNDARY WALL TYPE D (2000mm min. above immediate ground level):  
215mm rendered blockwork boundary wall with concrete capping. Piers on perimeter walls.
- TYPE E**  
BOUNDARY WALL TYPE E (900mm min. above immediate ground level):  
900mm High Powdercoated Galvanised estate fence railing and gate to details.
- Gate Access

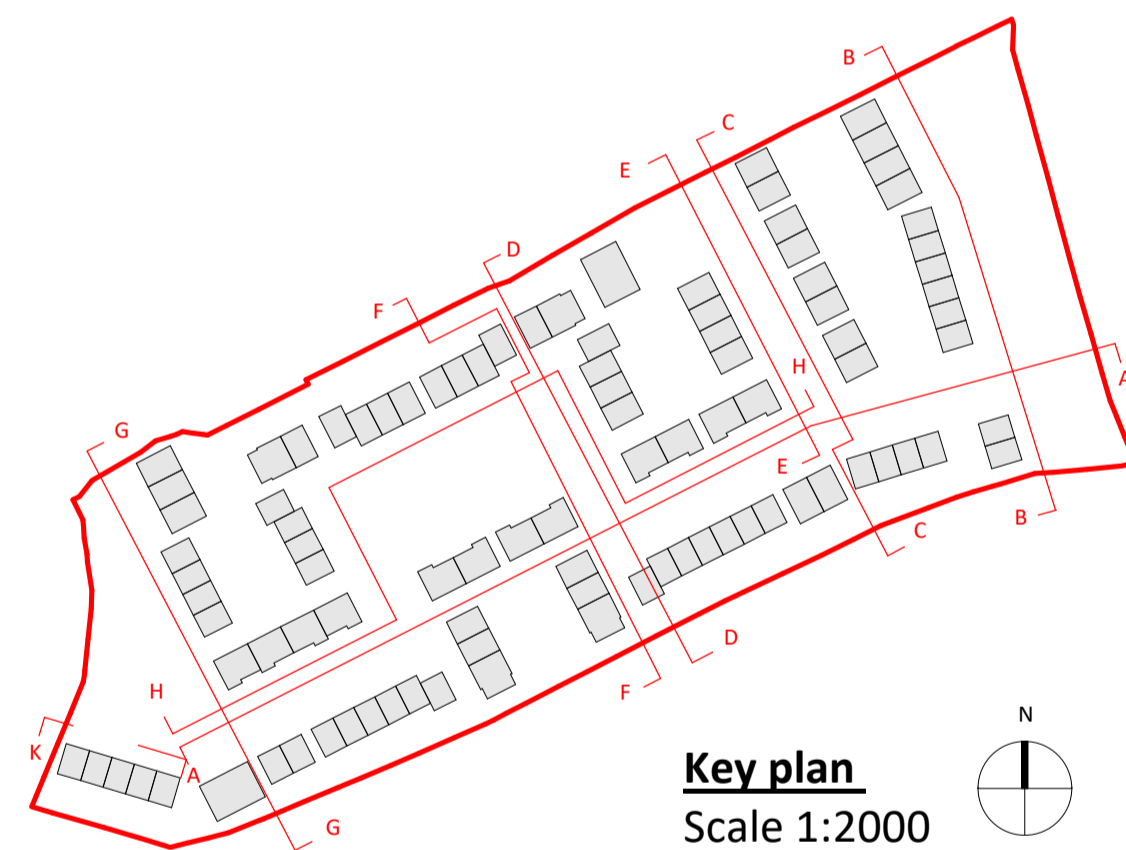

ALL HEIGHTS SHOWN RELATIVE TO OS MALIN HEAD DATUM UNLESS OTHERWISE NOTED. ALL DIMENSIONS IN MILLIMETRES UNLESS OTHERWISE NOTED.

Rev	Description	By	Ckd	Date

**e ml** ARCHITECTS

20 Cruises Street  
Limerick  
V94 R6P9  
Ireland  
(Registered Office)

37 Fitzwilliam Pl.  
Dublin 2  
D02 Y152  
Ireland

(061) 312 249  
limerick@eml.ie

(01) 670 7677  
dublin@eml.ie

www.eml.ie

e ml Job No. **3587** Job Name **Ballymakenny West Housing**

Client **Louth County Council**

Sheet Title **Proposed Boundary Types**

Stage **Section 179A**

Suitability **S2 - Suitable for Information**

Date **28/03/2024** Scale @ A1 **1:500** Drawn by **AH** Checked by **TM**

Drawing No. **3587-EML-XX-02-DR-A-0005** Rev  
Project - Originator - Volume - Level - Form - Role - Number

