

Site Location Map

1:1000

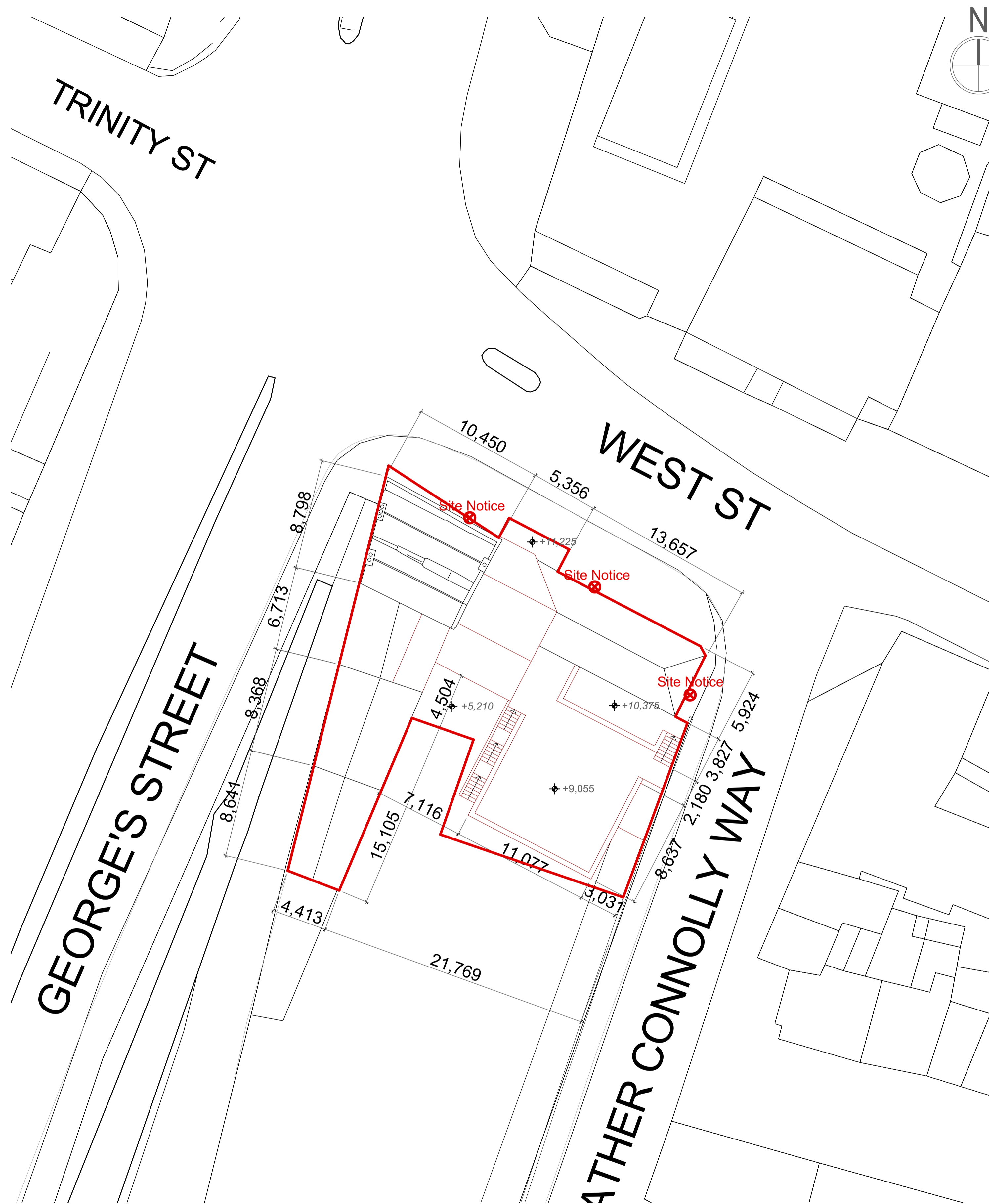

Site Plan

1:200

1

2



Integrated Design Team: Shaffrey Architects, RIAI Grade 1 Conservation Architects
 Barrett Mahony Consulting Engineers
 ORS Mechanical & Electrical Engineering
 Doyle Kent Planning Partnership Ltd
 IAC Archaeology
 Altamar Environmental Consultants
 Workhouse Union

KEY
 Site Outline ———
 Site Notice ⊗

Topographic map compiled and published by Tailte Éireann
 Order No. 50454160_1 Published 12/03/2025
 Map sheets 2319-11; 2319-16
 Output Scale: 1:1000

SHAFFREY ARCHITECTS
 RIAI Grade 1 Conservation Architects
 29 Lower Ormond Quay, Dublin 1
 D01 H299
 e + studio@shaffrey.ie
 t + 353 (1) 8725602

Client: Louth County Council
 County Hall, Millennium Centre
 Dundalk, A91 KFW6
 Date: March 2025
 Scale: 1:200, 1:1000 @ A1
 Drawn By: AR
 Checked by: EK

Project: **WEST GATE HOUSE**
 Westgate House and Drogheda Youth Development Building
 Refurbishment and Extension, West Street, Moneymore, Drogheda
 Drawing Title: **Proposed Site Plan**
 DWG NO.: **001.1**
 Issue: **Part 8 Planning**