

Existing



Spring Equinox

8am



Summer Solstice

8am

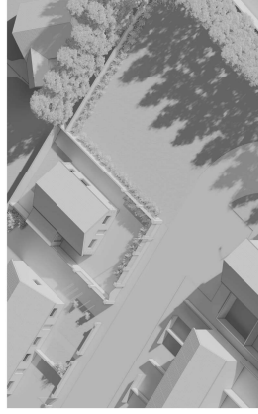

Autumn Equinox

8am



Winter Solstice

8am

Proposed



8am

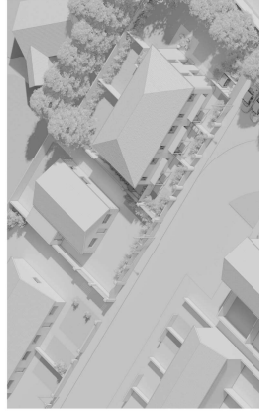

8am

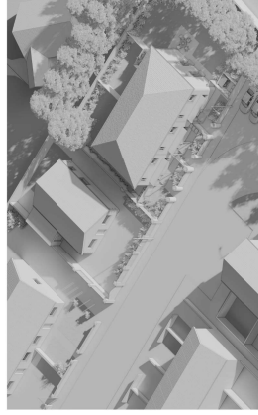

8am

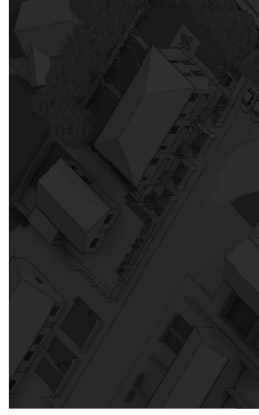

8am

Existing



9am

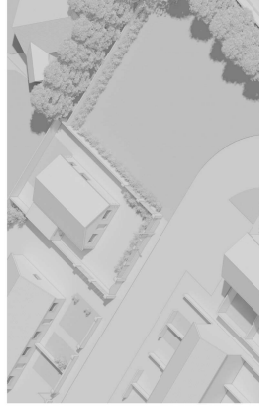

9am

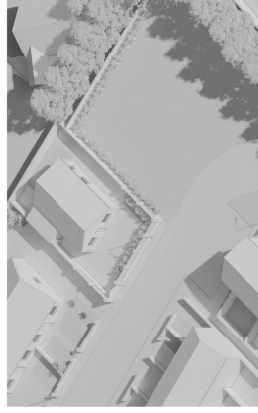

9am

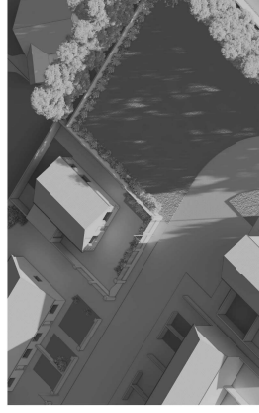

9am

Proposed



9am

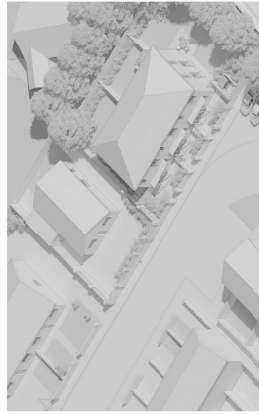

9am

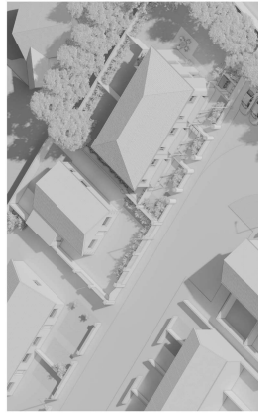

9am

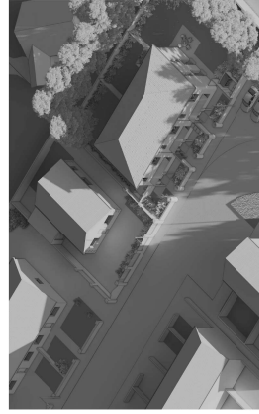

9am



Comhairlí Áitiúla Chondae Lú
LOUTH LOCAL AUTHORITIES
 LOUTH COUNTY COUNCIL
 County Hall, Millennium Centre,
 Dundalk, Co. Louth,
 Phone (042)9355457

Notes
 1 This drawing is the property of the Local Authority. It is a confidential document and must not be copied, used, or its contents divulged without prior written consent.
 2 DO NOT SCALE, use figured dimensions only, if in doubt ask.
 3 To be read in conjunction with all contract drawings and specifications.

Rev. No.	Date	By	Description
C	24/10/23	BMcA	Section 179(G) Submission
B	01/08/23	BMcA	Section 179(G) Submission
A	30/06/23	BMcA	Section 179(G) Submission

Job
 GRANGE CLOSE
 MUIRHEVNAMORE
 DUNDALK CO. LOUTH

Title
 EXISTING VS. PROPOSED SHADOW STUDY SECTION 179(A) SUBMISSION

Issue Details
 Drawn B McA
 Sheet A1
 Scale
 Date OCTOBER 2023
 Office Use Only
 Drawing No. SS 001
 Rev. C

Existing

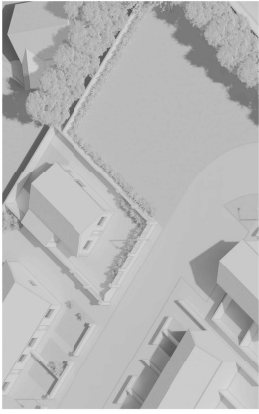

Spring Equinox

10am

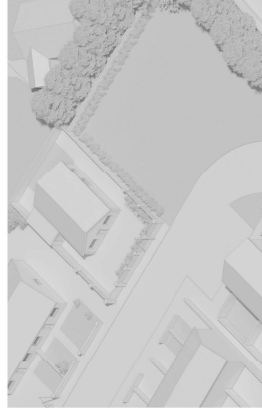

Summer Solstice

10am

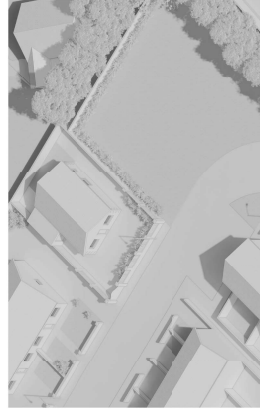

Autumn Equinox

10am

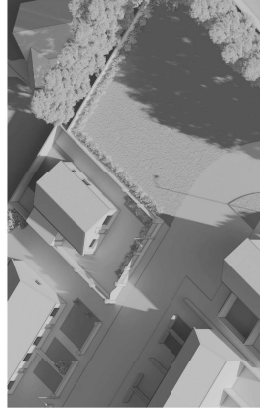

Winter Solstice

10am

Proposed

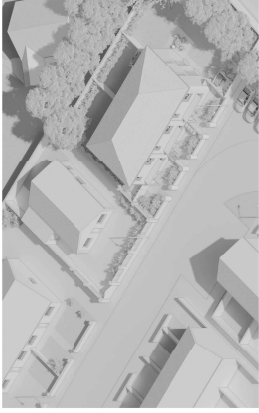

10am

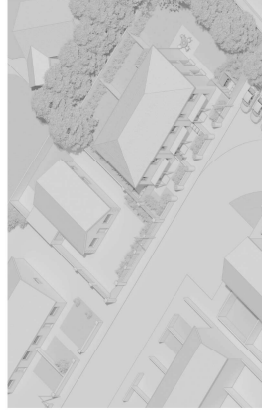

10am

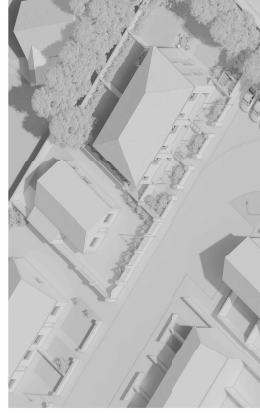

10am

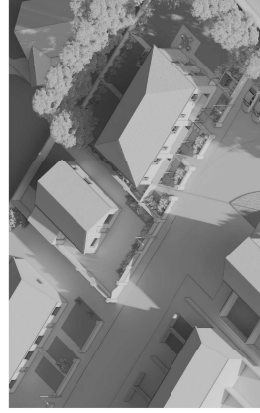

10am

Existing

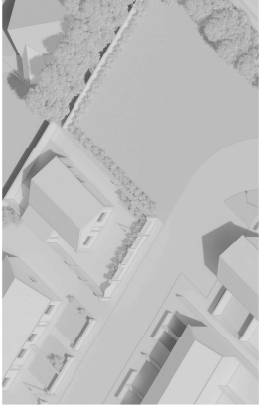

11am

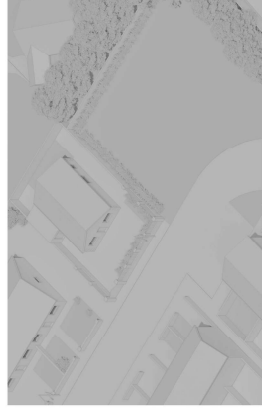

11am



11am

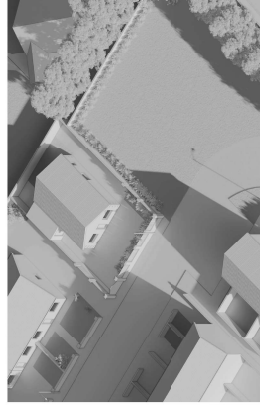

11am

Proposed

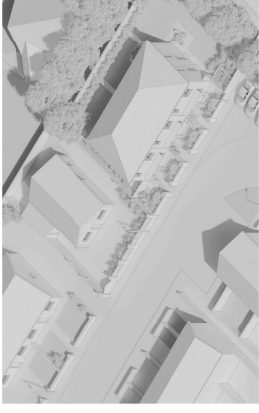

11am

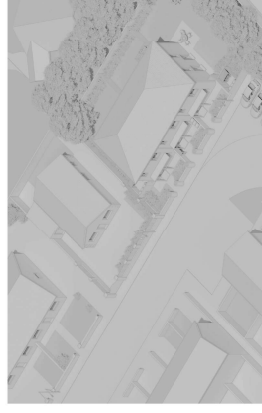

11am

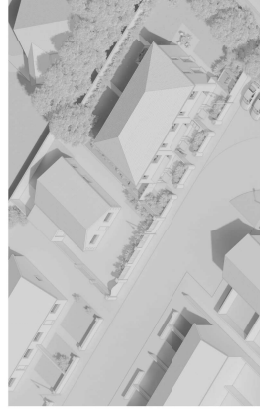

11am

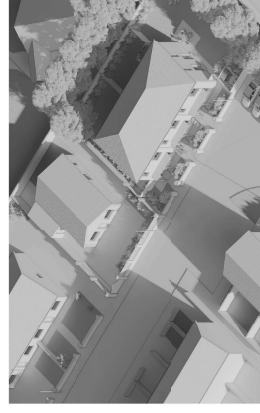

11am

Comhairl  Aiti la Chondae L 
LOUTH LOCAL AUTHORITIES
 LOUTH COUNTY COUNCIL
 County Hall, Millennium Centre,
 Dundalk, Co. Louth,
 Phone (042)9355457



Notes
 1 This drawing is the property of the Local Authority. It is a confidential document and must not be copied, used, or its contents divulged without prior written consent.
 2 DO NOT SCALE, use figured dimensions only, if in doubt ask.
 3 To be read in conjunction with all contract drawings and specifications.

Rev.	Date	By	Description
C	24/10/23	BMcA	Section 179(G) Submission
B	01/08/23	BMcA	Section 179(G) Submission
A	30/06/23	BMcA	Section 179(G) Submission

Job
 GRANGE CLOSE
 MUIRHEVNAMORE
 DUNDALK CO.LOUTH

Title
 EXISTING VS. PROPOSED SHADOW STUDY SECTION 179(A) SUBMISSION

Issue Details		Office Use Only	
Drawn	B McA	Drawing No.	SS 002
Sheet	A1	Scale	
Date	OCTOBER 2023	Rev.	C



DAYLIGHT FACTOR CALCULATION (UNITS 1 & 2) Kitchen & Dining Area Units 1 & 2

Table with 4 columns: Area (m²), Ceiling Height, Floor, Wall, Window W x H, Total. Values: 6.04, 2.50, 0.00, 0.00, 2.10 x 1.50, 9.13.



Summary of Daylight Factor - DF table with columns: Room, DF, A, W, M, T, Average.

Source: Code for Sustainable Homes, HQE, Miljøbyggnad. The intention is to: promote good daylighting and thereby reduce the need for energy to light the home...

- 1 Intent: promote good daylighting and thereby reduce the need for energy to light the home. 2 Assessment methodology: This is based on a calculation of daylight factor in the home.

Level 4 - At least one of the living/kitchen spaces achieves average 2% daylight factor, with other living spaces achieving 2% and bedrooms achieve average 1.5% daylight factor.

Level 3 - Living spaces achieve average 2% daylight factor and bedrooms achieve average 1.5% daylight factor.

Level 2 - Living Room /Kitchen achieve average 1.5% daylight factor and bedrooms achieve average 1.5% daylight factor.

Level 1 - No calculation but all living spaces/bedrooms have window aperture area > 10% of floor area.



DAYLIGHT FACTOR CALCULATION (UNITS 1 & 2) Living Room Units 1 & 2

Table with 4 columns: Area (m²), Ceiling Height, Floor, Wall, Window W x H, Total. Values: 3.57, 2.50, 0.00, 0.00, 2.10 x 1.50, 7.18.



Summary of Daylight Factor - DF table with columns: Room, DF, A, W, M, T, Average.

Source: Code for Sustainable Homes, HQE, Miljøbyggnad. The intention is to: promote good daylighting and thereby reduce the need for energy to light the home...

- 1 Intent: promote good daylighting and thereby reduce the need for energy to light the home. 2 Assessment methodology: This is based on a calculation of daylight factor in the home.

Level 4 - At least one of the living/kitchen spaces achieves average 2% daylight factor, with other living spaces achieving 2% and bedrooms achieve average 1.5% daylight factor.

Level 3 - Living spaces achieve average 2% daylight factor and bedrooms achieve average 1.5% daylight factor.

Level 2 - Living Room /Kitchen achieve average 1.5% daylight factor and bedrooms achieve average 1.5% daylight factor.

Level 1 - No calculation but all living spaces/bedrooms have window aperture area > 10% of floor area.



DAYLIGHT FACTOR CALCULATION (UNIT 3) Kitchen and Dining Area Unit 3

Table with 4 columns: Area (m²), Ceiling Height, Floor, Wall, Window W x H, Total. Values: 6.04, 2.50, 0.00, 0.00, 2.10 x 1.50, 9.13.



Summary of Daylight Factor - DF table with columns: Room, DF, A, W, M, T, Average.

Source: Code for Sustainable Homes, HQE, Miljøbyggnad. The intention is to: promote good daylighting and thereby reduce the need for energy to light the home...

- 1 Intent: promote good daylighting and thereby reduce the need for energy to light the home. 2 Assessment methodology: This is based on a calculation of daylight factor in the home.

Level 4 - At least one of the living/kitchen spaces achieves average 2% daylight factor, with other living spaces achieving 2% and bedrooms achieve average 1.5% daylight factor.

Level 3 - Living spaces achieve average 2% daylight factor and bedrooms achieve average 1.5% daylight factor.

Level 2 - Living Room /Kitchen achieve average 1.5% daylight factor and bedrooms achieve average 1.5% daylight factor.

Level 1 - No calculation but all living spaces/bedrooms have window aperture area > 10% of floor area.



DAYLIGHT FACTOR CALCULATION (UNIT 3) Living Space Unit 3

Table with 4 columns: Area (m²), Ceiling Height, Floor, Wall, Window W x H, Total. Values: 3.57, 2.50, 0.00, 0.00, 2.10 x 1.50, 7.18.



Summary of Daylight Factor - DF table with columns: Room, DF, A, W, M, T, Average.

Source: Code for Sustainable Homes, HQE, Miljøbyggnad. The intention is to: promote good daylighting and thereby reduce the need for energy to light the home...

- 1 Intent: promote good daylighting and thereby reduce the need for energy to light the home. 2 Assessment methodology: This is based on a calculation of daylight factor in the home.

Level 4 - At least one of the living/kitchen spaces achieves average 2% daylight factor, with other living spaces achieving 2% and bedrooms achieve average 1.5% daylight factor.

Level 3 - Living spaces achieve average 2% daylight factor and bedrooms achieve average 1.5% daylight factor.

Level 2 - Living Room /Kitchen achieve average 1.5% daylight factor and bedrooms achieve average 1.5% daylight factor.

Level 1 - No calculation but all living spaces/bedrooms have window aperture area > 10% of floor area.

LIVING SPACE UNITS 20A & 20B



Comhairlí Aitiúla Chondae Lú LOUTH LOCAL AUTHORITIES LOUTH COUNTY COUNCIL County Hall, Millennium Centre, Dundalk, Co. Louth, Phone (042)9355457

LIVING SPACE UNIT 20C

Table with columns: Job, Section 179(g) Submission, Section 179(g) Submission, Section 179(g) Submission, Rev, Date, By, Description.

GRANGE CLOSE MUIRHEVNAMORE DUNDALK CO.LOUTH

Table with columns: Title, Issue Details, Office Use Only. Title: DAYLIGHT FACTOR CALCULATION SECTION 179(A) SUBMISSION. Issue Details: Drawn B McA, Sheet A1, Scale DFC 001, Date OCTOBER 2023, Rev. C.

Notes: 1 This drawing is the property of the Local Authority. It is a confidential document and must not be copied, used, or its contents divulged without prior written consent. 2 DO NOT SCALE, use figured dimensions only, if in doubt ask. 3 To be read in conjunction with all contract drawings and specifications.

