

Site Plan & Proposed Works

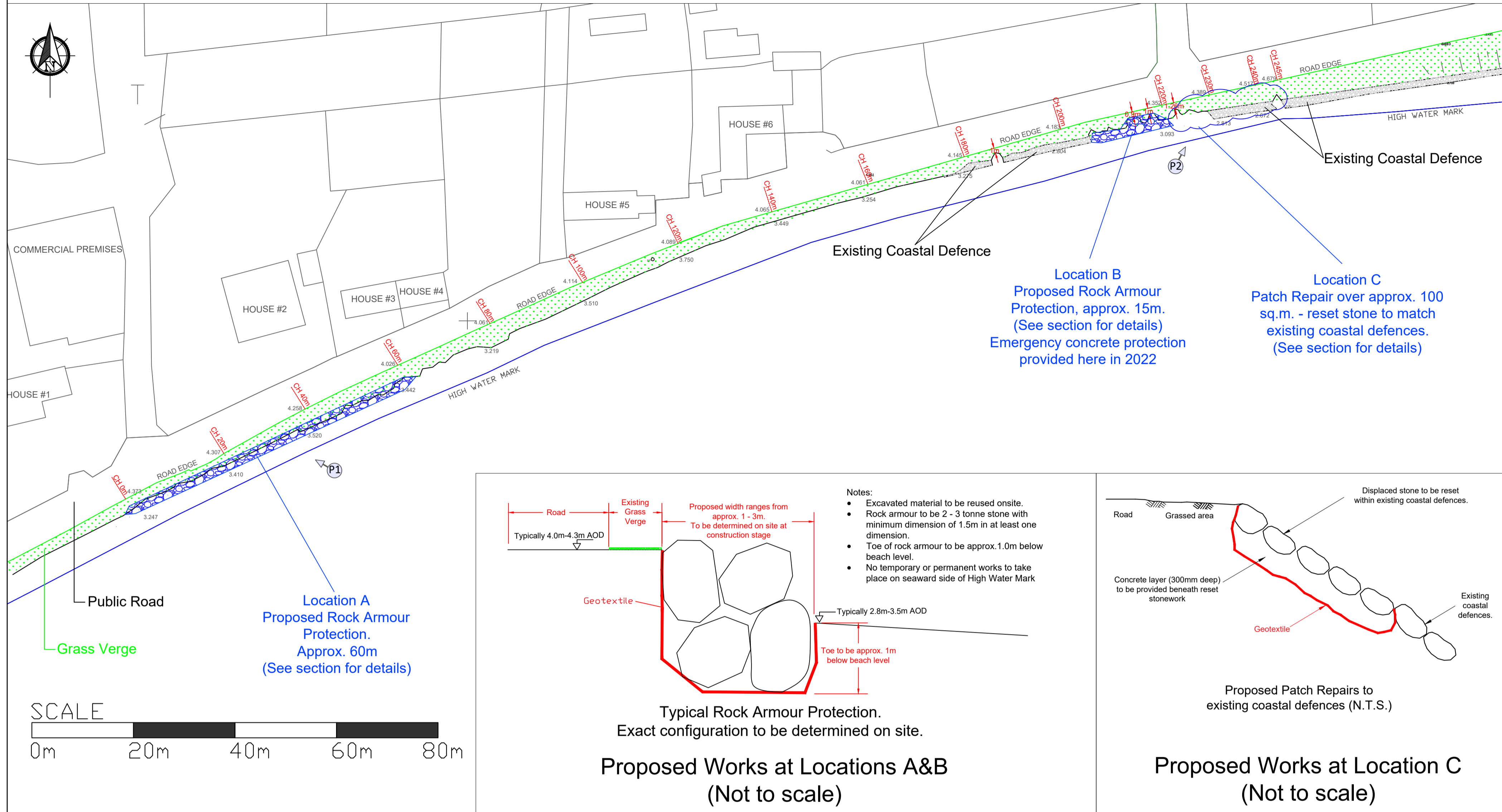

Site Location Map

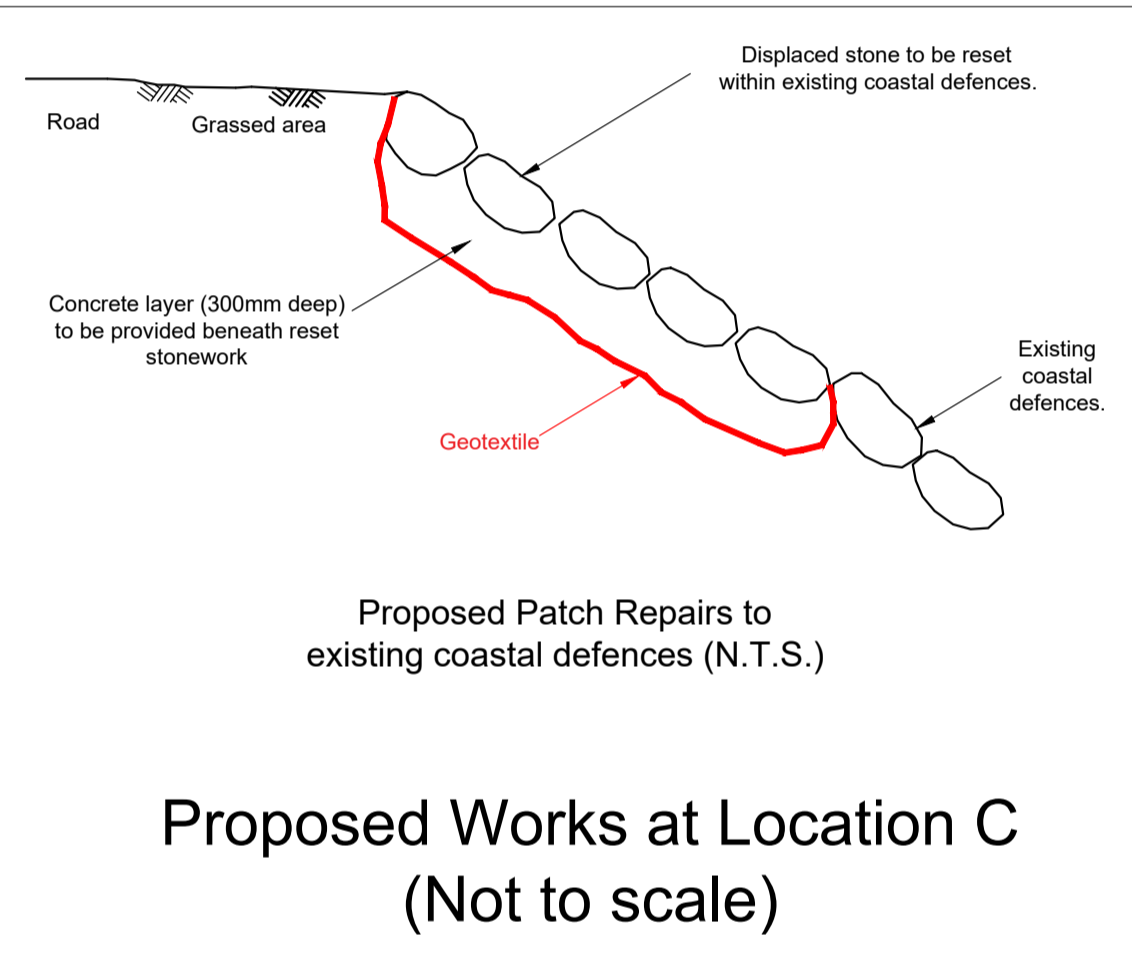
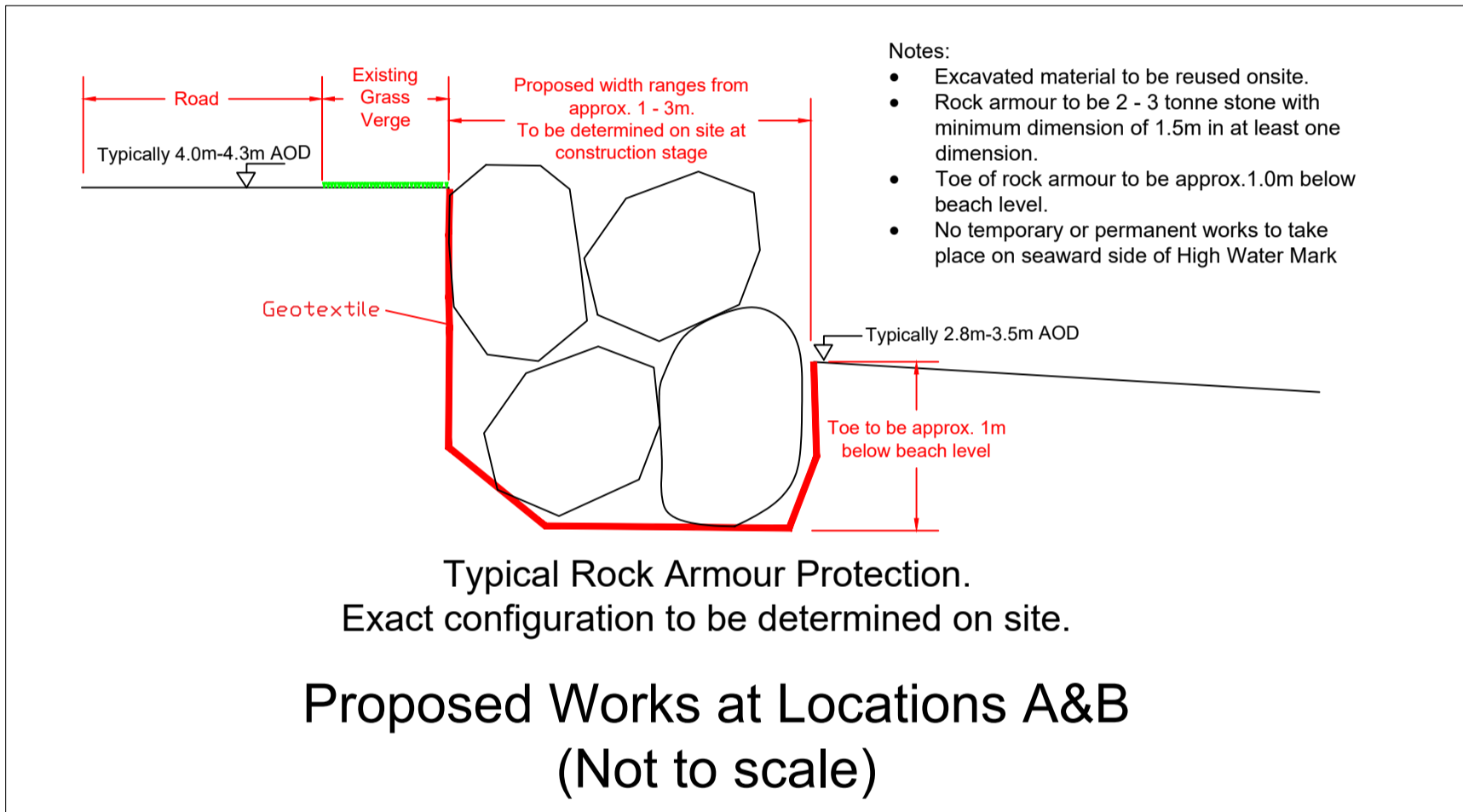
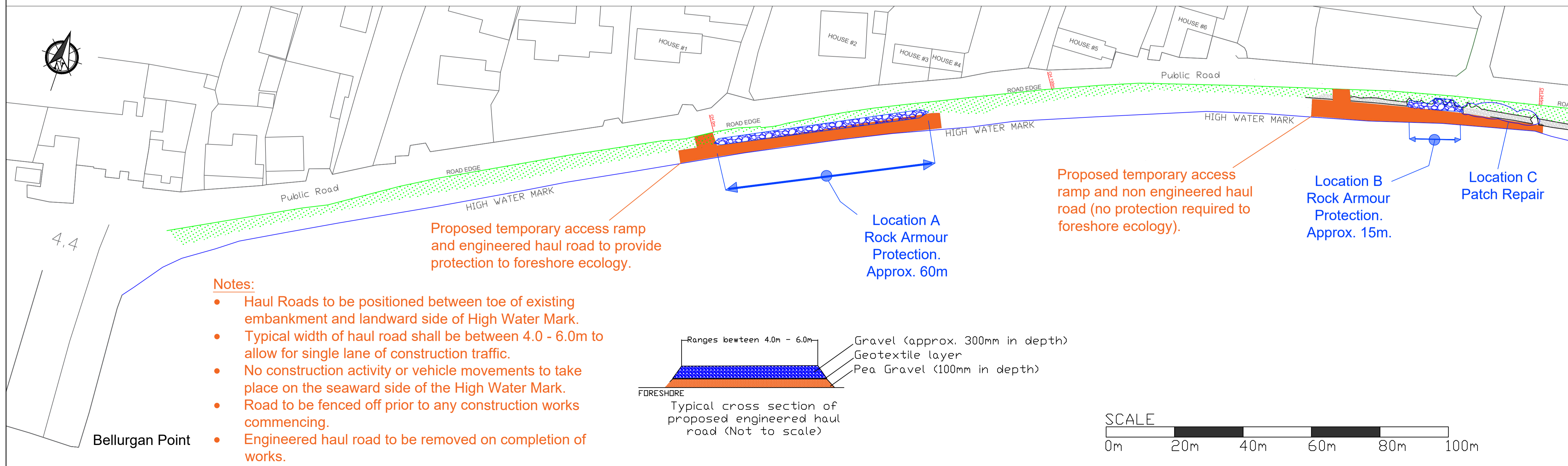

Image P1 - Eroding clay bank with no existing protection



Image P2 - Existing coastal defence stonework displaced and non effective

Proposed Haul Road



B	Proposed access ramps and haul roads inserted as per NIS	Jan. '24
A	Drawing layout amended, inserted proposed haul road	Oct. '23
Rev.	Comment	Date

Comhairle Contae Lú
Louth County Council
 County Hall, Millennium Centre,
 Dundalk, County Louth
www.louthcoco.ie
Ms Catherine Saff
Director of Service

Project: Coastal Erosion - Bellurgan Point	
Drawing Title: Proposed Coastal Erosion Works	
Designed:	Checked: CS
Drawn: J.K.	Approved: CS
© Ordnance Survey Ireland. All rights reserved. OSI Licence Number: 2022/30/CCMA/Louth County Council	
Date: January 2024	Dwg. No. CE-2023-01-01
Scale: Not to scale	