

LEGEND:  
EXTENTS OF PLANNING —



SCALE: 1:2500 @ A1; 1:5000 @ A3

Client

**An Roinn Forbartha Tuaithe agus Pobail**  
Department of Rural and Community Development

**An Ciste um Athghiniúint agus Forbairt Tuaithe**  
Rural Regeneration and Development Fund

**Rialtas na hÉireann**  
Government of Ireland

**Tionscadal Éireann 2040**

Comhairle Contae Lú  
Louth County Council

Ár dTodhchaí Tuaithe  
Our Rural Future

**General Notes**

(i) Hard copies, dwf and pdf will form a controlled issue of the drawing. All other formats (dwg etc.) are deemed to be an uncontrolled issue and any work carried out based on these files is at the recipients own risk. RPS will not accept any responsibility for any errors from the use of these files, either by human error or by the recipient, listing of the un-dimensioned measurements, compatibility with the recipients software, and any errors arising when these files are used to aid the recipients drawing production, or setting out on site.

(ii) DO NOT SCALE, use figured dimensions only.

(iii) This drawing is the property of RPS, it is a project confidential classified document. It must not be copied used or its contents divulged without prior written consent. The needs and expectations of client and RPS must be considered when working with this drawing.

(iv) Information including topographical survey, geotechnical investigation and utility detail used in the design have been provided by others.

(v) All Levels refer to Ordnance Survey Datum, Malin Head.

Rev	Date	Drn Cnk	App	Amendment / Issue
P04	18.04.23	Mf DfE		PLANNING
P03	17.04.23	JBR DfE		PLANNING
P02	06.04.23	Mf DfE		PLANNING
P01	22.12.22	Mf DfE		PLANNING

Model File Identifier  
N/A

Scale	1:2500 @ A1 1:5000 @ A3	Project	LIVING IN CARLINGFORD VISITING CARLINGFORD RRDF		
Created on	JULY 2021	Title	SITE LOCATION PLAN		
Sheets	01 of 01	File Identifier	Drawing No.	Status	Rev
		MGT0610-RPS-00-XX-M2-C-IX0001	IX0001-01	S4	P04

T:\MGT0610 - Carlingford RRDF\0610-RPS-00-XX-M2-C-IX0001-Location Map.dwg



**NOTES**

1. Verifying Dimensions. Dimensions should be verified against such other drawings or site conditions as pertain to this scheme proposal.
2. Existing Services. Any information concerning the location of existing services indicated on this drawing is intended for general guidance only.
3. Issue of Drawings. Best copies of this drawing should be used for construction. For Planning Only. Final locations of Street Lighting and Street Furniture will be subject to site conditions/constraints.
4. Final locations of Street Lighting and Street Furniture will be subject to site conditions/constraints.

**Legend**

- Existing tree to be retained
- Proposed 'Semi-mature' tree planting: Acer campestre, Standard (Semi mature) Refer to drawing no. 2391.4.02; Planting Schedule Table 02
- Proposed 'Street tree' planting in paved tree pit: Tilia cordata 'Green Spire', Standard (Semi mature) Refer to drawing no. 2391.4.02; Planting Schedule Table 02
- Proposed 'Semi-mature' tree planting: Pinus sylvestris, Standard (Semi mature) Refer to drawing no. 2391.4.02; Planting Schedule Table 02
- Proposed Ornamental shrub planting Refer to drawing no. 2391.4.02; Planting Schedule Table 03
- Proposed Woodland planting Refer to drawing no. 2391.4.02; Planting Schedule Table 05
- Proposed open grass areas Refer to drawing no. 2391.4.02; Planting Schedule Table 01
- Proposed Shrub planting Refer to drawing No. 2391.4.02; Planting Schedule Table 04
- Proposed Asphalt Road surfacing
- Proposed Natural Stone Paving Setts (Note: Asphalt may be installed to roadways as an alternative to setts where necessary)
- Proposed Natural Stone Paving Setts
- Proposed Natural Stone Step Units to grass areas
- Proposed Natural Stone Trim Units (Laid flush)
- Proposed Natural Stone 'High' Kerb (125mm height)
- Proposed Natural Stone 'Mid' Kerb (60mm height)
- Proposed Natural Stone 'Flush' Kerb
- Proposed Resin Bound Gravel pedestrian footways
- Bench Seating
- Picnic Tables
- Feature Lighting Columns
- Feature Lighting 'Totem'
- Location for future Sculptural Play features/Art Work
- Surface Water Feature
- Canopies/Covered Public Spaces
- Cycle Stands
- Public Cycle Repair Stand
- Location for new Public Toilet Facilities (Subject to separate planning application)
- 'Wayfinding' paving
- 'LED' in-ground strip lighting
- Extents of Planning Application

P02	Planning Issue	RH	06.04.23
rev	amendments	check	date

**rps** Elmwood House  
74 Boucher Road  
Belfast  
BT12 6RZ

T +44 (0) 28 90 667914  
F +44 (0) 28 90 668286  
W [www.rpsgroup.com/ireland](http://www.rpsgroup.com/ireland)  
E [ireland@rpsgroup.com](mailto:ireland@rpsgroup.com)

Client  
**Louth County Council**

Project  
**Carlingford PR Scheme**

Title  
**Public Realm Enhancements  
General Arrangement**

Project Number NI2391	Sheet Size A1	Drawing Scale 1:500@A1
--------------------------	------------------	---------------------------

Drawing Number  
**2391.1.03**

Drawn By WOD	Status Planning	Revision <b>P02</b>
-----------------	--------------------	------------------------

Checked By RH	Approved By RH	Date 03.05.22
------------------	-------------------	------------------

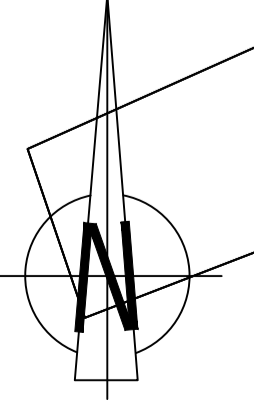

- NOTES**
1. Verifying Dimensions. Dimensions should be verified against such other drawings or site conditions as pertain to this scheme proposal.
  2. Loading Services. Any information concerning the location of existing services indicated on this drawing is intended for general guidance only.
  3. Issue of Drawings. Best copies of all form a controlled issue of the drawing - For Planning Only.
  4. Final locations of Street Lighting and Street Furniture will be subject to site conditions/constraints.
- Legend**
- Existing tree to be retained
  - Proposed 'Semi-mature' tree planting:  
Azar campestre, Standard (Semi mature)  
Refer to drawing no. 2391.4.02; Planting Schedule Table 02
  - Proposed 'Street tree' planting in paved tree pit: Tilia cordata  
'Green Spire', Standard (Semi mature)  
Refer to drawing no. 2391.4.02; Planting Schedule Table 02
  - Proposed 'Semi-mature' tree planting:  
Pinus sylvestris, Standard (Semi mature)  
Refer to drawing no. 2391.4.02; Planting Schedule Table 02
  - Proposed Ornamental shrub planting  
Refer to drawing no. 2391.4.02; Planting Schedule Table 03
  - Proposed Woodland planting  
Refer to drawing no. 2391.4.02; Planting Schedule Table 05
  - Proposed open grass areas  
Refer to drawing no. 2391.4.02; Planting Schedule Table 01
  - Proposed Shrub planting  
Refer to drawing No. 2391.4.02; Planting Schedule Table 04
  - Proposed Asphalt Road surfacing
  - Proposed Natural Stone Paving Sets  
(Note: Asphalt may be installed to roadways as an alternative to sets where necessary)
  - Proposed Natural Stone Paving Sets
  - Proposed Natural Stone Step Units to grass areas
  - Proposed Natural Stone Trim Units (Laid flush)
  - Proposed Natural Stone 'High' Kerb (125mm height)
  - Proposed Natural Stone 'Mid' Kerb (60mm height)
  - Proposed Natural Stone 'Flush' Kerb
  - Proposed Resin Bound Gravel pedestrian footways
  - Bench Seating
  - Picnic Tables
  - Feature Lighting Columns
  - Feature Lighting 'Totem'
  - Location for future Sculptural Play features/Art Work
  - Surface Water Feature
  - Canopies/Covered Public Spaces
  - Cycle Stands
  - Public Cycle Repair Stand
  - WC
  - Location for new Public Toilet Facilities (Subject to separate planning application)
  - 'Wayfinding' paving
  - 'LED' in-ground strip lighting
  - Extents of Planning Application

P02	Planning Issue	RH	06.04.23
rev	amendments	check	date

**rps** Elmwood House  
74 Boucher Road  
Belfast  
BT12 6RZ

T +44 (0) 28 90 667914  
F +44 (0) 28 90 668286  
W [www.rpsgroup.com/ireland](http://www.rpsgroup.com/ireland)  
E ireland@rpsgroup.com

Client  
**Louth County Council**

Project  
**Carlingford PR Scheme**

Title  
**Public Realm Enhancements  
General Arrangement  
(Sheet 1 of 3)**

Project Number	Sheet Size	Drawing Scale
NI2391	A1	1:200@A1

Drawing Number  
**2391.1.04**

Drawn By	Status	Revision
WOD	Planning	P02

Checked By	Approved By	Date
RH	RH	03.05.22



**NOTES**

1. Verifying Dimensions.
2. Dimensions should be verified against such other drawings or site conditions as pertain to this scheme proposal.
3. Existing Services.
4. Any information concerning the location of existing services indicated on this drawing is intended for general guidance only.
5. Issue of Drawings.
6. Best copies pdf form a controlled issue of the drawing - For Planning Only.
7. Final locations of Street Lighting and Street Furniture will be subject to site conditions/constraints.

**Legend**

- Existing tree to be retained
- Proposed 'Semi-mature' tree planting:  
Acor campestre, Standard (Semi mature)  
Refer to drawing no. 2391.4.02; Planting Schedule Table 02
- Proposed 'Street tree' planting in paved tree pit: Tilia cordata  
'Green Spire', Standard (Semi mature)  
Refer to drawing no. 2391.4.02; Planting Schedule Table 02
- Proposed 'Semi-mature' tree planting:  
Pinus sylvestris, Standard (Semi mature)  
Refer to drawing no. 2391.4.02; Planting Schedule Table 02
- Proposed Ornamental shrub planting  
Refer to drawing no. 2391.4.02; Planting Schedule Table 03
- Proposed Woodland planting  
Refer to drawing no. 2391.4.02; Planting Schedule Table 05
- Proposed open grass areas  
Refer to drawing no. 2391.4.02; Planting Schedule Table 01
- Proposed Shrub planting  
Refer to drawing No. 2391.4.02; Planting Schedule Table 04
- Proposed Asphalt Road surfacing
- Proposed Natural Stone Paving Setts  
(Note: Asphalt may be installed to roadways as an alternative to setts where necessary)
- Proposed Natural Stone Paving Setts
- Proposed Natural Stone Step Units to grass areas
- Proposed Natural Stone Trim Units  
(Laid flush)
- Proposed Natural Stone 'High' Kerb  
(125mm height)
- Proposed Natural Stone 'Mid' Kerb  
(60mm height)
- Proposed Natural Stone 'Flush' Kerb
- Proposed Resin Bound Gravel pedestrian footways
- Bench Seating
- Picnic Tables
- Feature Lighting Columns
- Feature Lighting 'Totem'
- Location for future Sculptural Play features/Art Work
- Surface Water Feature
- Canopies/Covered Public Spaces
- Cycle Stands
- Public Cycle Repair Stand
- WC
- Location for new Public Toilet Facilities  
(Subject to separate planning application)
- 'Wayfinding' paving
- 'LED' in-ground strip lighting
- Extents of Planning Application

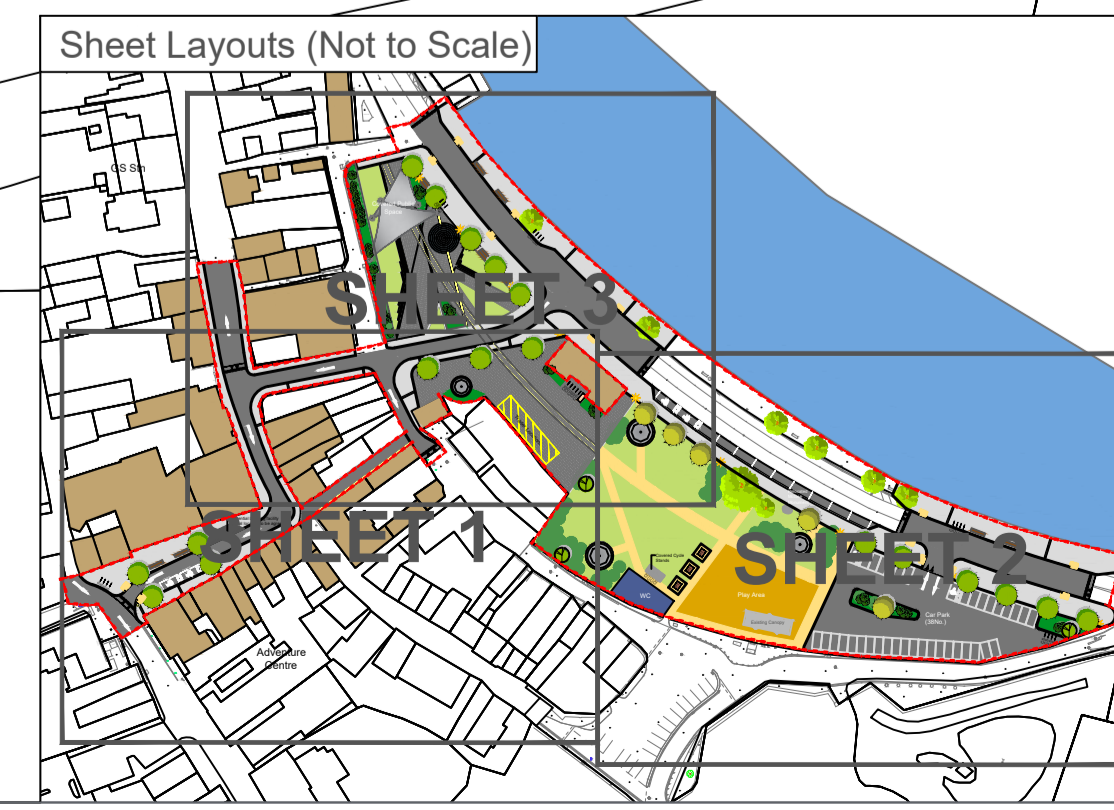

P02   Planning Issue	RH	06.04.23
rev amendments	check	date

**rps** Elmwood House  
74 Boucher Road  
Belfast  
BT12 6RZ

T +44 (0) 28 90 667914  
F +44 (0) 28 90 668286  
W [www.rpsgroup.com/ireland](http://www.rpsgroup.com/ireland)  
E [ireland@rpsgroup.com](mailto:ireland@rpsgroup.com)

Client  
**Louth County Council**

Project  
**Carlingford PR Scheme**

Title  
**Public Realm Enhancements  
General Arrangement  
(Sheet 2 of 3)**

Project Number NI2391	Sheet Size A1	Drawing Scale 1:200@A1
--------------------------	------------------	---------------------------

Drawing Number  
**2391.1.05**

Drawn By WOD	Status Planning	Revision <b>P02</b>
-----------------	--------------------	------------------------

Checked By RH	Approved By RH	Date 03.05.22
------------------	-------------------	------------------



**NOTES**

1. Verifying Dimensions. Dimensions should be verified against such other drawings or site conditions as pertain to this scheme proposal.
2. Existing Services. Any information concerning the location of existing services indicated on this drawing is intended for general guidance only.
3. Issue of Drawings. Best copies of this drawing should be used for all purposes. For Planning Only.
4. Final locations of Street Lighting and Street Furniture will be subject to site conditions/constraints.

- Legend**
- Existing tree to be retained
  - Proposed 'Semi-mature' tree planting:  
Azar campestre, Standard (Semi mature)  
Refer to drawing no. 2391.4.02; Planting Schedule Table 02
  - Proposed 'Street tree' planting in paved tree pit: Tilia cordata  
'Green Spire', Standard (Semi mature)  
Refer to drawing no. 2391.4.02; Planting Schedule Table 02
  - Proposed 'Semi-mature' tree planting:  
Pinus sylvestris, Standard (Semi mature)  
Refer to drawing no. 2391.4.02; Planting Schedule Table 02
  - Proposed Ornamental shrub planting  
Refer to drawing no. 2391.4.02; Planting Schedule Table 03
  - Proposed Woodland planting  
Refer to drawing no. 2391.4.02; Planting Schedule Table 05
  - Proposed open grass areas  
Refer to drawing no. 2391.4.02; Planting Schedule Table 01
  - Proposed Shrub planting  
Refer to drawing No. 2391.4.02; Planting Schedule Table 04
  - Proposed Asphalt Road surfacing
  - Proposed Natural Stone Paving Sets  
(Note: Asphalt may be installed to roadways as an alternative to sets where necessary)
  - Proposed Natural Stone Paving Sets
  - Proposed Natural Stone Step Units to grass areas
  - Proposed Natural Stone Trim Units  
(Laid flush)
  - Proposed Natural Stone 'High' Kerb  
(125mm height)
  - Proposed Natural Stone 'Mid' Kerb  
(60mm height)
  - Proposed Natural Stone 'Flush' Kerb
  - Proposed Resin Bound Gravel pedestrian footways
  - Bench Seating
  - Picnic Tables
  - Feature Lighting Columns
  - Feature Lighting 'Totem'
  - Location for future Sculptural Play features/Art Work
  - Surface Water Feature
  - Canopies/Covered Public Spaces
  - Cycle Stands
  - Public Cycle Repair Stand
  - Location for new Public Toilet Facilities  
(Subject to separate planning application)
  - 'Wayfinding' paving
  - 'LED' in-ground strip lighting
  - Extents of Planning Application

P02	Planning Issue	RH	06.04.23
rev	amendments	check	date

**rps** Elmwood House T +44 (0) 28 90 667914  
74 Boucher Road F +44 (0) 28 90 668286  
Belfast W www.rpsgroup.com/ireland  
BT12 6RZ E ireland@rpsgroup.com

Client  
**Louth County Council**

Project  
**Carlingford PR Scheme**

Title  
**Public Realm Enhancements  
General Arrangement  
(Sheet 3 of 3)**

Project Number	Sheet Size	Drawing Scale
NI2391	A1	1:200@A1

Drawing Number  
**2391.1.06**

Drawn By	Status	Revision
WOD	Planning	P02

Checked By	Approved By	Date
RH	RH	03.05.22

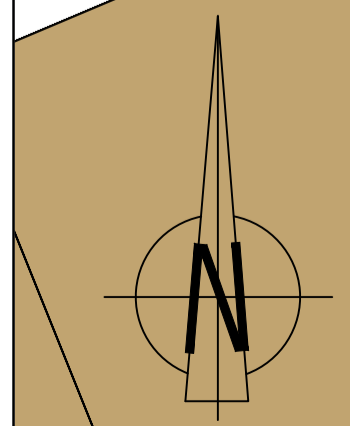
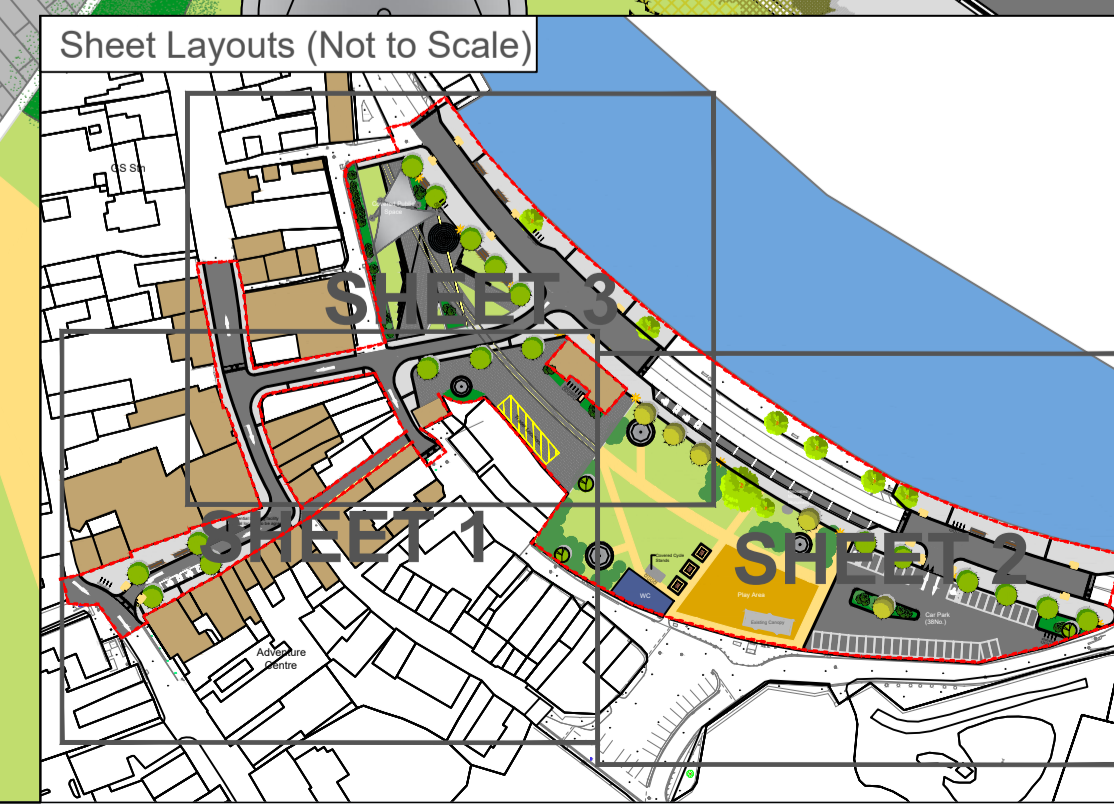

**A** Detail: New Asphalt Road Surfacing Scale 1:20

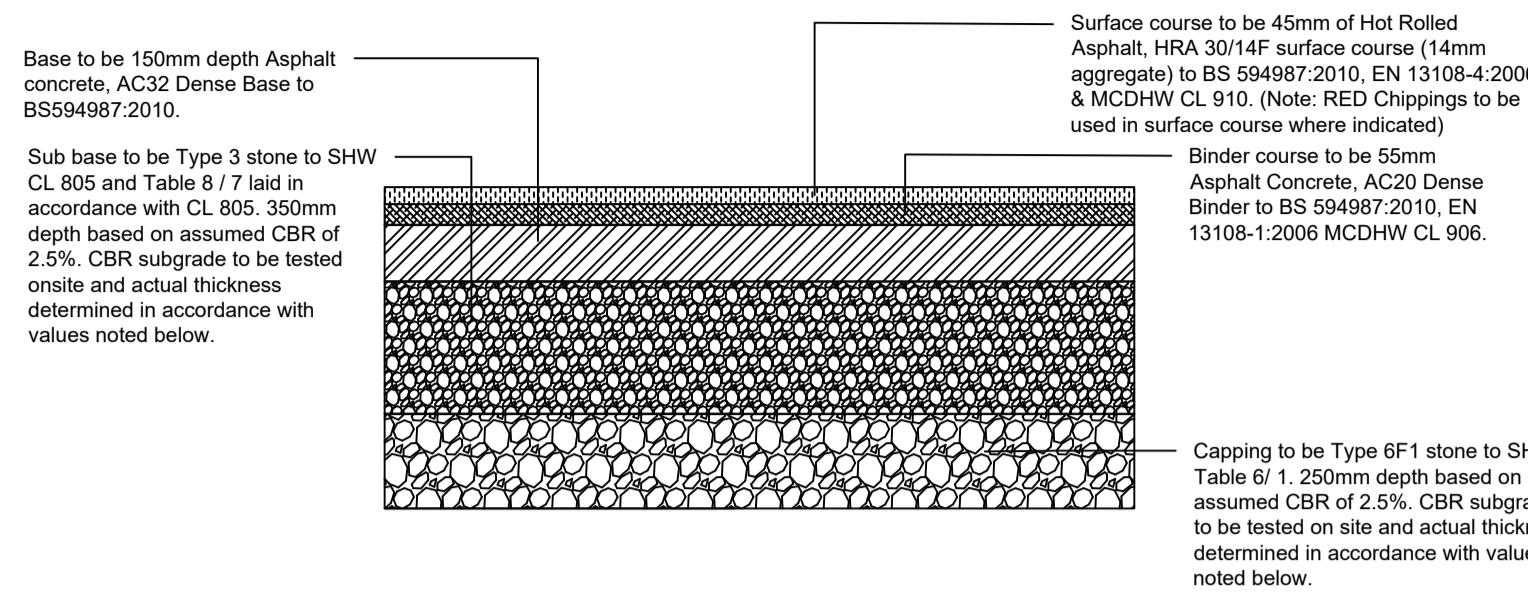

	350mm	320mm	300mm	270mm	250mm	240mm	180mm	150mm
Subbase	350mm	320mm	300mm	270mm	250mm	240mm	180mm	150mm
Capping	250mm	240mm	230mm	220mm	220mm	210mm	170mm	150mm
Subgrade	CBR 2.5%	CBR 3%	CBR 3.5%	CBR 4%	CBR 4.5%	CBR 5%	CBR 10%	CBR 15%

**B** Detail: Natural Stone Paving 'Setts' to Footways (To areas with anticipated low/medium levels of vehicle trafficking) Scale 1:20

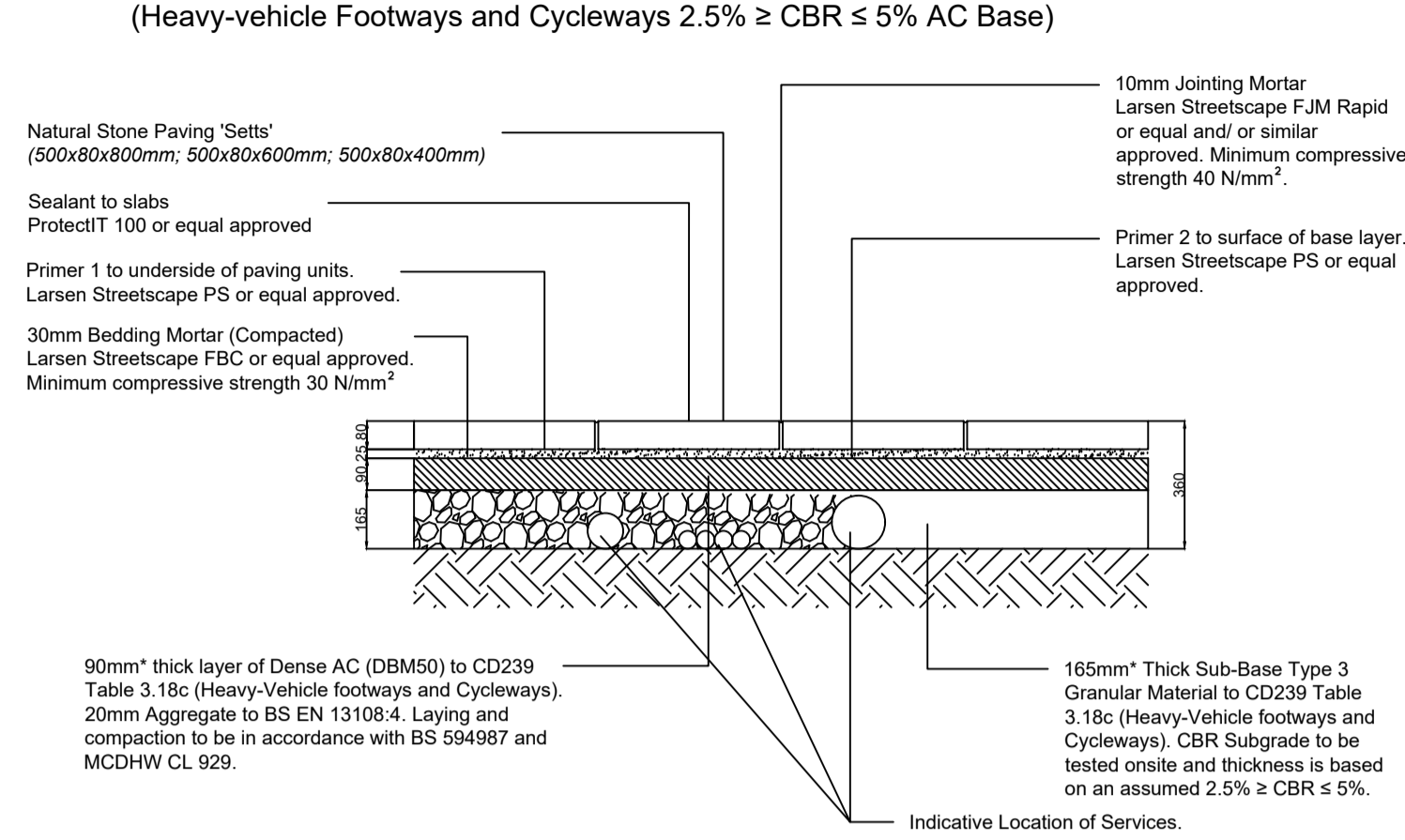

**C** Detail: Natural Stone Paving 'Setts' to main Trafficked Carriageways & Shared Surface Areas (To areas with anticipated high levels of vehicle trafficking) Scale 1:20

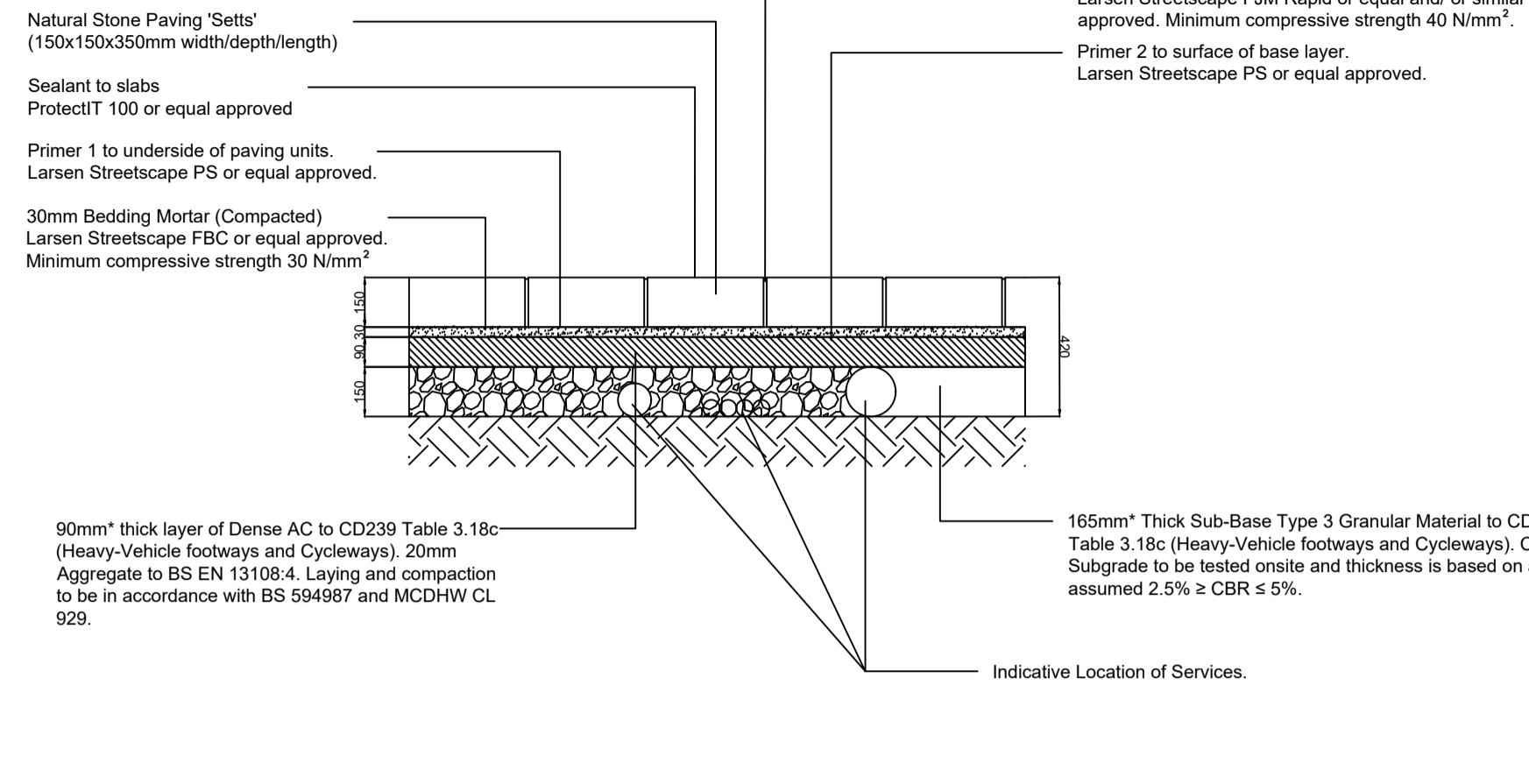

**D** Detail: Natural Stone Paving 'Setts' to Shared Surface Areas (To areas with anticipated higher levels of vehicle trafficking) Scale 1:20

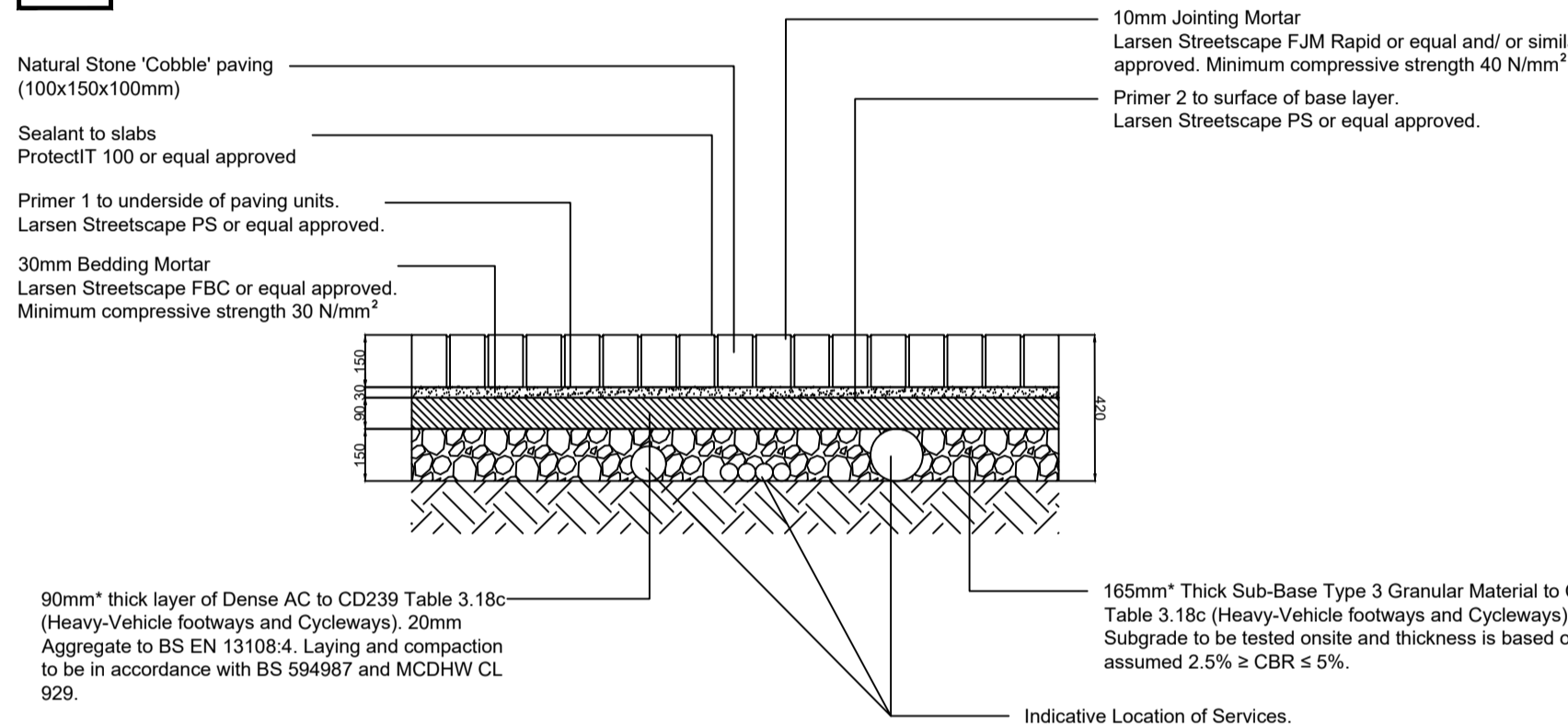

**E** Detail: Natural Stone Paving 'Setts' to Shared Surface Areas (To areas with anticipated higher levels of vehicle trafficking) Scale 1:20

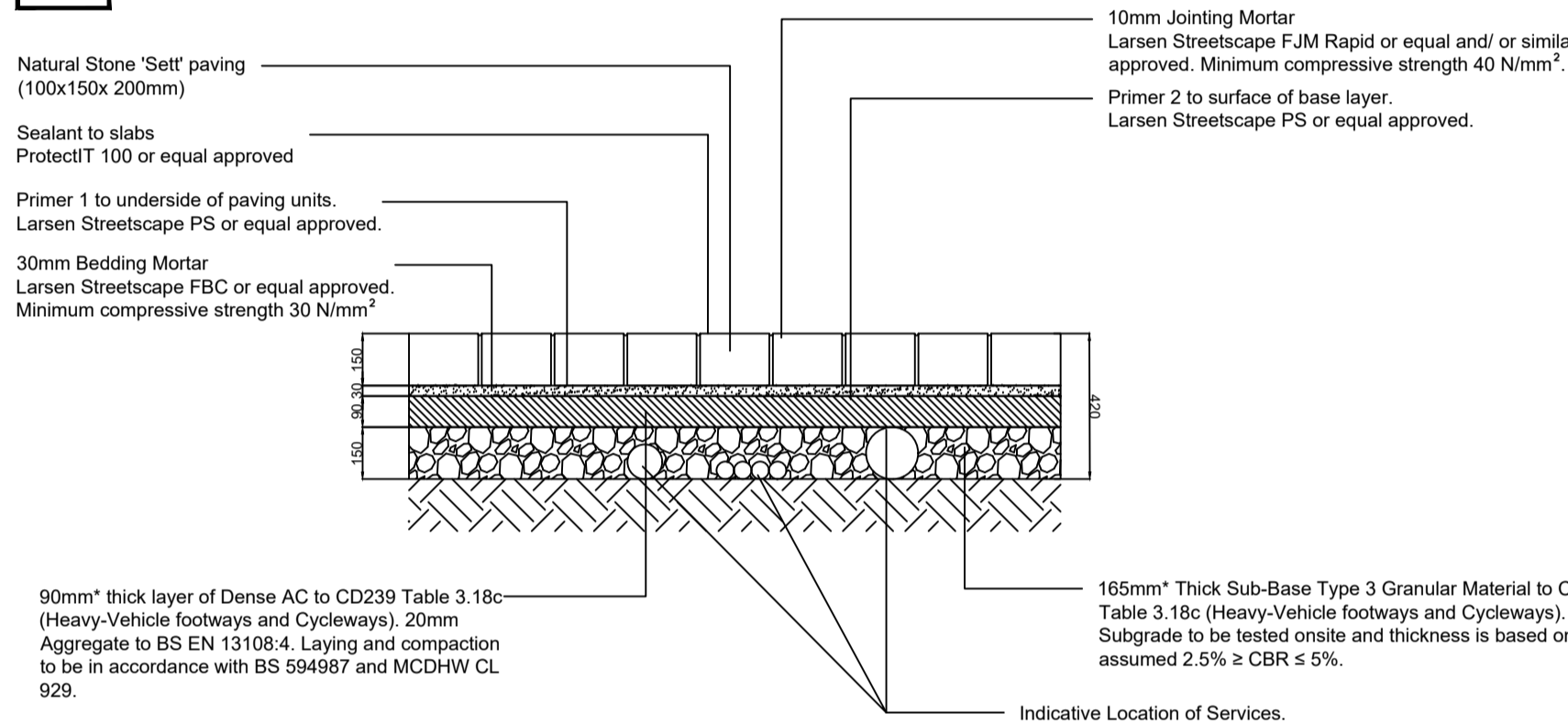

**F** Detail: Natural Stone 'Trim' Unit to All Areas Scale 1:20

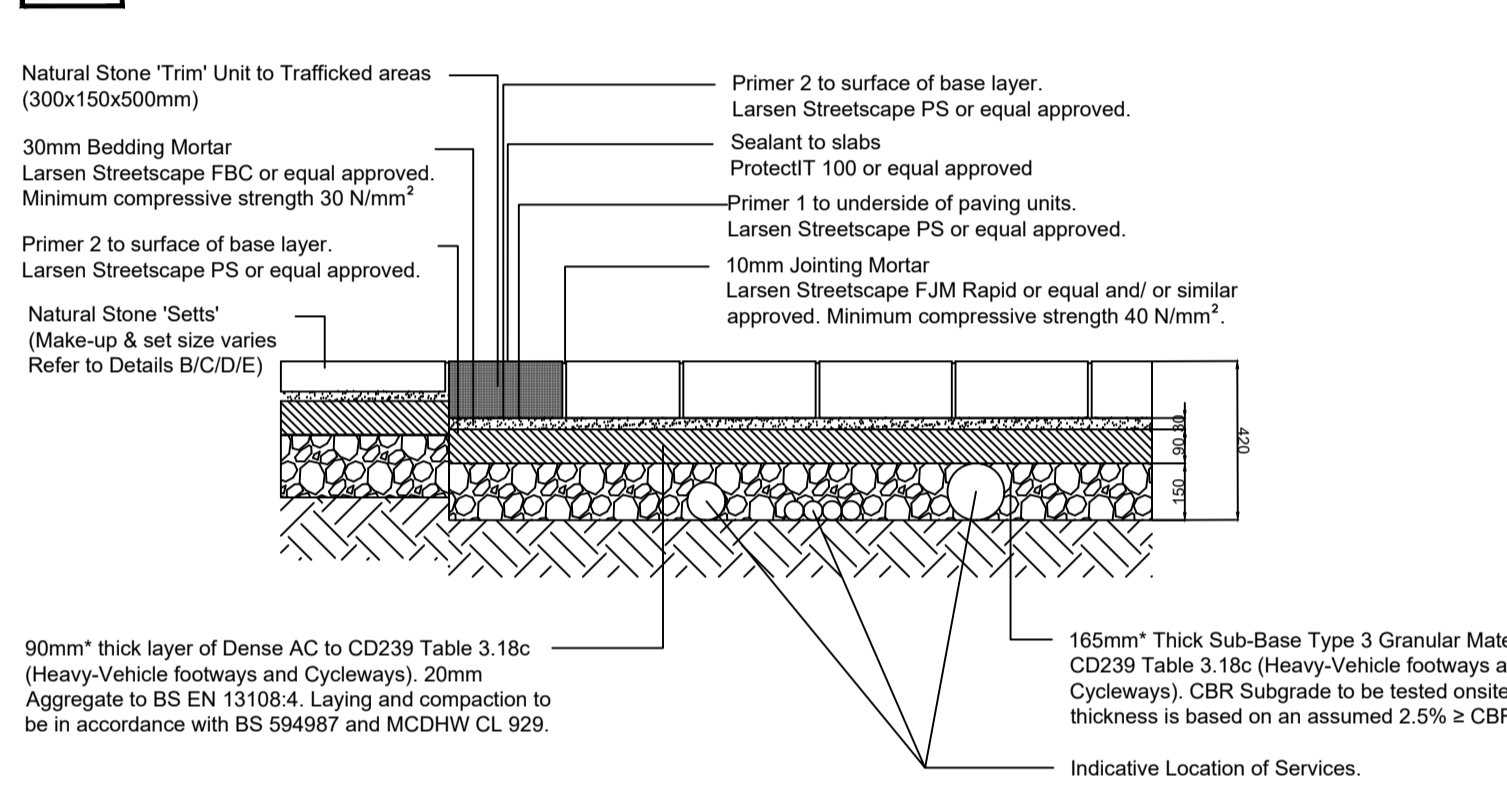

**G** Detail: Tactile Paving Detail with Natural Stone 'Flush' Kerbs (Granite) Scale 1:20

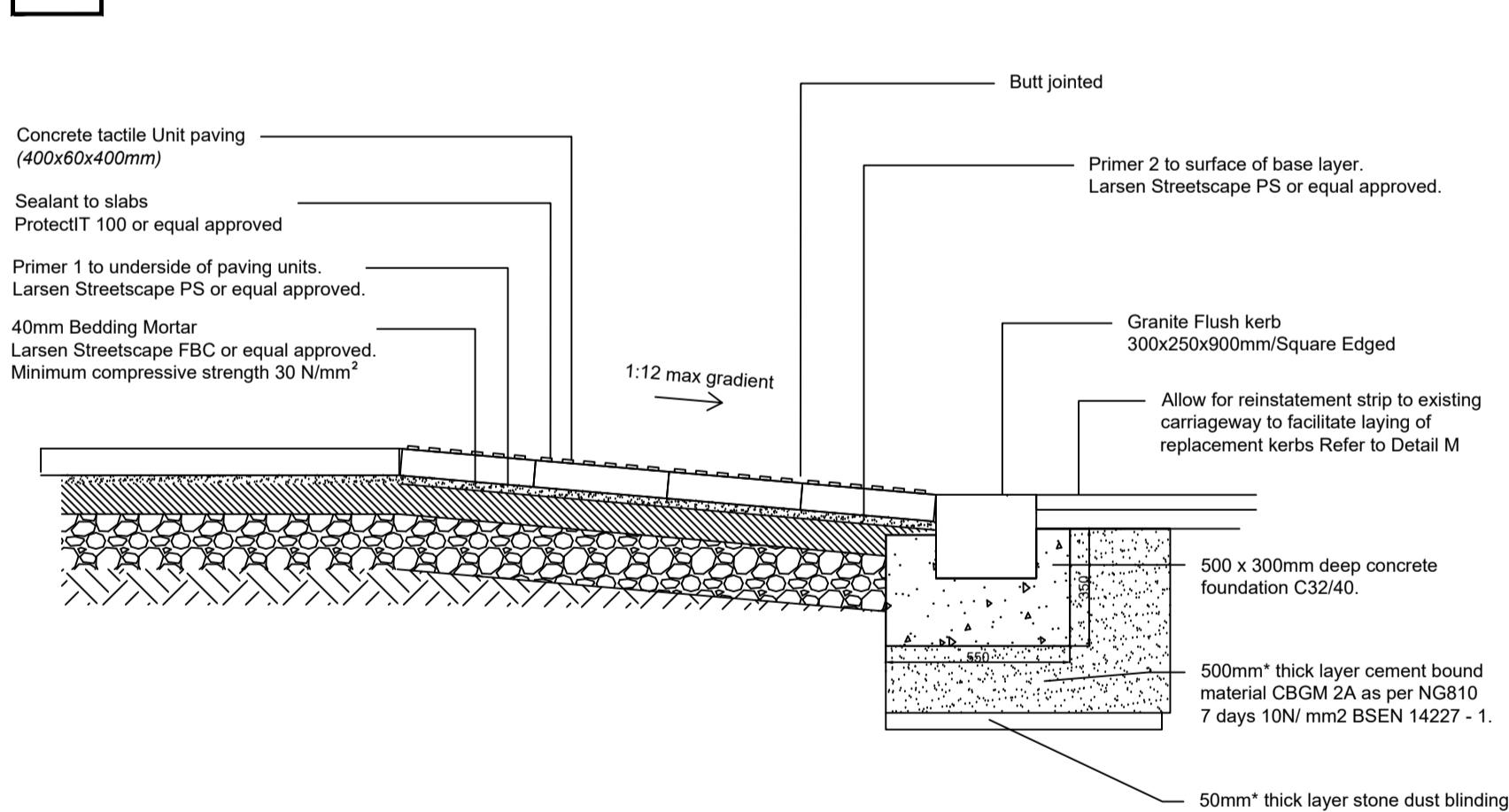

**H** Detail: Tactile Paving Unit Detail Scale 1:20

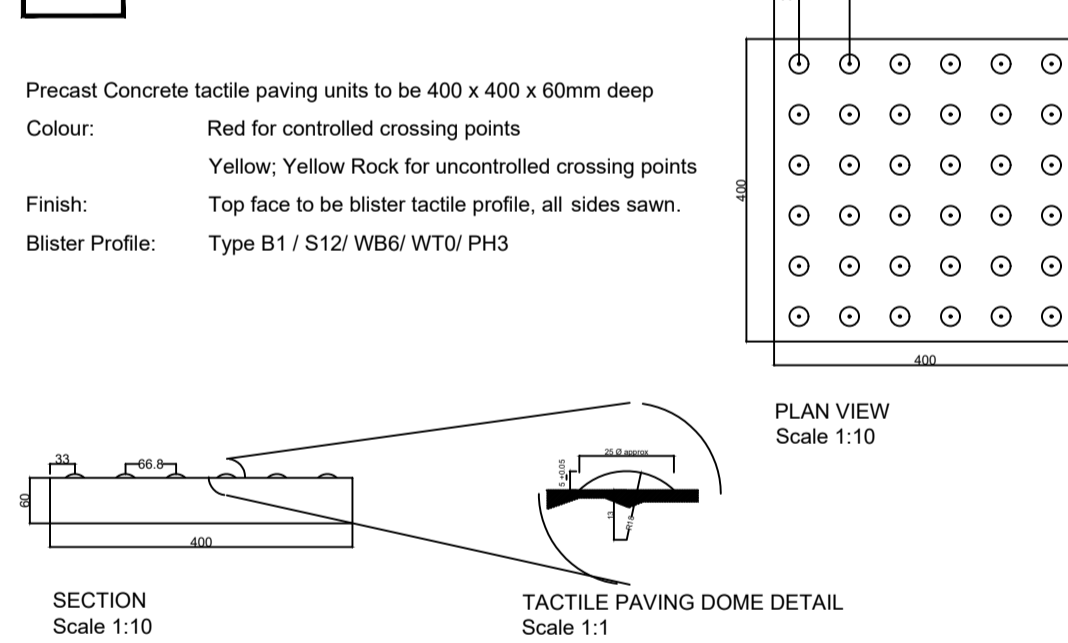

**J** Detail: Natural Stone Dish Drainage Channel (Granite) Plan View Scale 1:20

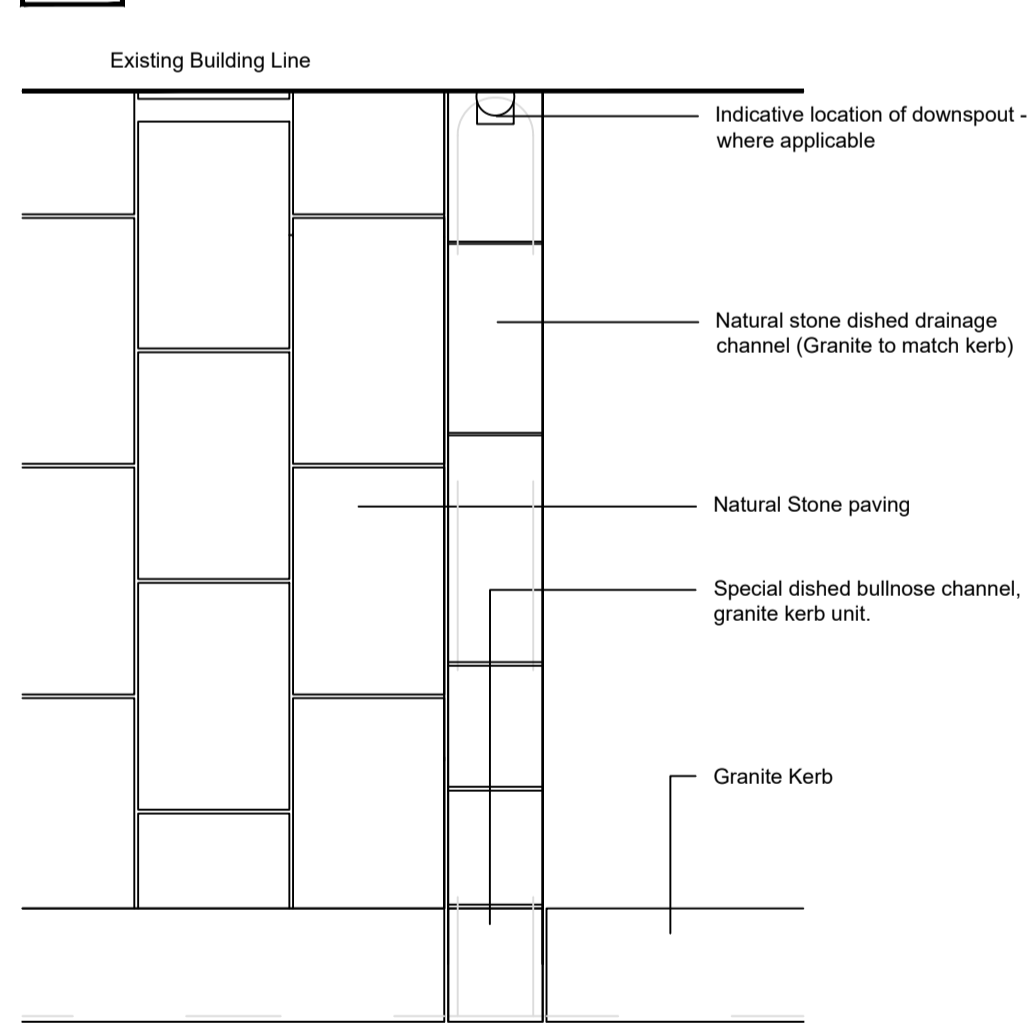

**K** Detail: Natural Stone Dish Drainage Channel (Granite)- Section View Scale 1:10

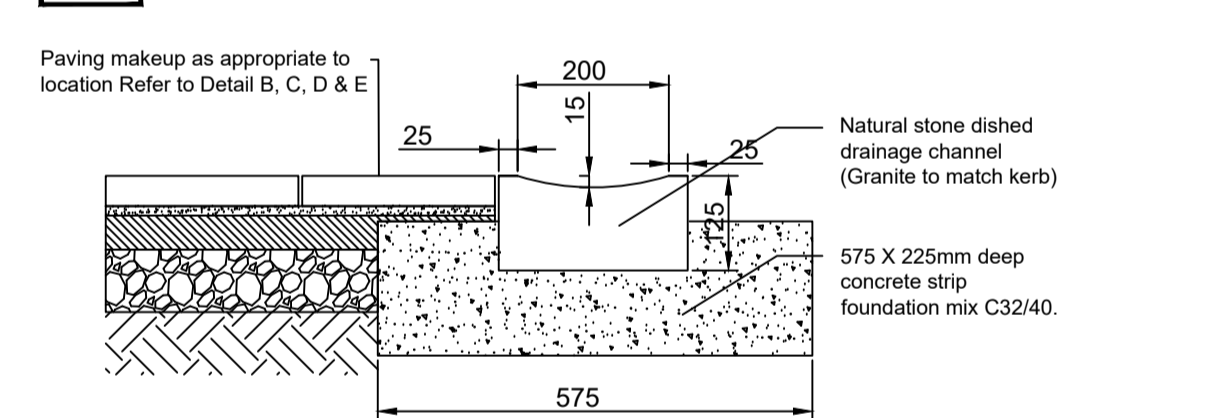

**L** Detail: Natural Stone 'Trim' Unit utilised as Drainage Channel Scale 1:10

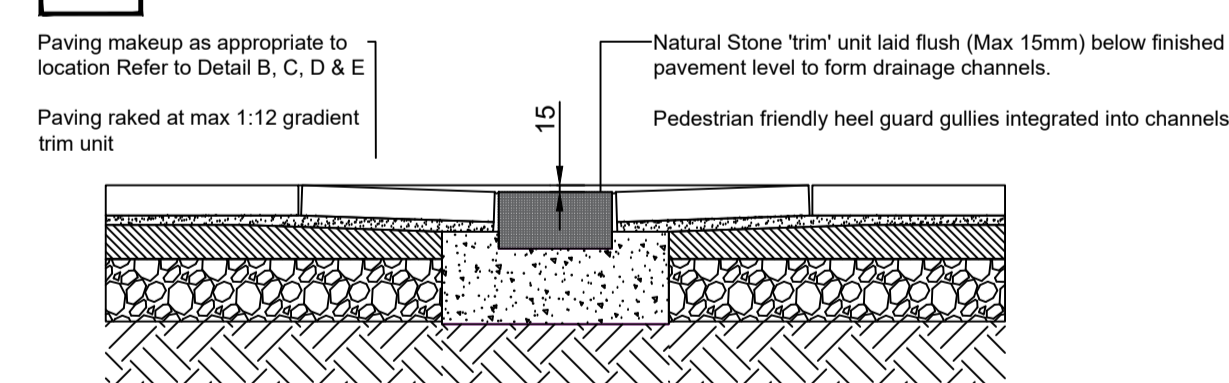

**M** Detail: Natural Stone 'High' Kerb (Granite) Scale 1:20

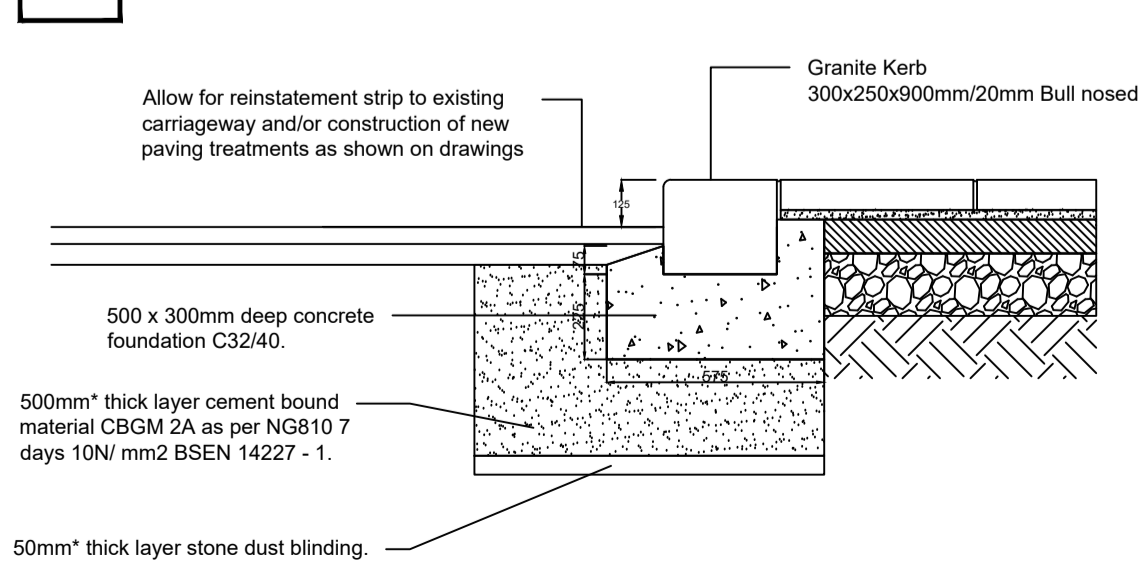

**N** Detail: Natural Stone 'Mid' Kerb (Granite) Scale 1:20

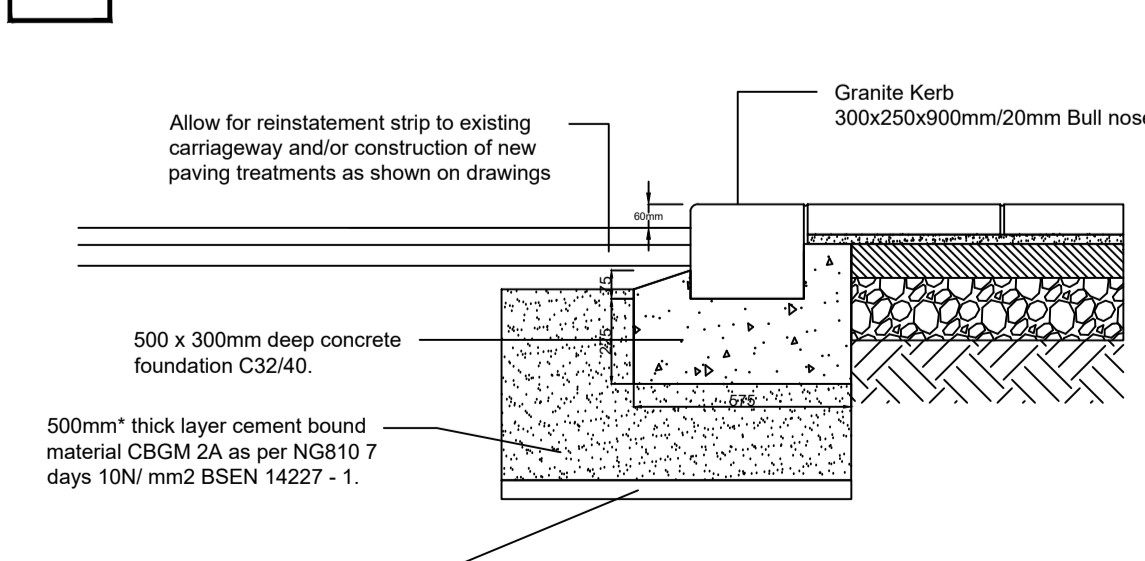

**O** Detail: Natural Stone 'Flush' Kerb laid '25mm' at Vehicular entries where drainage is required (Granite) Scale 1:20

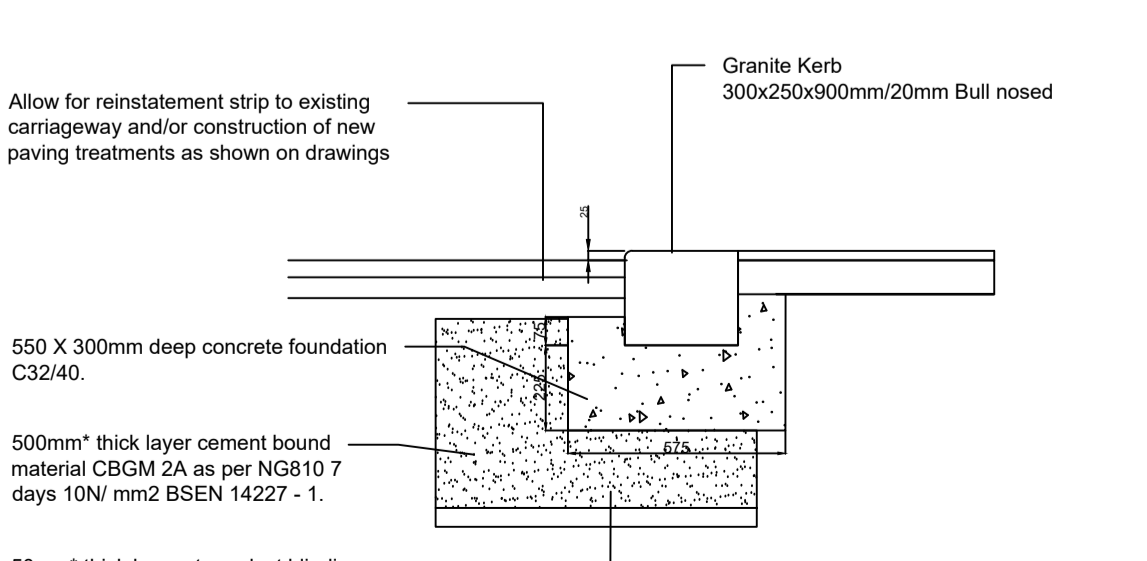

**P** Detail: Natural Stone 'Flush' Kerb laid '6mm' at Pedestrian crossings where drainage is required (Granite) Scale 1:20

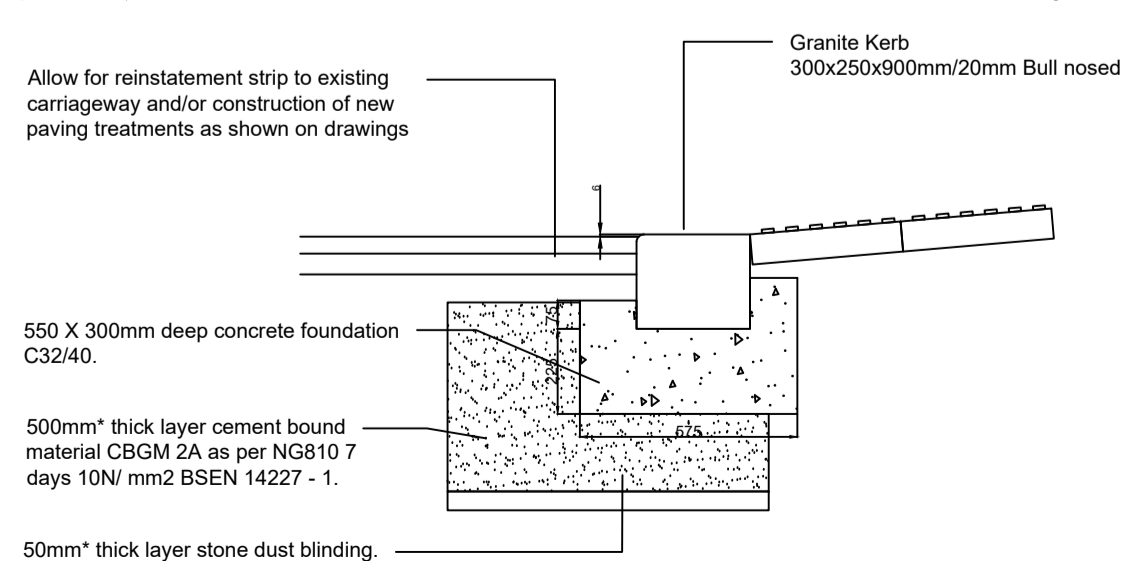

**NOTES**

1. Verifying Dimensions. Dimensions should be verified against such other drawings or site conditions as pertain to this scheme proposal.
2. Issue of Drawings. Hard copies pdf form a controlled issue of the drawing - For Planning Only.

rev	amendments	check	date

**rps** Elmwood House  
74 Boucher Road  
Belfast  
BT12 6RZ

T +44 (0) 28 90 667914  
F +44 (0) 28 90 668286  
W www.rpsgroup.com/ireland  
E ireland@rpsgroup.com

Client  
**Louth County Council**

Project  
**Carlingford PR Scheme**

Title  
**Public Realm Enhancement  
Typical details  
(Sheet 1 of 2)**

Project Number NI2391	Sheet Size A1	Drawing Scale 1:20
--------------------------	------------------	-----------------------

Drawing Number  
**2391.4.01**

Drawn By WOD	Status Planning	Revision <b>P01</b>
-----------------	--------------------	------------------------

Checked By RH	Approved By RH	Date 10.03.23
------------------	-------------------	------------------

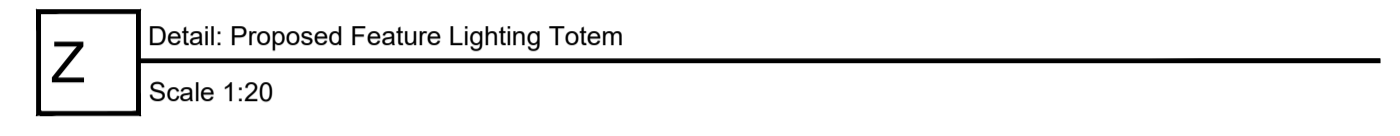
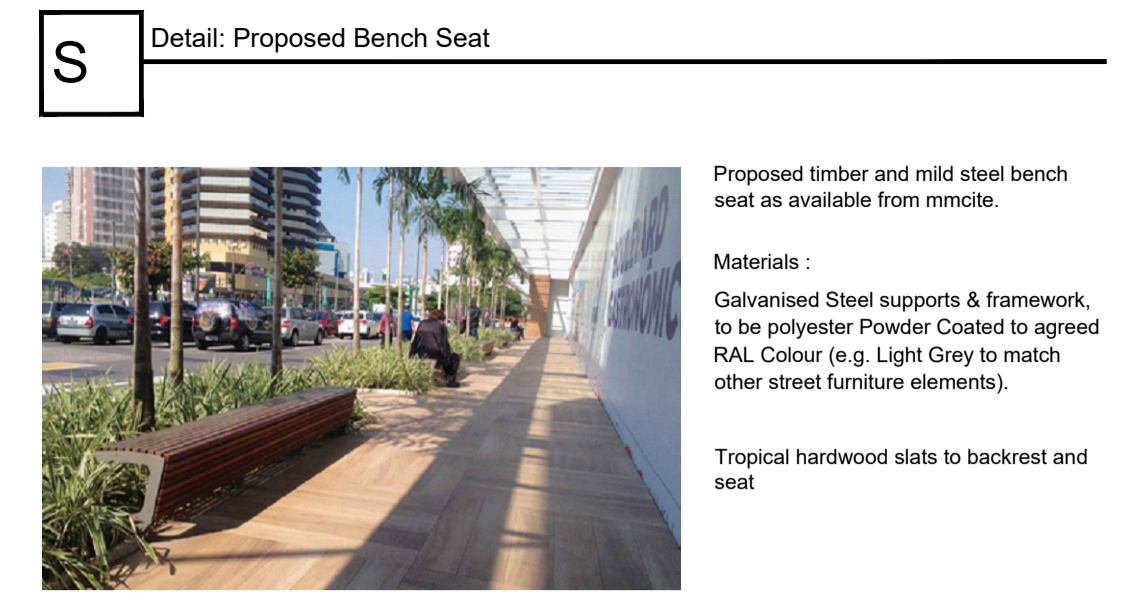
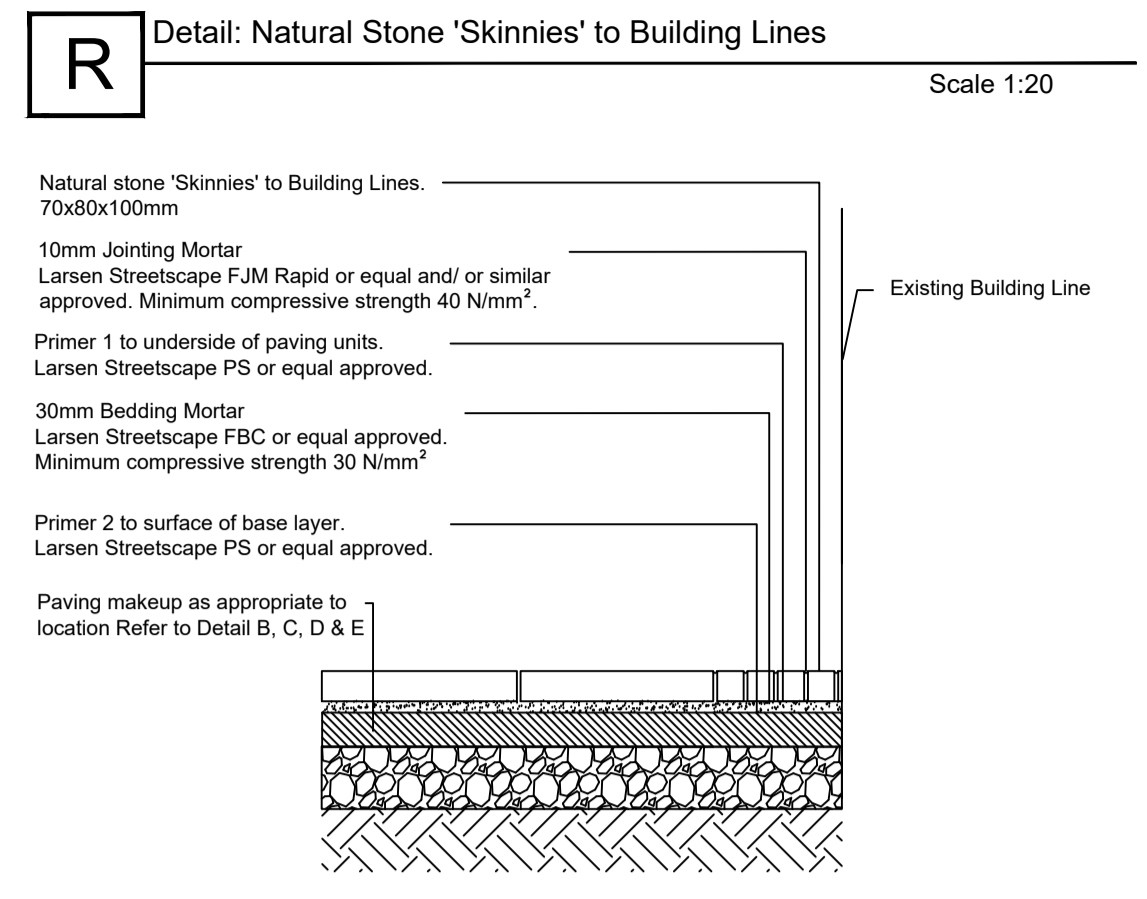
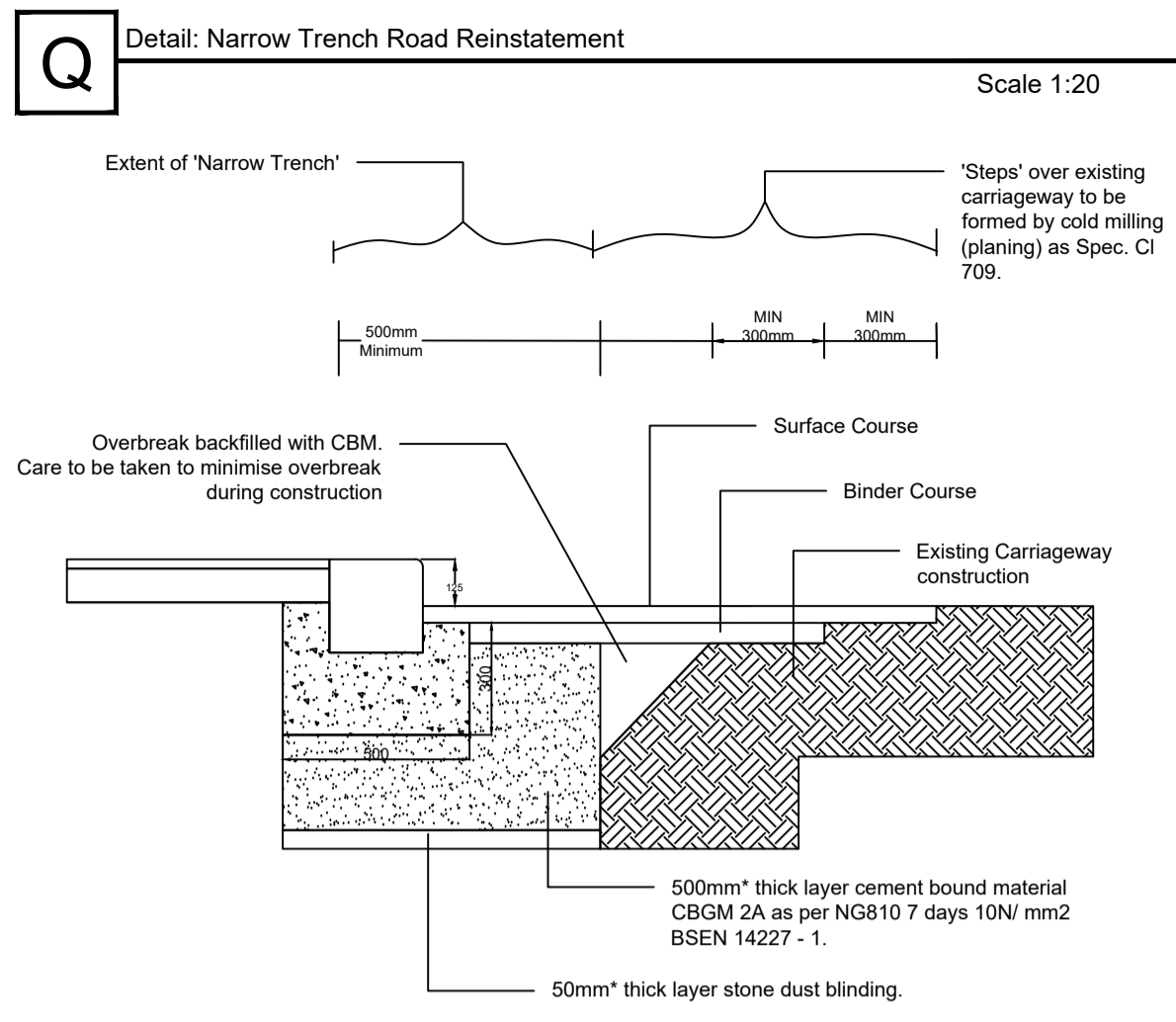

**Notes**

- Tack coats as MCDHW CL 920 to be applied to upper surfaces of planed carriageway prior to laying of new binder and surface courses.
- \* Denotes compacted thickness

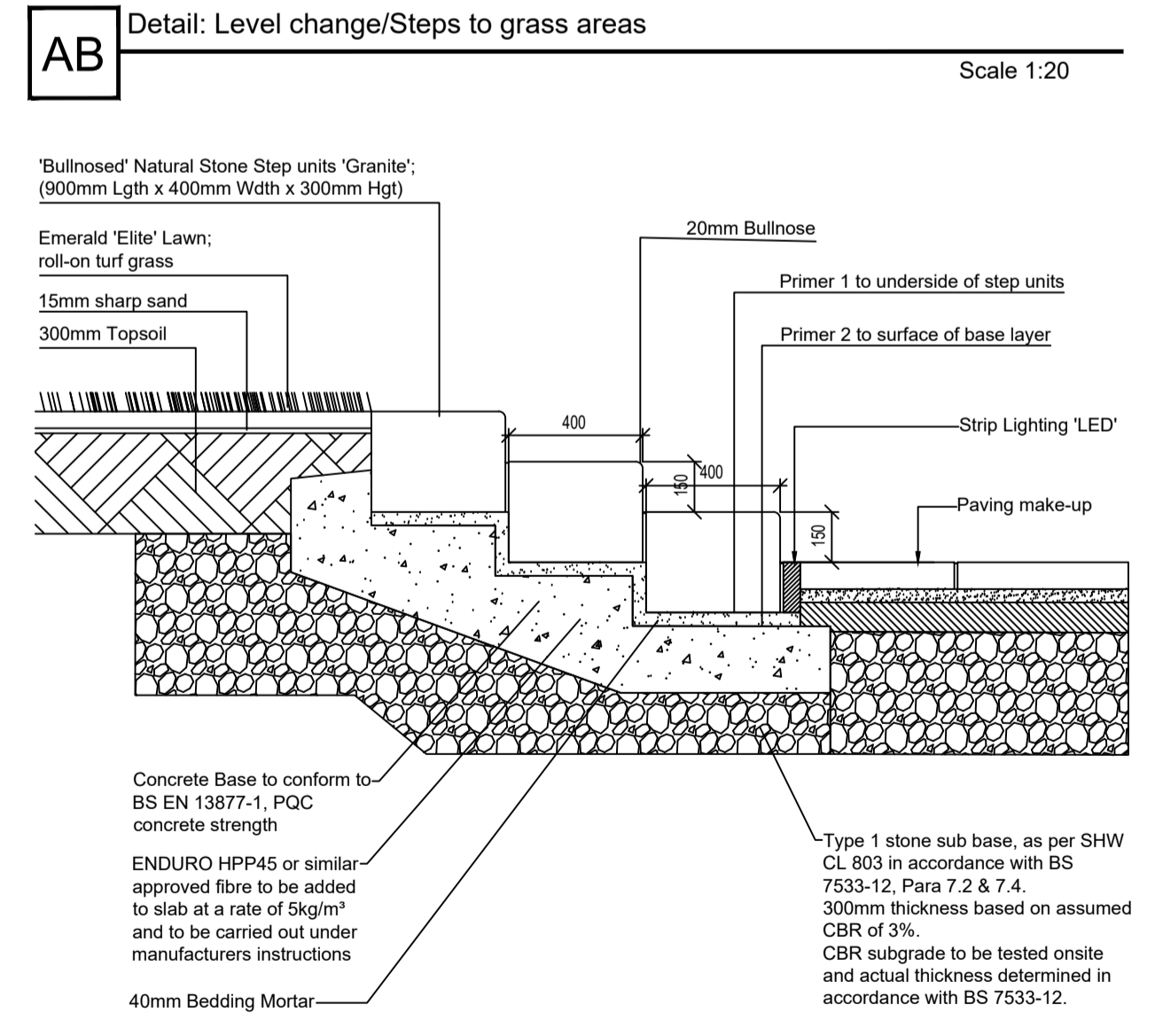
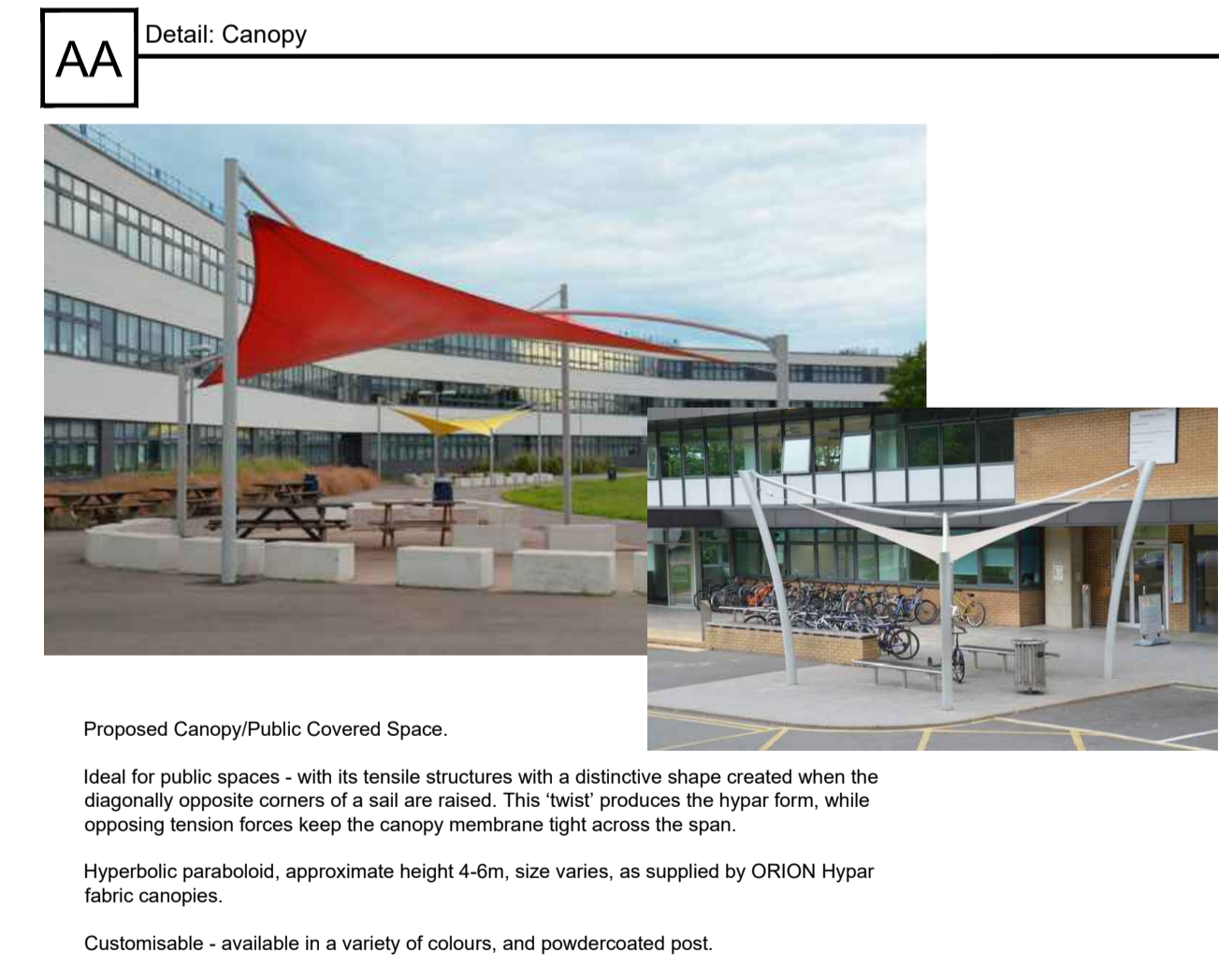
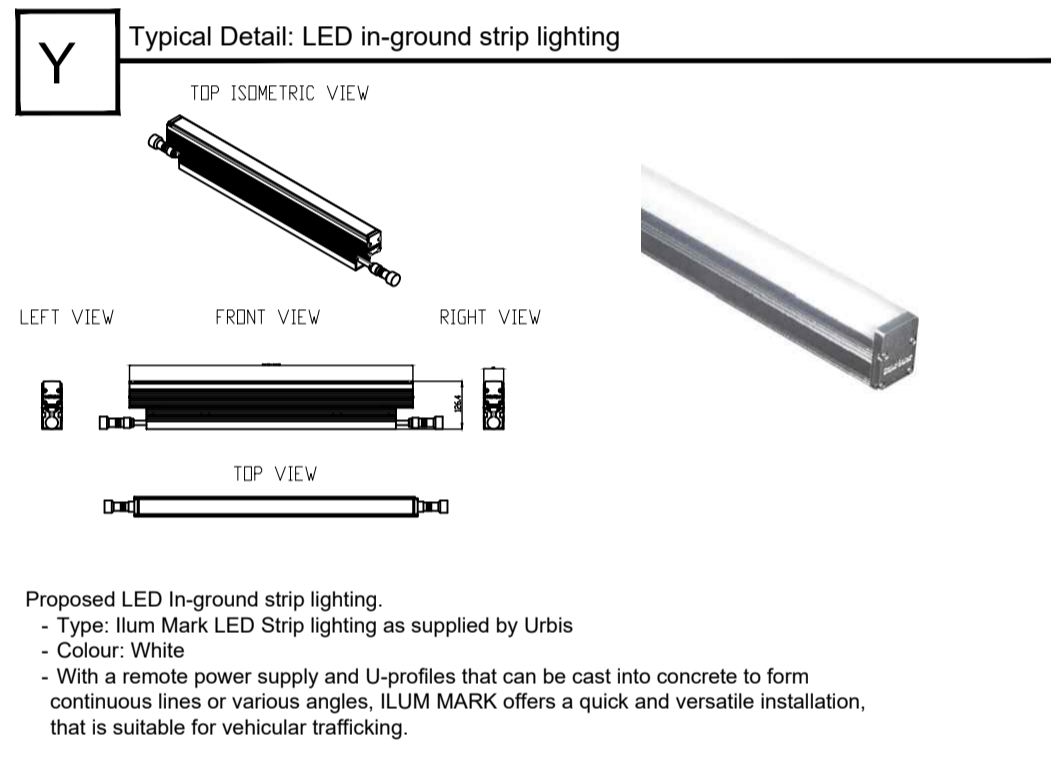
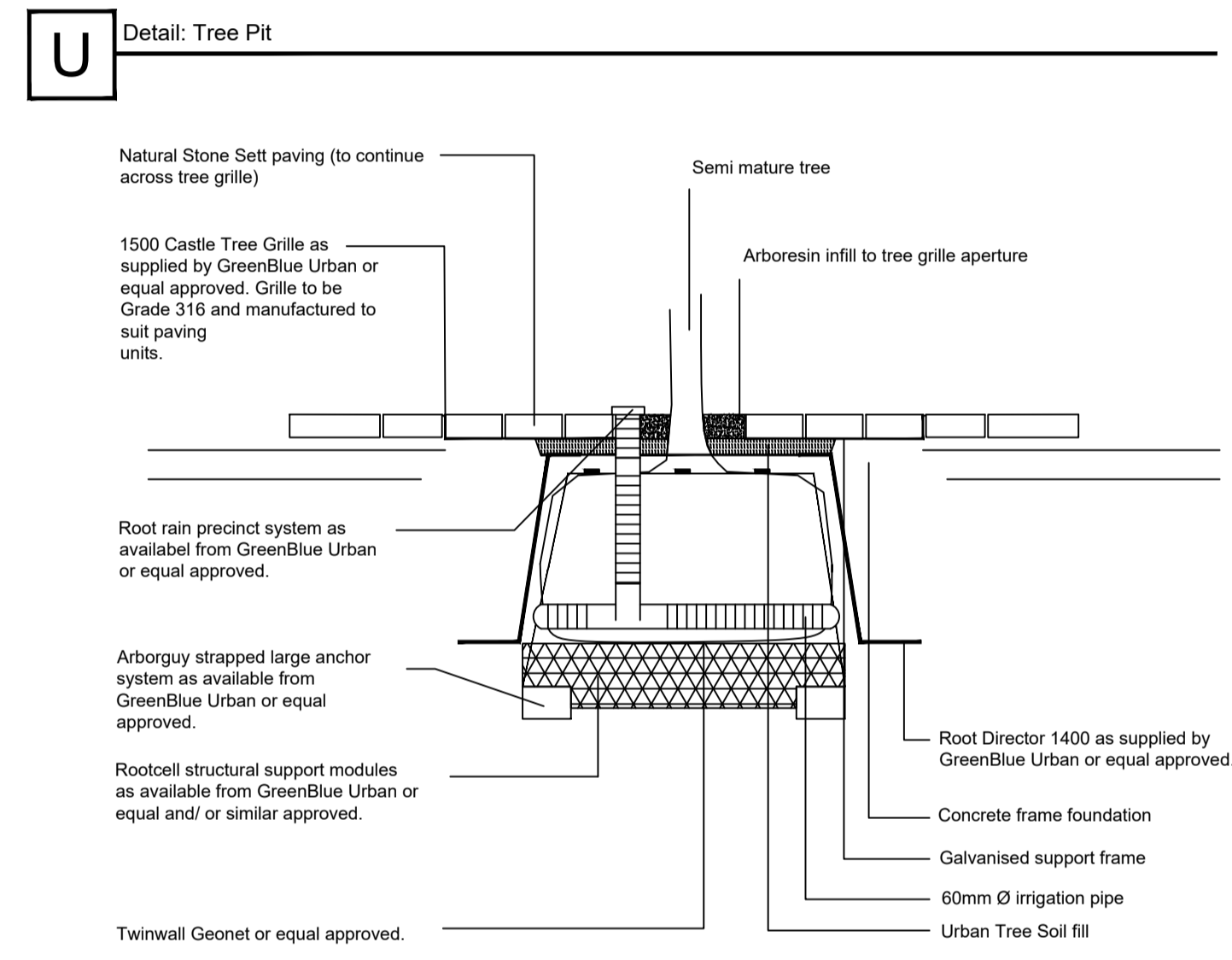

#### PLANTING SCHEDULE

Table 1: Amenity Grass Seeding	Sowing Rate
Grass for open areas (Coburns Irish Premier Heavywear as supplied by Coburns or similar approved)	Sowing rate 35-50g/m <sup>2</sup>
30% Dwarf Perennial Ryegrass	
20% Dwarf Perennial Ryegrass	
50% Strong Creeping Red Fescue	12.5Kg (20 bags/Ha @ 25/gm <sup>2</sup> )

#### Table 2: Proposed Trees

Common Name	Botanical Name	Transplanted/ Pot Size	Spacing
Norway Maple	Acer platanoides	Standard (Semi-mature); 4x transplanted, 30-35cm girth, min 450cm height, min 200cm clear stem height, RB	Planting as shown
Lime	Tilia cordata 'Green Spire'	Standard (Semi-mature); 4x transplanted, 25-30cm girth, min 450cm height, min 200cm clear stem height, RB	Planting as shown

#### Table 3: Proposed Ornamental shrub planting

Plant Species	Container	Overall Height	Habit/Breaks	Spacing	Mix (%)
Mahonia eurybracteata subsp. Garinensis 'Soft Caress'	5Lt Pot	40-60cm	branched, min 4 breaks	As shown	50
Viburnum opulus 'Compactum'	5Lt Pot	40-60cm	branched, min 4 breaks	As shown	50

#### Table 4: Proposed shrub planting

Plant Species	Container	Overall Height	Habit/Breaks	Planting Centres	Mix %
Hebe franciscana 'Blue Gem'	3Lt Pot	30-40cm	bushy, min 3 breaks	0.45m	20
Hebe pinguifolia	3Lt Pot	30-40cm	bushy, min 3 breaks	0.45m	20
Euonymus fortunei radicans	3Lt Pot	20-25cm	branched, min 3 breaks	0.45m	20
Cornus sanguinea	1 + 2 Trans	40-60cm	1+2 x transplanted, branched, min 2 breaks, BR	0.45m	10
Corylus avellana	1 + 2 Trans	40-60cm	1+2 x transplanted, branched, min 2 breaks, BR	0.45m	10
Viburnum opulus	1 + 2 Trans	60-80cm	1+2 x transplanted, branched, min 2 breaks, BR	1.0m	10
Sambucus nigra	1 + 1	60-80cm	1+1 x transplanted (whip), branched, min 2 breaks, BR	1.0m	5
Rosa Carina	1 + 2 Trans	60-80cm	1+2 x transplanted, branched, min 2 breaks, BR	1.0m	5

#### Table 5: Woodland Planting

Plant Species	Root Condition	Height (cm)	Form/Habit	Age	Nr. Times transplanted	Spacing	Mix (%)
Crataegus monogyna	Bare root	80 - 100	Transplant, Seed raised	1 + 1		1.5m	15
Ilex aquifolium	Root balled	125 - 150	Leader, laterals, furnished to base		3x transplanted	1.5m	15
Ligustrum vulgare	Bare root	125 - 150	Leader, laterals, furnished to base		3x transplanted	1.5m	10
Prunus spinosa	Bare root	80 - 100	Transplant, Seed raised	1 + 2		1.5m	10
Alnus glutinosa (Alder)	Bare root	min 350 - 425	Heavy Standard		2x transplanted	2.0m	25
Betula pendula (Birch)	Bare root	min 175 - 200	Feathered		2x transplanted	2.0m	25

#### NOTES

- Verifying Dimensions. Dimensions should be verified against such other drawings or site conditions as pertain to this scheme proposal.
- Issue of Drawings. Hard copies pdf form a controlled issue of the drawing - For Planning Only.

rev	amendments	check	date

**rps** Elmwood House  
74 Boucher Road  
Belfast  
BT12 6RZ

T +44 (0) 28 90 667914  
F +44 (0) 28 90 668286  
W www.rpsgroup.com/ireland  
E ireland@rpsgroup.com

Client  
**Louth County Council**

Project  
**Carlingford PR Scheme**

Title  
**Public Realm Enhancement  
Typical details  
(Sheet 2 of 2)**

Project Number NI2391	Sheet Size A1	Drawing Scale 1:20
--------------------------	------------------	-----------------------

Drawing Number  
**2391.4.01**

Drawn By WOD	Status Planning	Revision <b>P01</b>
-----------------	--------------------	------------------------

Checked By RH	Approved By RH	Date 10.03.23
------------------	-------------------	------------------

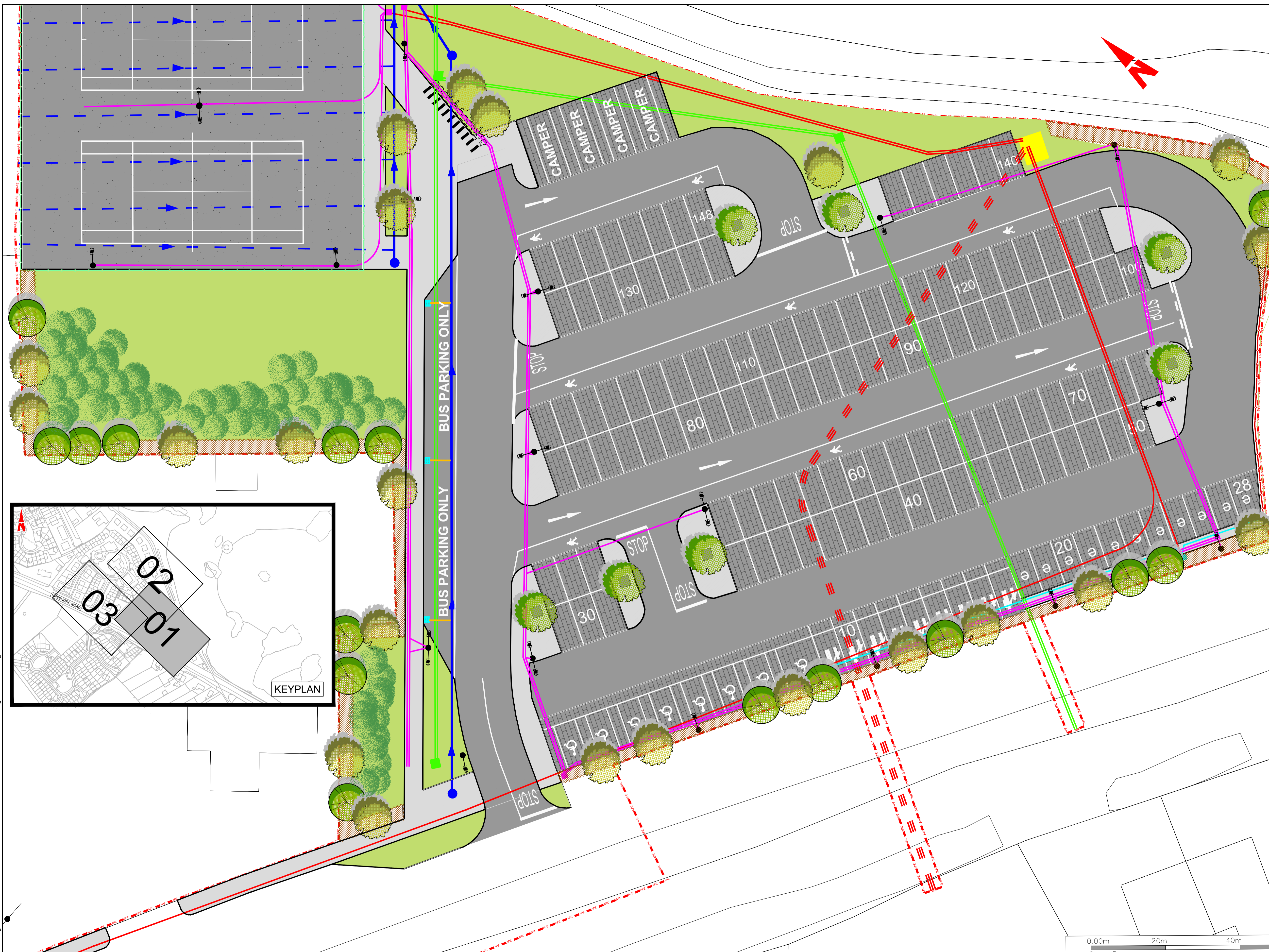

- LEGEND:**
- AREA PROVIDED BY THE EMPLOYER FOR THE WORKS
  - PROPOSED NEW PERMEABLE PAVING
  - PROPOSED NEW ASPHALT SURFACE
  - PROPOSED NEW POROUS ASPHALT TENNIS COURT SURFACE
  - PROPOSED STORM SEWER
  - PROPOSED STORM SEWER CHAMBER
  - PROPOSED FILTER DRAIN
  - PROPOSED GULLY
  - PROPOSED GULLY CONNECTOR PIPE
  - PROPOSED ESB DUCT TO PROPOSED SUBSTATION
  - PROPOSED ESB SUBSTATION AND KIOSK
  - PROPOSED ELECTRIC SERVICE DUCT
  - PROPOSED PUBLIC LIGHTING
  - PROPOSED PUBLIC LIGHTING DUCT
  - PROPOSED PUBLIC LIGHTING ELECTRIC MINI PILLAR
  - PROPOSED ELECTRIC CAR CHARGING DUCT
  - PROPOSED ELECTRIC CAR CHARGING MINI PILLAR
  - GRASSED AREA - REFER TO DG0009 FOR DETAILS
  - COTONEASTER SIMONSII HEDGEROW
  - PROPOSED KERB
  - PROPOSED CONCRETE SURFACE
  - PROPOSED EIR DUCTING
  - PROPOSED EIR CHAMBER
  - PROPOSED CYCLE RACK
  - PROPOSED TENNIS COURT FENCING
  - PROPOSED TIMBER FENCING
  - REFER TO DG0009 FOR TYPICAL DETAILS
  - TACTILE PAVING TO BE PROVIDED AT ALL PEDESTRIAN CROSSING POINTS
  - PROPOSED 'SEMI-MATURE' TREE PLANTING: ACER CAMPESTRE, STANDARD (SEMI MATURE) REFER TO DRAWING NO. 2391.4.02; PLANTING SCHEDULE TABLE 02
  - PROPOSED 'STREET TREE' PLANTING IN PAVED TREE PIT: TILIA CORDATA 'GREEN SPIRE', STANDARD (SEMI MATURE) REFER TO DRAWING NO. 2391.4.02; PLANTING SCHEDULE TABLE 02
  - PROPOSED 'SEMI-MATURE' TREE PLANTING: PINUS SYLVESTRIS, STANDARD (SEMI MATURE) REFER TO DRAWING NO. 2391.4.02; PLANTING SCHEDULE TABLE 02
  - PROPOSED WOODLAND PLANTING REFER TO DRAWING NO. 2391.4.02; PLANTING SCHEDULE TABLE 05
  - PROPOSED SPECIES RICH NATIVE HEDGEROW PLANTING REFER TO DRAWING NO. 2391.4.02; PLANTING SCHEDULE TABLE 06
  - PROPOSED OPEN GRASS AREAS REFER TO DRAWING NO. 2391.4.02; PLANTING SCHEDULE TABLE 01

**Client**

An Roinn Forbartha Tuaithe agus Pobail  
Department of Rural and Community Development

Rialtas na hÉireann  
Government of Ireland

Tionscadal Éireann  
Project Ireland  
2040

An Ciste um Athghiniúint agus Forbairt Tuaithe  
Rural Regeneration and Development Fund

Comhairle Contae Lú  
Louth County Council

Ar dtíodhach Tuaithe  
Our Rural Future

**General Notes**

(i) Hard copies, dxf and pdf will form a controlled issue of the drawing. All other formats (dwg etc.) are deemed to be an uncontrolled issue and any work carried out based on these files is at the recipient's own risk. RPS will not accept any responsibility for any errors from the use of these files, either by human error by the recipient, listing of the un-dimensioned measurements, compatibility with the recipient's software, and any errors arising when these files are used to aid the recipient's drawing production, or setting out on site.

(ii) DO NOT SCALE, use figured dimensions only.

(iii) This drawing is the property of RPS, it is a project confidential classified document. It must not be copied used or its contents divulged without prior written consent. The needs and expectations of client and RPS must be considered when working with this drawing.

(iv) Information including topographical survey, geotechnical investigation and utility detail used in the design have been provided by others.

(v) All Levels refer to Ordnance Survey Datum, Malin Head.

Rev	Date	Dim Chk	Amendment / Issue	App
P04	05.04.23	Mf	FOR PLANNING	DfE
P03	16.03.23	Mf	FOR PLANNING	DfE
P02	15.03.23	Mf	FOR PLANNING	DfE
P01	08.03.23	Mf	FOR PLANNING	DfE

**rps**

Model File Identifier  
MGT0610-DG0006

Scale  
1:200 @ A1  
1:400 @ A3

Created on  
NOV. 2022

Sheets  
01 of 03

Project  
LIVING IN CARLINGFORD  
VISITING CARLINGFORD RRDF

Title  
SOUTHERN CAR PARK  
AND TENNIS COURTS  
GENERAL ARRANGEMENT

File Identifier  
MGT0610-DG0006

Status  
S2

Rev  
P04

T:\MGT0610 - Carlingford RRDF\0 - Drawings\DG\MGT0610-RPS-00-XX-W2-C-DG0006 Southern Car Park General Arrangement D02.dwg



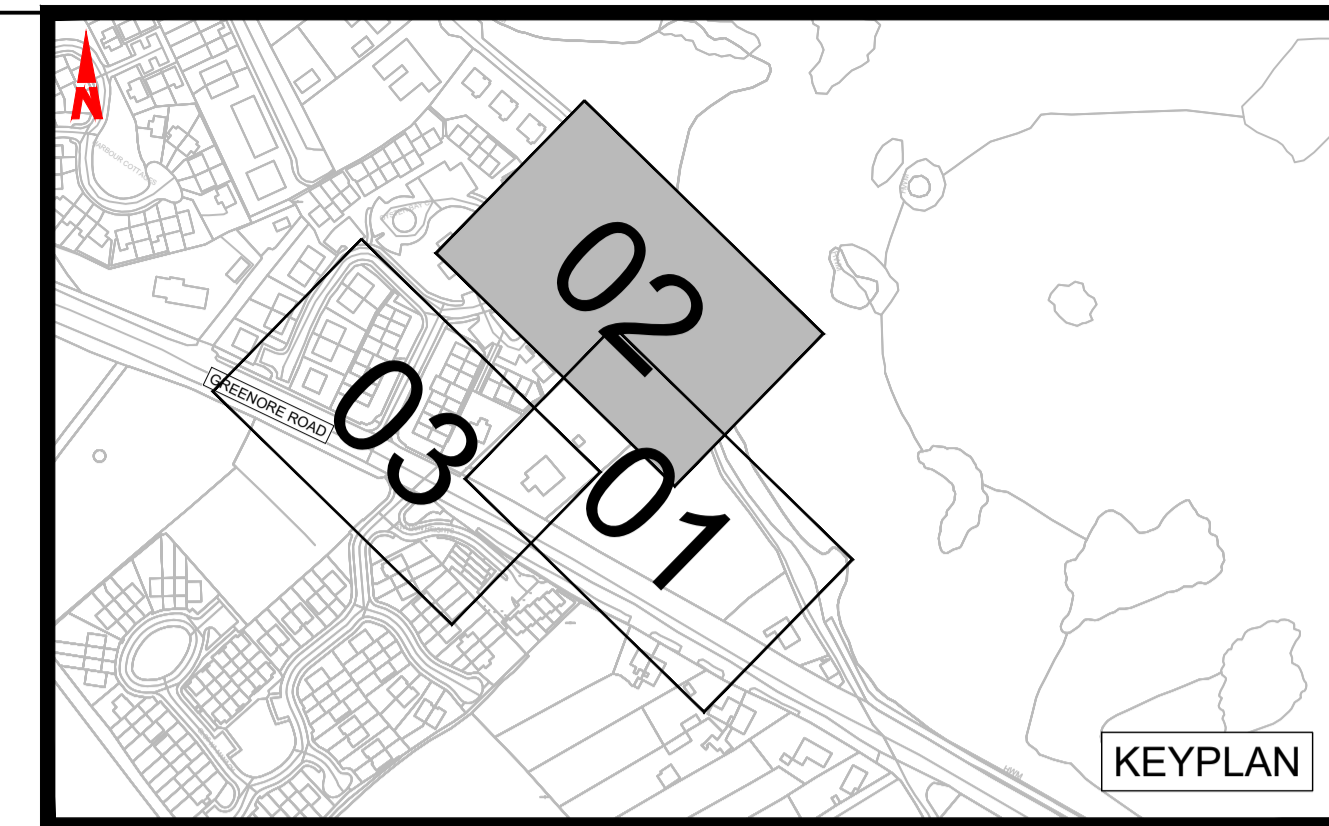

**LEGEND:**

AREA PROVIDED BY THE EMPLOYER FOR THE WORKS	
PROPOSED NEW PERMEABLE PAVING	
PROPOSED NEW ASPHALT SURFACE	
PROPOSED NEW POROUS ASPHALT TENNIS COURT SURFACE	
PROPOSED STORM SEWER	
PROPOSED STORM SEWER CHAMBER	
PROPOSED FILTER DRAIN	
PROPOSED GULLY	
PROPOSED GULLY CONNECTOR PIPE	
PROPOSED ESB DUCT TO PROPOSED SUBSTATION	
PROPOSED ESB SUBSTATION AND KIOSK	
PROPOSED ELECTRIC SERVICE DUCT	
PROPOSED PUBLIC LIGHTING	
PROPOSED PUBLIC LIGHTING DUCT	
PROPOSED PUBLIC LIGHTING ELECTRIC MINI PILLAR	
PROPOSED ELECTRIC CAR CHARGING DUCT	
PROPOSED ELECTRIC CAR CHARGING MINI PILLAR	
GRASSED AREA - REFER TO DG0009 FOR DETAILS	
COTONEASTER SIMONSII HEDGEROW	
PROPOSED KERB	
PROPOSED CONCRETE SURFACE	
PROPOSED EIR DUCTING	
PROPOSED EIR CHAMBER	
PROPOSED CYCLE RACK	
PROPOSED TENNIS COURT FENCING	
PROPOSED TIMBER FENCING	
- REFER TO DG0009 FOR TYPICAL DETAILS	
- TACTILE PAVING TO BE PROVIDED AT ALL PEDESTRIAN CROSSING POINTS	
PROPOSED 'SEMI-MATURE' TREE PLANTING: ACER CAMPESTRE, STANDARD (SEMI MATURE) REFER TO DRAWING NO. 2391.4.02; PLANTING SCHEDULE TABLE 02	
PROPOSED 'STREET TREE' PLANTING IN PAVED TREE PIT: TILIA CORDATA 'GREEN SPIRE', STANDARD (SEMI MATURE) REFER TO DRAWING NO. 2391.4.02; PLANTING SCHEDULE TABLE 02	
PROPOSED 'SEMI-MATURE' TREE PLANTING: PINUS SYLVESTRIS, STANDARD (SEMI MATURE) REFER TO DRAWING NO. 2391.4.02; PLANTING SCHEDULE TABLE 02	
PROPOSED WOODLAND PLANTING REFER TO DRAWING NO. 2391.4.02; PLANTING SCHEDULE TABLE 05	
PROPOSED SPECIES RICH NATIVE HEDGEROW PLANTING REFER TO DRAWING NO. 2391.4.02; PLANTING SCHEDULE TABLE 06	
PROPOSED OPEN GRASS AREAS REFER TO DRAWING NO. 2391.4.02; PLANTING SCHEDULE TABLE 01	

2no. PROPOSED TENNIS COURTS.

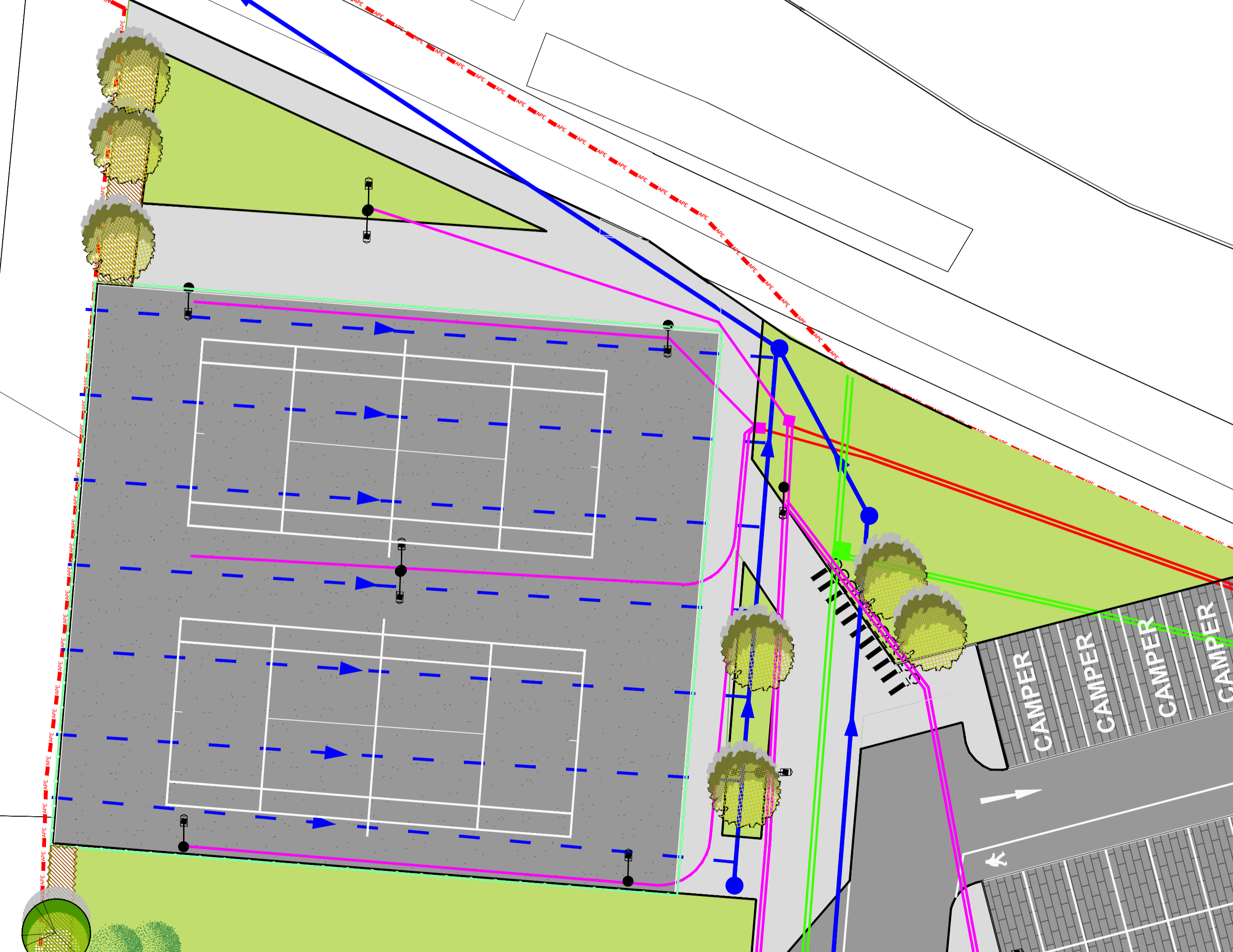

T:\MGT0610 - Carlingford RRDF\0 - Drawings\DG\MGT0610-RPS-00-XX-M2-C-DG0006 Southern Car Park General Arrangement D02.dwg

--

**General Notes**

(i) Hard copies, dxf and pdf will form a controlled issue of the drawing. All other formats (dwg etc.) are deemed to be an uncontrolled issue and any work carried out based on these files is at the recipients own risk. RPS will not accept any responsibility for any errors from the use of these files, either by human error by the recipient, listing of the un-dimensioned measurements, compatibility with the recipients software, and any errors arising when these files are used to aid the recipients drawing production, or setting out on site.

(ii) DO NOT SCALE, use figured dimensions only.

(iii) This drawing is the property of RPS, it is a project confidential classified document. It must not be copied used or its contents divulged without prior written consent. The needs and expectations of client and RPS must be considered when working with this drawing.

(iv) Information including topographical survey, geotechnical investigation and utility detail used in the design have been provided by others.

(v) All Levels refer to Ordnance Survey Datum, Malin Head.

Rev	Date	Drawn	Checked	Amendment / Issue	App
P04	05.04.23	Mk	Dmc	FOR PLANNING	Dmc
P03	16.03.23	Mk	Dmc	FOR PLANNING	Dmc
P02	15.03.23	Mk	Dmc	FOR PLANNING	Dmc
P01	08.03.23	Mk	Dmc	FOR PLANNING	Dmc

Scale	1:200 @ A1 1:400 @ A3	Project	LIVING IN CARLINGFORD VISITING CARLINGFORD RRDF
Created on	NOV. 2022	Title	SOUTHERN CAR PARK AND TENNIS COURTS GENERAL ARRANGEMENT
Sheets	02 of 03	File Identifier	MGT0610-DG0006
Status	S2	Rev	P04

- LEGEND:**
- AREA PROVIDED BY THE EMPLOYER FOR THE WORKS
  - PROPOSED NEW PERMEABLE PAVING
  - PROPOSED NEW ASPHALT SURFACE
  - PROPOSED NEW POROUS ASPHALT TENNIS COURT SURFACE
  - PROPOSED STORM SEWER
  - PROPOSED STORM SEWER CHAMBER
  - PROPOSED FILTER DRAIN
  - PROPOSED GULLY
  - PROPOSED GULLY CONNECTOR PIPE
  - PROPOSED ESB DUCT TO PROPOSED SUBSTATION
  - PROPOSED ESB SUBSTATION AND KIOSK
  - PROPOSED ELECTRIC SERVICE DUCT
  - PROPOSED PUBLIC LIGHTING
  - PROPOSED PUBLIC LIGHTING DUCT
  - PROPOSED PUBLIC LIGHTING ELECTRIC MINI PILLAR
  - PROPOSED ELECTRIC CAR CHARGING DUCT
  - PROPOSED ELECTRIC CAR CHARGING MINI PILLAR
  - GRASSED AREA - REFER TO DG0009 FOR DETAILS
  - COTONEASTER SIMONSII HEDGEROW
  - PROPOSED KERB
  - PROPOSED CONCRETE SURFACE
  - PROPOSED EIR DUCTING
  - PROPOSED EIR CHAMBER
  - PROPOSED CYCLE RACK
  - PROPOSED TENNIS COURT FENCING
  - PROPOSED TIMBER FENCING
  - REFER TO DG0009 FOR TYPICAL DETAILS
  - TACTILE PAVING TO BE PROVIDED AT ALL PEDESTRIAN CROSSING POINTS
  - PROPOSED 'SEMI-MATURE' TREE PLANTING: ACER CAMPESTRE, STANDARD (SEMI MATURE) REFER TO DRAWING NO. 2391.4.02; PLANTING SCHEDULE TABLE 02
  - PROPOSED 'STREET TREE' PLANTING IN PAVED TREE PIT: TILIA CORDATA 'GREEN SPIRE', STANDARD (SEMI MATURE) REFER TO DRAWING NO. 2391.4.02; PLANTING SCHEDULE TABLE 02
  - PROPOSED 'SEMI-MATURE' TREE PLANTING: PINUS SYLVESTRIS, STANDARD (SEMI MATURE) REFER TO DRAWING NO. 2391.4.02; PLANTING SCHEDULE TABLE 02
  - PROPOSED WOODLAND PLANTING REFER TO DRAWING NO. 2391.4.02; PLANTING SCHEDULE TABLE 05
  - PROPOSED SPECIES RICH NATIVE HEDGEROW PLANTING REFER TO DRAWING NO. 2391.4.02; PLANTING SCHEDULE TABLE 06
  - PROPOSED OPEN GRASS AREAS REFER TO DRAWING NO. 2391.4.02; PLANTING SCHEDULE TABLE 01

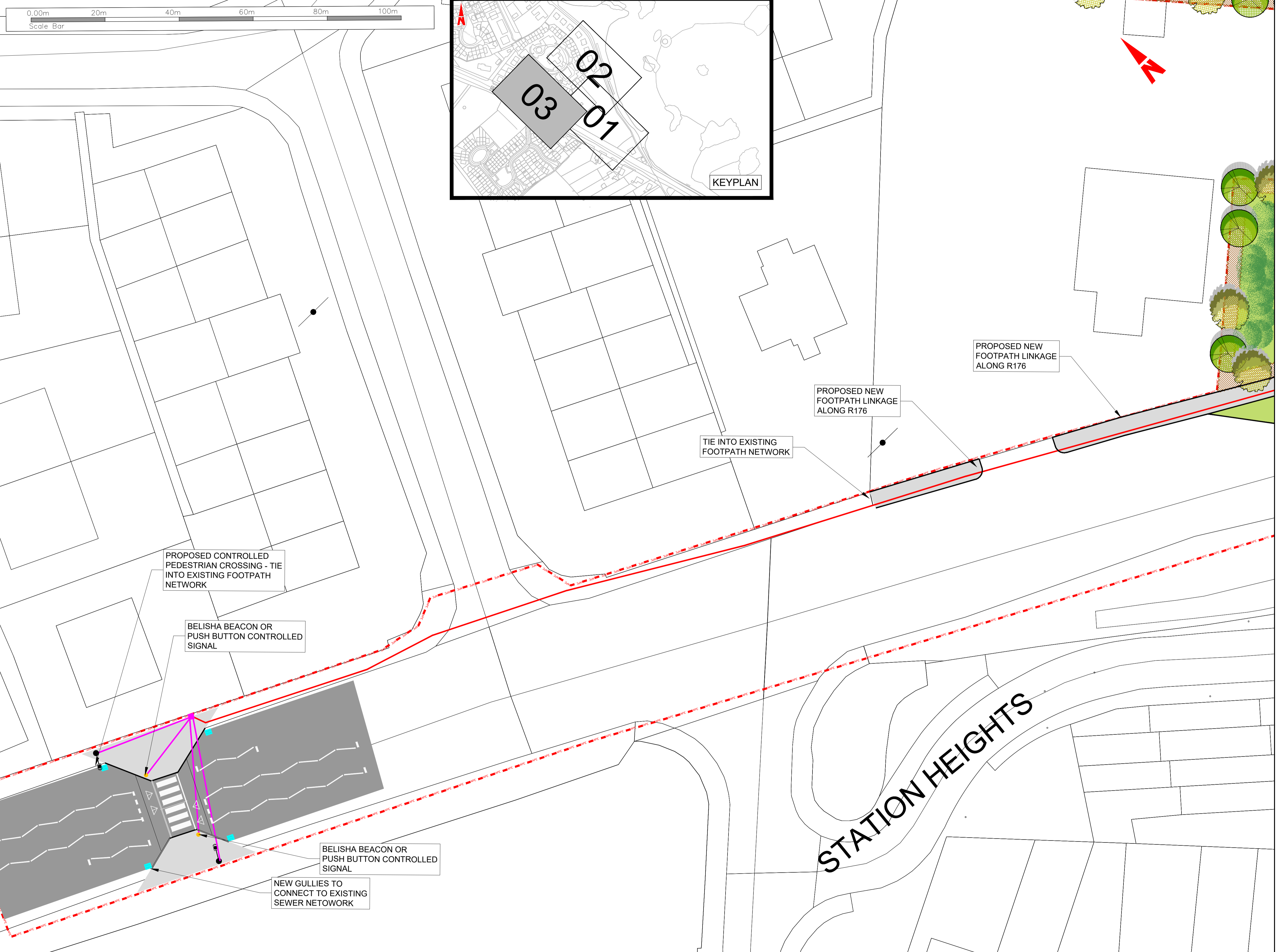
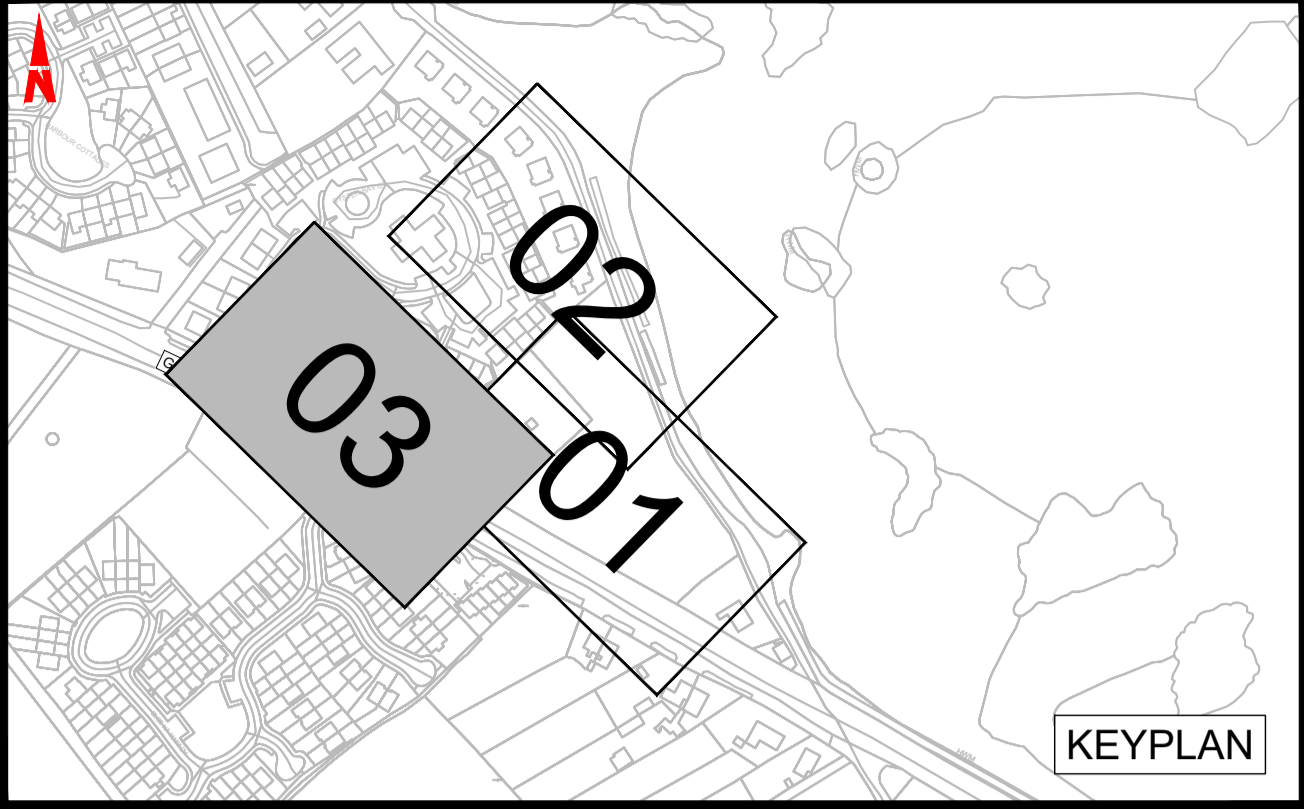

Client

**General Notes**

(i) Hard copies, dwf and pdf will form a controlled issue of the drawing. All other formats (dwg etc.) are deemed to be an uncontrolled issue and any work carried out based on these files is at the recipients own risk. RPS will not accept any responsibility for any errors from the use of these files, either by human error by the recipient, listing of the un-dimensioned measurements, compatibility with the recipients software, and any errors arising when these files are used to aid the recipients drawing production, or setting out on site.

(ii) DO NOT SCALE, use figured dimensions only.

(iii) This drawing is the property of RPS, it is a project confidential classified document. It must not be copied used or its contents divulged without prior written consent. The needs and expectations of client and RPS must be considered when working with this drawing.

(iv) Information including topographical survey, geotechnical investigation and utility detail used in the design have been provided by others.

(v) All Levels refer to Ordnance Survey Datum, Malin Head.

Rev	Date	Drawn	Checked	Amendment / Issue	App
P04	05.04.23	Mk	Dmc	FOR PLANNING	Dmc
P03	16.03.23	Mk	Dmc	FOR PLANNING	Dmc
P02	15.03.23	Mk	Dmc	FOR PLANNING	Dmc
P01	08.03.23	Mk	Dmc	FOR PLANNING	Dmc

Scale	1:200 @ A1 1:400 @ A3	Project	LIVING IN CARLINGFORD VISITING CARLINGFORD RRDF
Created on	NOV. 2022	Title	SOUTHERN CAR PARK AND TENNIS COURTS GENERAL ARRANGEMENT
Sheets	03 of 03	File Identifier	MGT0610-DG0006
Status	S2	Rev	P04

ESB SUBSTATION  
CABINET  
PLAN VIEW  
(DIMENSIONS IN mm)  
(SCALE 1:20)

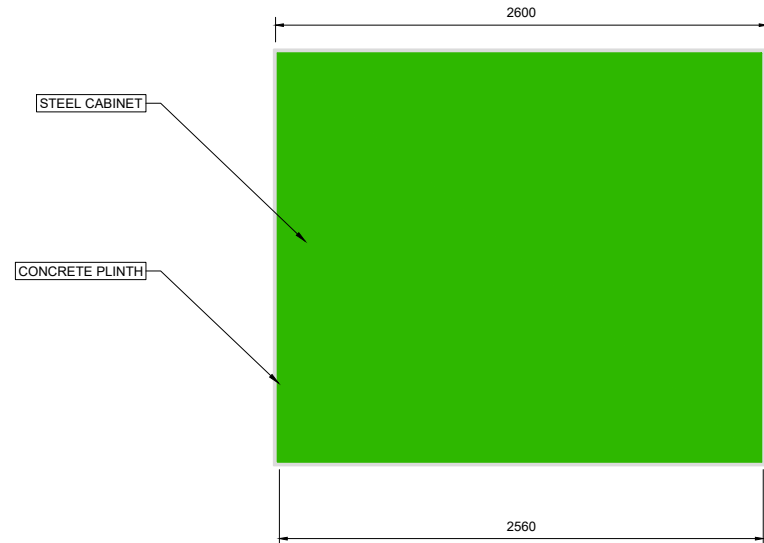

ESB SUBSTATION FRONT VIEW  
(DIMENSIONS IN mm)  
(SCALE 1:20)

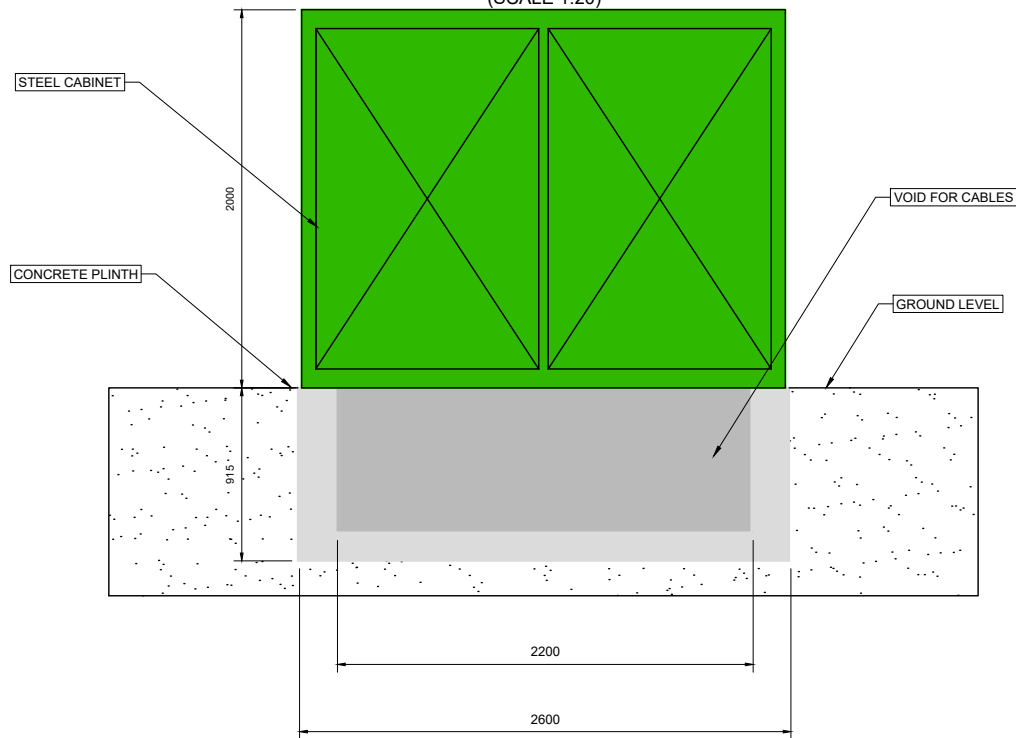

TENNIS COURT TYPICAL  
CONSTRUCTION MAKEUP

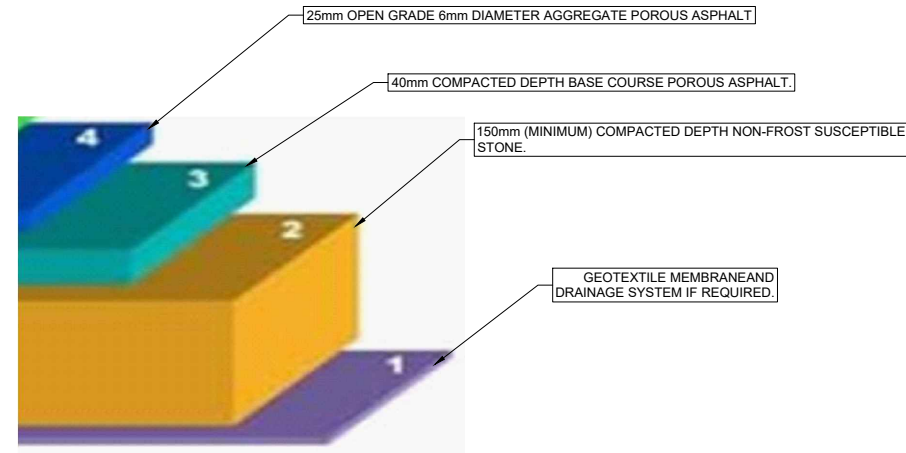

ESB SUBSTATION  
SIDE VIEW  
(DIMENSIONS IN mm)  
(SCALE 1:20)

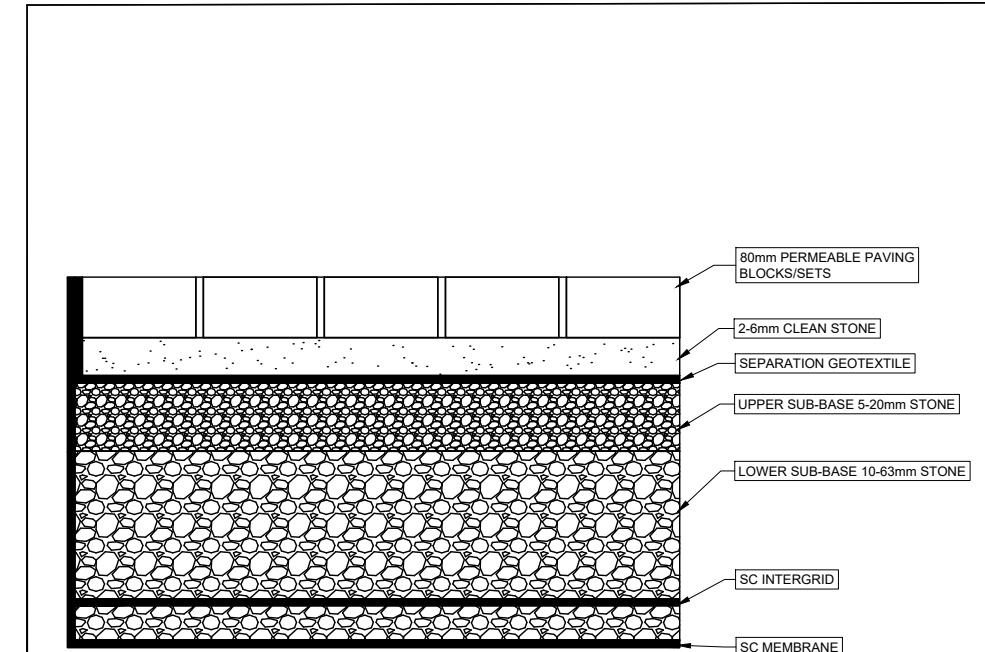
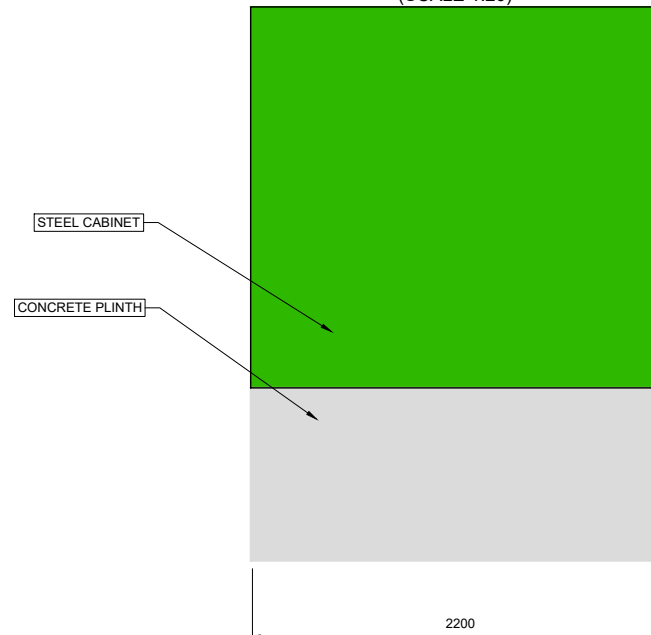

PERMEABLE PAVING DETAIL  
(SCALE 1:5)

Client

An Roinn Forbartha Tuaithe agus Pobail  
Department of Rural and Community Development

Rialtas na hÉireann  
Government of Ireland

Tionscadal Éireann  
Project Ireland 2040

An Ciste um Athghiniúint agus Forbairt Tuaithe  
Rural Regeneration and Development Fund

Comhairle Contae Lú  
Louth County Council

Ar dTothchial Tuaithe  
Our Rural Future

General Notes

(i) Hard copies, dwf and pdf will form a controlled issue of the drawing. All other formats (dwg etc.) are deemed to be an uncontrolled issue and any work carried out based on these files is at the recipients own risk. RPS will not accept any responsibility for any errors from the use of these files, either by human error by the recipient, listing of the un-dimensioned measurements, compatibility with the recipients software, and any errors arising when these files are used to aid the recipients drawing production, or setting out on site.

(ii) DO NOT SCALE, use figured dimensions only.

(iii) This drawing is the property of RPS, it is a project confidential classified document. It must not be copied used or its contents divulged without prior written consent. The needs and expectations of client and RPS must be considered when working with this drawing.

(iv) Information including topographical survey, geotechnical investigation and utility detail used in the design have been provided by others.

(v) All Levels refer to Ordnance Survey Datum, Malin Head.

Rev	Date	Drawn/Checked	Amendment / Issue	App
P04	06.04.23	WJG	FOR PLANNING	DNF
P03	16.03.23	WJG	FOR PLANNING	DNF
P02	15.03.23	WJG	FOR PLANNING	DNF
P01	04.03.22	WJG	FOR PLANNING	DNF

Model File Identifier  
N/A

Scale AS SHOWN @ A1 NTS @ A3	Project LIVING IN CARLINGFORD VISITING CARLINGFORD RRDF
Created on MARCH 2022	Title SOUTHERN CAR PARK AND TENNIS COURTS TYPICAL DETAILS
Sheets 01 of 02	Drawing No. DG0009
File Identifier MGT0528-RPS-00-XX-C-DG0009	Status S2
	Rev P04

T:\MGT0610 - Carlingford RRD\6.0 Drawings\DG\MGT0610-RPS-00-XX-C-DG0009 Southern Car Park and Tennis Court Typical Details.dwg

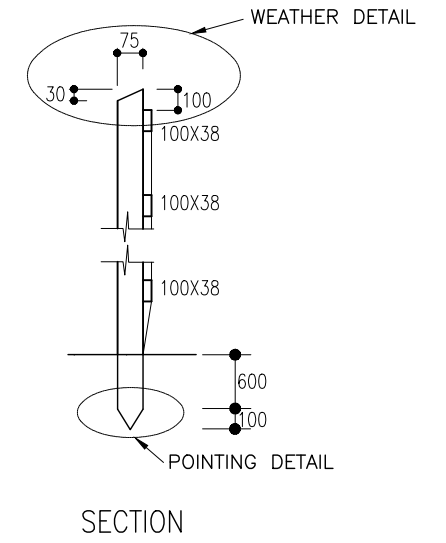
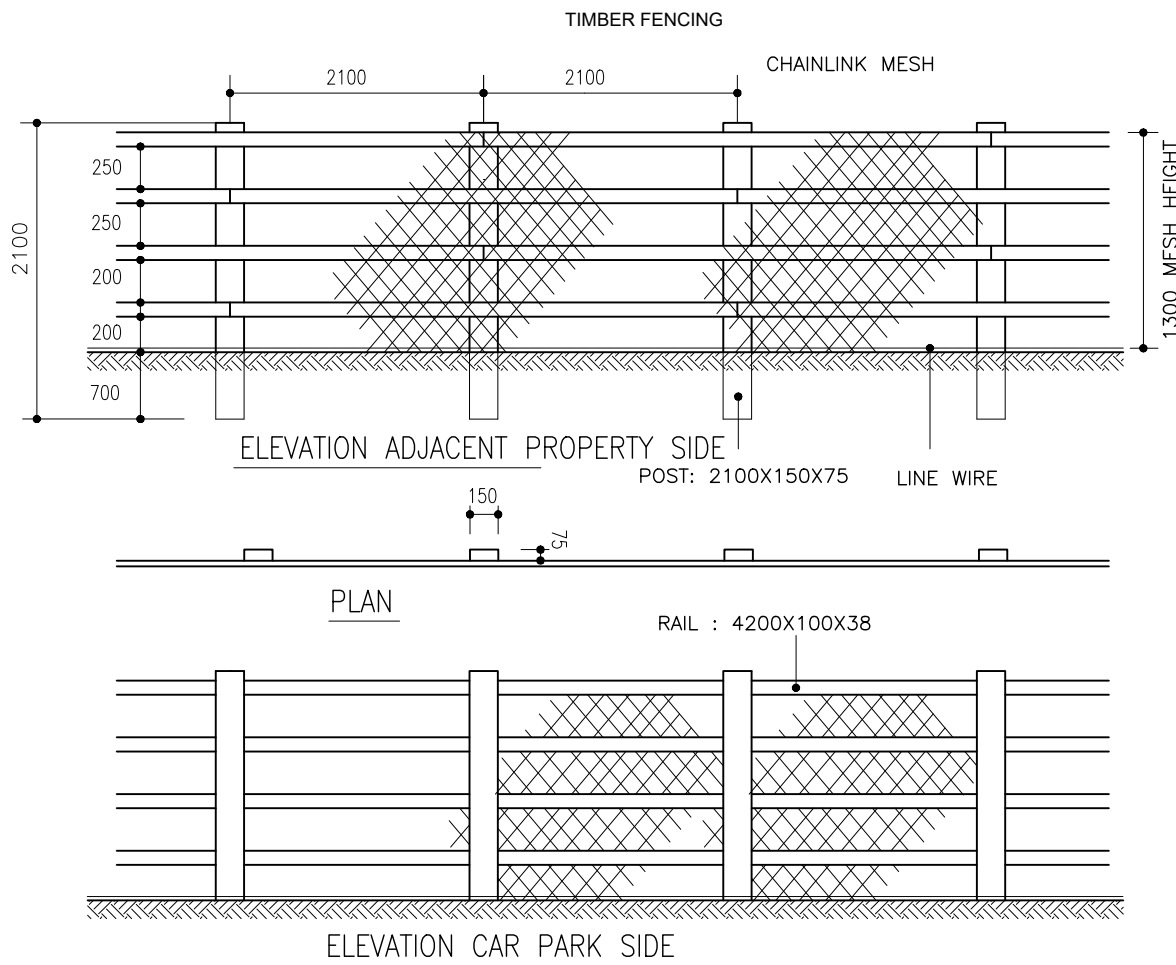
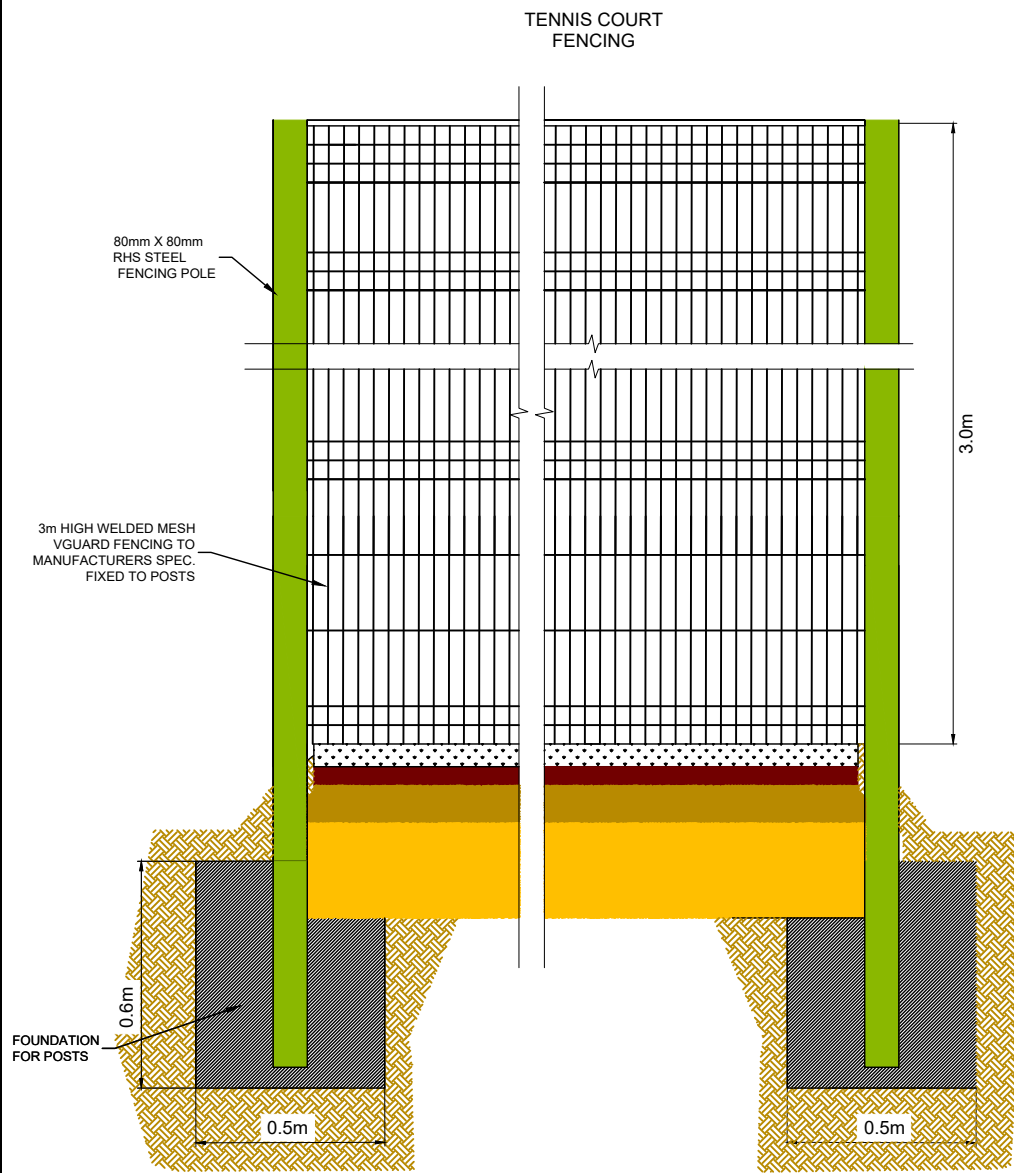

**FIXING**

1. FIX 1 LINE WIRE TO FIELD SIDE OF POSTS AS CLOSE TO GROUND LEVEL AS POSSIBLE.
2. SECURE CHAINLINK MESH TO FIELD SIDE OF RAILS WITH 4 STAPLES PER LIN. METRE ON THE TOP RAIL AND 1 STAPLE PER LIN. METRE ON OTHER RAILS. SECURE TO LINE WIRE WITH 2mm TYING WIRE OR WITH APPROVED GALVANISED HOG-RINGS AT 4 TIES/HOG-RINGS PER METRE. 2mm GALV. M.S. TYING WIRE TO COMPLY WITH BS 1722. WIRE STAPLES SHALL BE GALV. 30mm X 3.75mm ROUND

**NOTES:**

1. FENCES SHALL BE CONSTRUCTED IN ACCORDANCE WITH RC 25 AND ERECTED IN ACCORDANCE WITH CLAUSE 2.5 OF RC 25 EXCEPT WHERE OTHERWISE SHOWN.
2. ANY LENGTH OF FENCING (INCLUDING BRANCHES OR SPURS) SHALL START WITH A POST AND END WITH A POST. AN ADDITIONAL POST SHALL BE PROVIDED AT FENCE JUNCTIONS AND AT FENCE CORNERS.
3. POST HOLES FALLING IN ROCK SHALL BE EXCAVATED TO THE DEPTH SHOWN ON THIS DRAWING OR, WITH THE ENGINEER'S APPROVAL, TO A DEPTH OF 500mm, AND SHALL BE BACKFILLED WITH MIX ST2 CONCRETE. WHERE A REDUCED DEPTH OF HOLE IS ACCEPTED BY THE ENGINEER, THE TOP OF THE POST SHALL BE SUITABLY CUT AND TREATED IN ACCORDANCE WITH THE RELEVANT CCA OR CREOSOTE MANUFACTURER'S RECOMMENDATIONS.
4. FENCE TYPES SHALL BE AS FOLLOWS DEPENDING ON THE REQUIRED PRESERVATION TREATMENT :  
 TYPE A COPPER-CHROME-ARSENIC IN ACCORDANCE WITH RC 25 AND IS/EN 599, PARTS 1 AND 2.  
 TYPE B CREOSOTE IN ACCORDANCE WITH RC 25.

Typical Tree Pit Detail - Intermittent in Hedgerows  
Not to Scale

Planting Generally: Planting shall be carried out during the period from November to March including in suitable open weather. Planting of containerised material may be permitted outside this period with the Engineer's approval. Planting will not be permitted during periods of drought, frost or cold drying winds nor when the ground is waterlogged. All planting operations shall be carried out in accordance with BS 4428 and good horticultural practise. Particular attention must be paid to correct depth of planting ensuring all soil is firmed in around the roots.

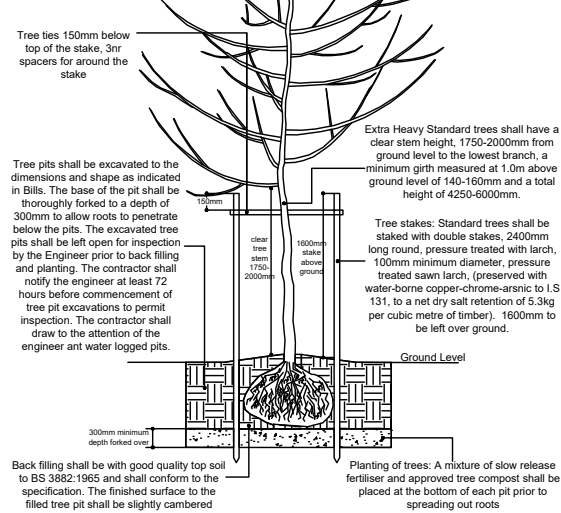

**Staggered Double Hedgerow Planting**

Not to Scale

HEDGES: to BS 3936: Part 1: Excavate a planting trench, to receive the plants at the same depth as in the nursery. Set out plants in a straight, double row staggered as specified, in the hedge trench, evenly spaced at centres indicated on drawings/schedules. Backfill carefully incorporating 100mm deep layer of compost into excavated material, consolidating the soil carefully around the roots, and leaving the plants vertical and in line. Cut back plants before or after planting as scheduled. Hedgerow planting shall be of the minimum size specified in planting details.

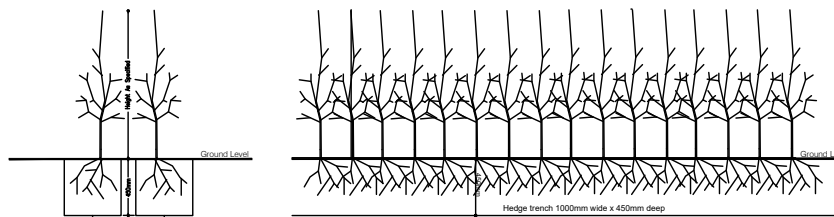

**NOTES**

1. Prior to planting all broken roots must be carefully pruned back and any snags to the crown carefully cut back. Bad bruising or abrasion of their cambium must be treated with 'Tree Three' or equal and approved tree paint. Roots must be kept well moistened before planting in the prepared pit.
2. The hedge planting is to be carried out in excavated free draining trench 1000mm wide x 450mm deep. Mix the excavated material with a slow release fertiliser and the following ameliorants (calculated as applied to the area of the pocket), cultivate and incorporate evenly:  
 Organic manure: 100mm layer over area of pit  
 Fertiliser 0:10:10: 35g  
 Fertiliser I.O.U.: 35g
3. Place plant in pocket at same depth as 'nursery mark', spreading out roots to their natural configuration
4. Partly backfill pocket
5. Backfill the trench to half its depth and firm by treading. Continue planting the trench.
6. Once planted, backfill with the remaining soil and firm as before.
7. All Heights of trees/shrubs given in cm: RB - Rootballed, S - Bare Root, C - Container Grown. All in acc. with the National Plant Specification, as published by the Horticultural Trades Assoc. All workmanship in accordance with BS 4428.

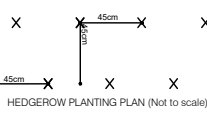

**PLANTING SCHEDULE**

Table 1: Amenity Grass Seeding	Sowing Rate
<b>Grass for open areas</b> (Coburns Irish Premier Heavywear as supplied by Coburns or similar approved)	Sowing rate 35-50g/m2 12.5Kg (20 bags/ha @ 25/gm2)
30% Dwarf Perennial Ryegrass	
20% Dwarf Perennial Ryegrass 50% Strong Creeping Red Fescue	

**Table 2: Proposed Trees**

Common Name	Botanical Name	Transplanted/ Pot Size	Spacing
Norway Maple	<i>Acer platanoides</i>	Standard (Semi-mature), 4x transplanted, 30-35cm girth, min 450cm height, min 200cm clear stem height, RB	Planting as shown
Lime	<i>Tilia cordata 'Green Spire'</i>	Standard (Semi-mature), 4x transplanted, 25-30cm girth, min 450cm height, min 200cm clear stem height, RB	Planting as shown
Scots Pine	<i>Pinus sylvestris</i>	Standard (Semi-mature), 4x transplanted, 25-30cm girth, min 450cm height, min 200cm clear stem height, RB	Planting as shown

**Table 5: Woodland Planting**

Plant Species	Root Condition	Height (cm)	Form/Habit	Age	Nr. Times transplanted	Spacing	Mix (%)
<i>Crataegus monogyna</i>	Bare root	80 - 100	Transplant, Seed raised	1 + 1		1.5m	15
<i>Ilex aquifolium</i>	Root balled	125 - 150	Leader, laterals, furnished to base		3x transplanted	1.5m	15
<i>Ligustrum vulgare</i>	Bare root	125 - 150	Leader, laterals, furnished to base		3x transplanted	1.5m	10
<i>Prunus spinosa</i>	Bare root	80 - 100	Transplant, Seed raised	1 + 2		1.5m	10
<i>Alnus glutinosa</i> (Alder)	Bare root	min 350 - 425	Heavy Standard		2x transplanted	2.0m	25
<i>Betula pendula</i> (Birch)	Bare root	min 175 - 200	Feathered		2x transplanted	2.0m	25

**Table 6: Species Rich Native Hedgerow Planting - Hedgerow**

Plant Species	Form	Age/Cond.	Overall Height	Root Condition	Size of Container	Planting	% Mix
<i>Acacia constricta</i> (Whitethorn)	Transplant	1+1	60-90cm	B		45cm	10%
<i>Alnus glutinosa</i> (Common Alder)	Transplant	1+1	60-90cm	B		45cm	5%
<i>Betula pubescens</i> (Birch)	Transplant	1+1	60-90cm	B		45cm	5%
<i>Crataegus monogyna</i> (Hawthorn)	Transplant	1+1	60-90cm	B		45cm	20%
<i>Corylus avellana</i> (Hazel)	Transplant	1+2	60-90cm	B		45cm	10%
<i>Euonymus europaeus</i> (Spindle)	Transplant	1+2	60-90cm	B		45cm	5%
<i>Ilex aquifolium</i> (Holly)	Transplant	1+1	40-50cm	C or RB	2L	45cm	10%
<i>Prunus spinosa</i> (Blackthorn)	Transplant	1+1	60-90cm	B		45cm	10%
<i>Rosa canina</i> (Dog Rose)	Transplant	1+1	60-90cm	B		45cm	5%
<i>Salix</i> spp. (Willow)	Transplant	1+1	60-90cm	B		45cm	5%
<i>Sambucus nigra</i> (Common Elder)	Transplant	1+1	60-90cm	B		45cm	5%
<i>Sorbus aucuparia</i> (Rowan)	Transplant	1+1	60-90cm	B		45cm	5%
<i>Viburnum opulus</i> (Guelder Rose)	Transplant	1+1	60-90cm	B		45cm	5%

Client

An Roinn Forbartha Tuaithe agus Pobail  
Department of Rural and Community Development

Rialtas na hÉireann  
Government of Ireland

Tionscadal Éireann  
Project Ireland  
2040

An Ciste um Athnóinúit agus Forbairt Tuaithe  
Rural Regeneration and Development Fund

Comhairle Contae Lú  
Louth County Council

Ar dTochtáil Tuaithe  
Our Rural Future

**General Notes**

(i) Hard copies, dwf and pdf will form a controlled issue of the drawing. All other formats (dwg etc.) are deemed to be an uncontrolled issue and any work carried out based on these files is at the recipients own risk. RPS will not accept any responsibility for any errors from the use of these files, either by human error by the recipient, listing of the un-dimensioned measurements, compatibility with the recipients software, and any errors arising when these files are used to aid the recipients drawing production, or setting out on site.

(ii) DO NOT SCALE, use figured dimensions only.

(iii) This drawing is the property of RPS, it is a project confidential classified document. It must not be copied or its contents divulged without prior written consent. The needs and expectations of client and RPS must be considered when working with this drawing.

(iv) Information including topographical survey, geotechnical investigation and utility detail used in the design have been provided by others.

(v) All Levels refer to Ordnance Survey Datum, Malin Head.

Rev	Date	Drawn/Checked	Amendment / Issue	App	Model File Identifier
P04	06.04.23	M/D	FOR PLANNING	D/M	N/A
P03	16.03.23	M/D	FOR PLANNING	D/M	
P02	15.03.23	M/D	FOR PLANNING	D/M	
P01	04.03.22	M/D	FOR PLANNING	D/M	

Scale: NTS @ A1, NTS @ A3

Created on: MARCH 2022

Sheets: 02 of 02

Project: LIVING IN CARLINGFORD VISITING CARLINGFORD RRDF

Title: SOUTHERN CAR PARK AND TENNIS COURTS TYPICAL DETAILS

File Identifier: MGT0528-RPS-00-XX-C-DG0009

Drawing No: DG0009

Status: S2

Rev: P04

T:\MGT0528-RPS-00-XX-C-DG0009 Southern Car Park and Tennis Court Typical Details.dwg



Site layout plan | 1:1000

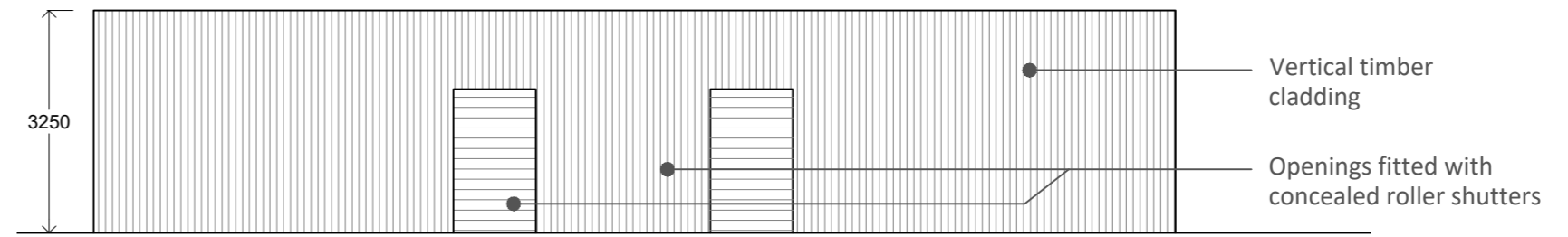

North elevation | 1:100

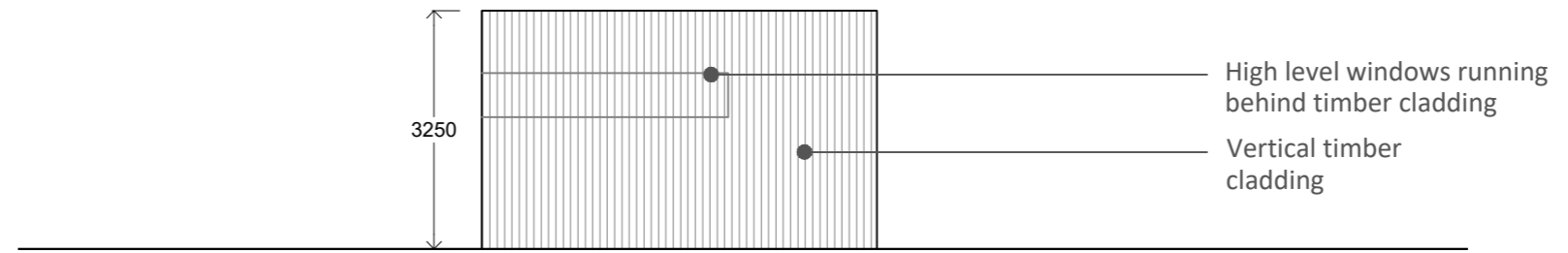

East elevation | 1:100

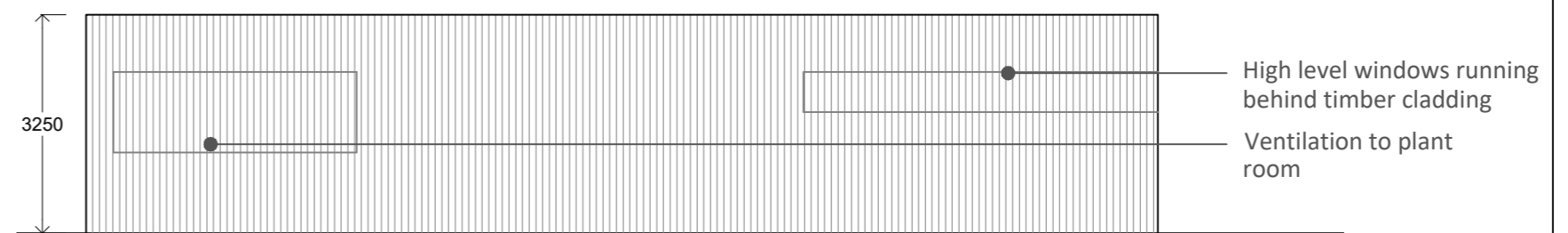

South elevation | 1:100

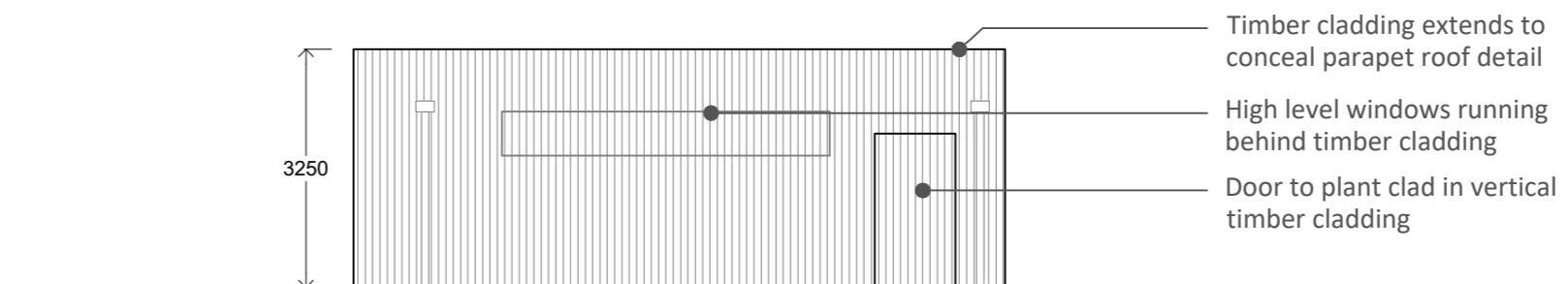

West elevation | 1:100

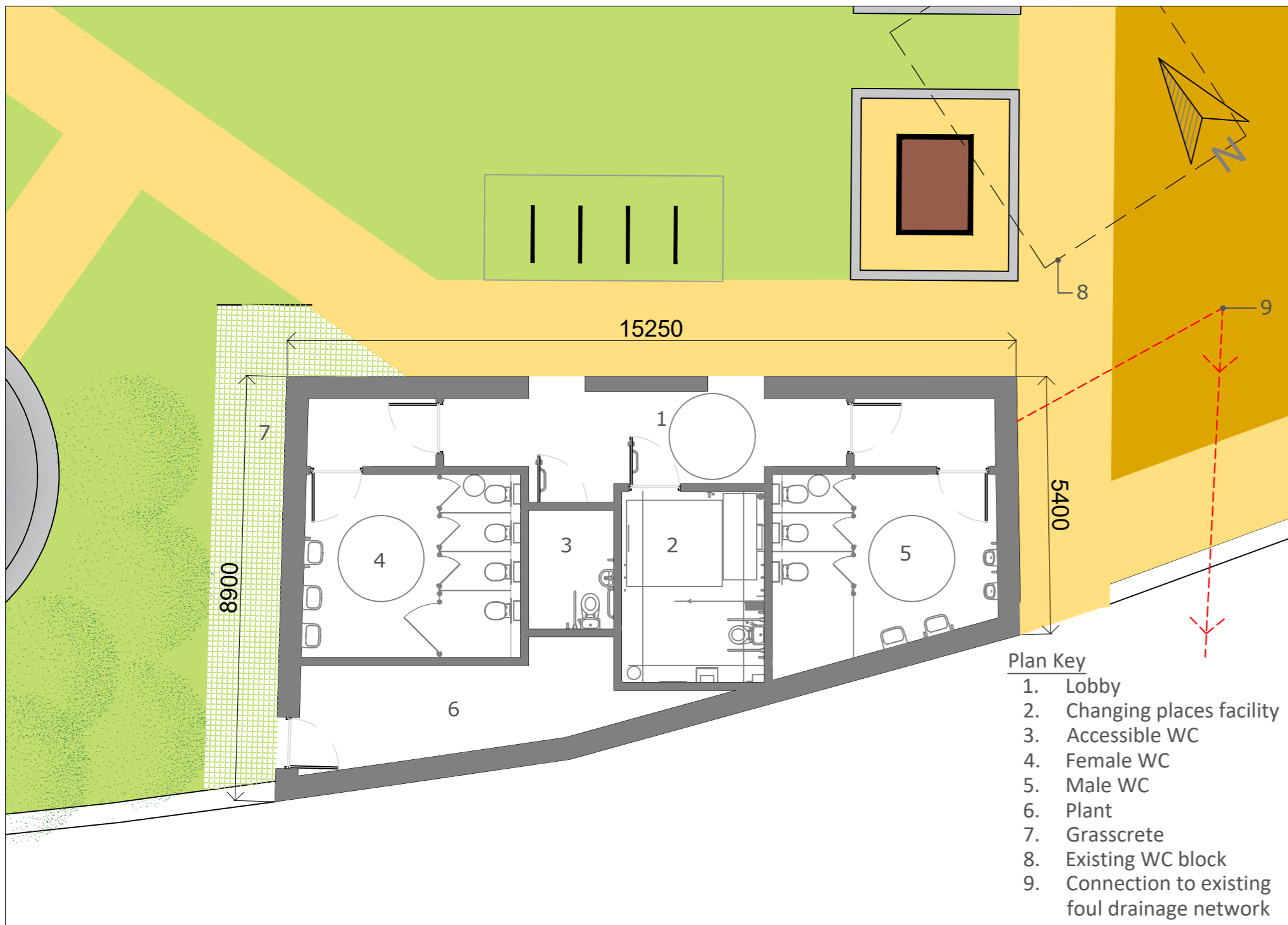

Ground floor plan | 1:100

- Plan Key**
1. Lobby
  2. Changing places facility
  3. Accessible WC
  4. Female WC
  5. Male WC
  6. Plant
  7. Grasscrete
  8. Existing WC block
  9. Connection to existing foul drainage network



Image A



Image B



Image C



Image D

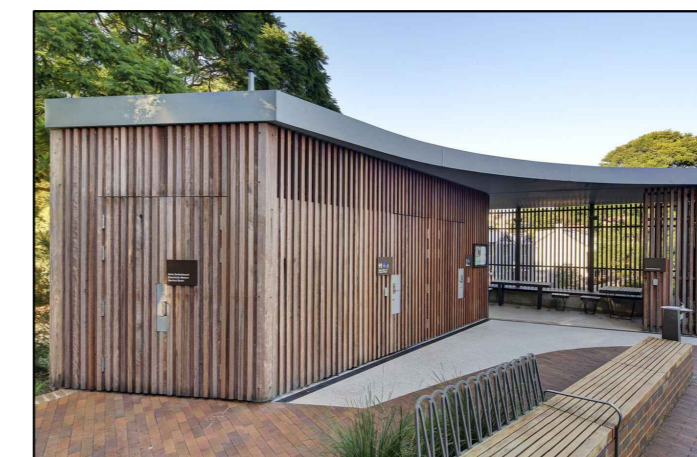

Image E

NOTES:

- Image key**
- A. Vertical timber cladding
  - B. Timber cladding detail
  - C. Example of windows behind timber cladding
  - D. Timber clad building in public space setting
  - E. Timber clad concealed door



part 8 planning

NOTE:  
POSITIONS OF STREET LIGHTING COLUMNS AND STREET FURNITURE ARE INDICATIVE AND SUBJECT TO FURTHER DESIGN DEVELOPMENT

COMHAIRLE CONTAE LÚ  
LOUTH COUNTY COUNCIL

Council Offices,  
COUNTY HALL  
DUNDALK  
Co.Louth

P: +353 429335457  
E: info@louthcoco.ie  
eolas@contaelu.ie

PROJECT TITLE:  
**Living in Carlingford  
Visiting Carlingford RRDF**

DRAWING TITLE:  
**Toilet block - General  
arrangement drawings**

Scale: Varies | Sheet size: A2

Drawn by: TH

Date: April 2023

Issued for: Part 8 planning

Revision: -

Drawing no: WC-001